



Quick Reference Guide Power Double Lock (PDL) Connectors

The power double lock connectors are available in wire-to-wire, free-hanging, panel mount and wire-to-board configurations. This connector system consists of plug and cap housings for wire termination, optional double lock plates, crimp contacts and PC board pin headers, and is available in four contact centerline spacings: 3.96 mm, 6.5 mm, 7.92 mm and 13.00 mm. The power double lock connector system accepts 26-16 AWG wire with insulation diameters up to 3.1 mm and is rated up to 14 Amps per line.

Features & Benefits

- Discrete wire interconnect available in 1-12 position wire-to-board and wire-to-wire
- Audible click when contact is fully inserted into the housing
- Polarizing ribs on plug housing allows for proper mating
- Solder tail kink along with the polarization peg (boss) feature, secures the header on the board during the solder process
- Board-mounted headers are compatible with resin or conformal coatings — No drain holes
- Multiple colors available for ease of connector identification during assembly and maintenance
- UL, CSA and VDE approved

Product Applications

- Household appliances
- Gaming
- Vending
- Garage door openers
- Security systems
- Industrial controls
- HVAC system controls
- Fan modules
- Business equipment

CONTACTS												
Wire Range		Wire Insulation Dia. mm ²	Tab		Receptacle		Applicator Part Number					
AWG	mm ²		Strip Form	Loose Piece	Strip Form	Loose Piece	Automatic	Semiautomatic		Hand Tool	Extraction Tool	
						K press		G press	Tab		Receptacle	
26-22	0.14-0.34	1.30-2.00	177916-1	179594-1	177914-1	179592-1	680283-1	680283-2	680283-3	91567-1	234914-1	234912-1
					177914-2*	179592-2*						
20-16	0.51-1.38	2.00-3.10	177917-1	179595-1	177915-1	179593-1	680286-1	680286-2	680286-3	91569-1	234914-1	234912-1
					177915-2*	179593-2*						

See Application Specification 114-5175 & Instruction Sheet 411-5638

* Part Number suffix -2 represents high contact pressure type

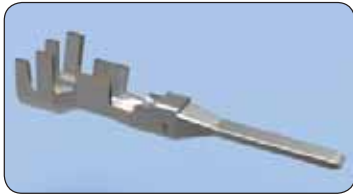

Tab

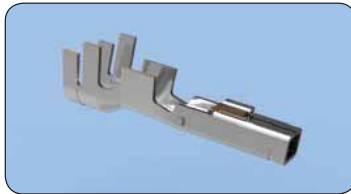

Receptacle

The PDL contacts are phosphor bronze with pre-tin plating and designed without lances to prevent entanglement of contacts with one another. The receptacle contact gets loaded into the plug housings and the tab contact gets loaded into cap housings.



The semi-inner locking system of the PDL design helps eliminate unmating by external force and the audible click helps indicate the connector system is fully latched. The smooth compact design prevents snagging when mated.

PLUG HOUSINGS

3.96 mm Centerline Spacing

No. of Pos.	No. of Rows	Base Part No.	Available Color Options (Part No. Suffix) ⁴					Double Lock Plate Part No. ¹
			-1	-2	-4	-6	-9	
1	1	316768	-1	-2	-4	-6	-9	316770-1
2	1	177898 ²	-1	-2	-4	-6	-9	177918-1
3	1	177899 ²	-1	-2	-4	-6	-9	177919-1
4	1	316501 ²	-1		-4	-6		177920-1
4	2	177900 ²	-1		-4	-6		177918-1
6	2	177901 ²	-1		-4	-6		177919-1
8	2	177902 ²	-1		-4	-6		177920-1
9	3	177903 ²	-1		-4	-6		177919-1
10	2	177904	-1		-4	-6		177921-1
12	3	177905	-1		-4	-6		177920-1

6.5 mm Centerline Spacing

2	1	1939344	-1					316061-1
3	1	179938	-1	-2	-4	-6	-9	316062-1
4	1	179939	-1		-4	-6	-9	316063-1
4	2	179861 ³	-1		-4	-6		316061-1
6	2	179862 ³	-1		-4	-6		316062-1
12	2	917354 ³	-1					353891-1

7.92 mm Centerline Spacing

2	1	177899 ²	-1	-2	-4	-6	-9	177919-1
---	---	---------------------	----	----	----	----	----	----------

13.0 mm Centerline Spacing

2	1	179938	-1	-2	-4	-6	-9	316062-1
---	---	--------	----	----	----	----	----	----------

Notes:

1. Refer to No. of Rows to specify the number of double lock plates required.
2. Available in Type II lock, see catalog 82181 for details.
3. Available in Type B, see catalog 82181 for details.
4. Color Key Code: -1 Natural, -2 Red, -4 Yellow, -6 Blue, -9 Black

CAP HOUSINGS

3.96 mm Centerline Spacing

No. of Pos.	No. of Rows	Free-Hanging	Panel Mount	Available Color Options (Part No. Suffix) ⁴					Double Lock Plate Part No ¹
1	1	316769	—	-1	-2	-4	-6	-9	316770-1
2	1	179463	177906	-1	-2	-4	-6	-9	177918-1
3	1	179464	177907	-1	-2	-4	-6	-9	177919-1
4	1	—	316502	-1		-4	-6		177920-1
4	2	179465	177908	-1		-4	-6		177918-1
6	2	179466	177909	-1		-4	-6		177919-1
8	2	179467	—	-1		-4	-6		177920-1
9	3	—	177911	-1		-4	-6		177919-1
10	2	—	177912	-1		-4	-6		177921-1
12	3	1903720	177913	-1		-4	-6		177920-1



A double lock plate is available for both plug and cap housings to ensure positive loading and to help prevent contact back-out.

HEADERS

No. of Pos.	Rows	Base Part No.	Available Color Options (Part No. Suffix) ⁴				
3.96 mm Centerline							
2	1	179838	-1	-2	-4	-6	-9
3	1	179839	-1	-2	-4	-6	-9
4	2	179840	-1		-4	-6	
6	2	179841	-1		-4	-6	
8	2	917845	-1		-4	-6	
12	3	179843	-1		-4	-6	
6.5 mm Centerline Spacing							
3	1	179846	-1		-4	-6	
4	2	179848	-1		-4	-6	
6	2	179849	-1		-4	-6	
12	2	917353*	-1				
13 mm Centerline Spacing							
2	1	917745	-1		-4	-6	

*Available without kink, see catalog # 82181 for details.



The PDL headers offer a kink in the solder tail along with the kink in the mounting boss which secures the header on the board firmly while soldering. Board-mounted headers are compatible with resin or conformal coatings (no drain holes).

Positive mounting achieved with Double Lock mechanism.



1) Contact is partially-mounted.

2) Double Lock Plate is set.

3) Contact is fully pushed in as Double Lock Plate is pressed.

CONNECTOR KITS PROVIDED BY WALDOM ELECTRONICS

Kit Part Number	Description
2110837-1	Power Double Lock Panel Mount Plug, Receptacle and Double Lock Plate Connector Kit
2110837-2	Power Double Lock Vertical Header Wire-to-Board Connector Kit
2110837-3	Power Double Lock Free-Hanging Wire-to-Wire Connector Kit
2110837-4	Power Double Lock Wire-to-Wire and Wire-to-Board Connector Kit
2110837-5	6.5 mm Power Double Lock Wire-to-Wire and Wire-to-Board Connector Kit

Note: Design kits are designed and assembled by Waldom Electronics and are available for purchase through your local distributor.

Questions that will help you better select the product that you need:

What are the current and voltage requirements for your application?

The power double lock connector system has a maximum current rating of 14 Amps per line and is rated for 300 Volts AC/DC wire-to-wire and 50 Volts AC/DC wire-to-board.

What are the wire type and size requirements?

The power double lock connector system is approved for use with 26-16 AWG wire with an insulation range between 1.3 mm and 3.1 mm.

What are the number of positions and available space?

The power double lock connector system is available in select positions (1-12) on four contact centerline spacings; 3.9 mm, 6.5 mm, 7.92 mm and 13.0 mm. The overall mated length of the free-hanging system is 38.7 mm and the maximum height of the wire-to-board system is 25.5 mm.

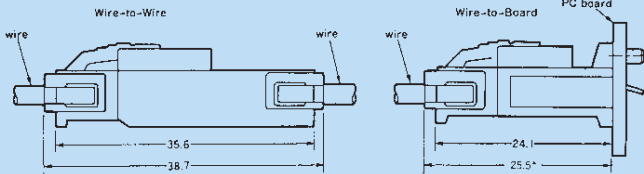

What are the operating temperature requirements?

The power double lock connector system has a maximum operating temperature of 105°C. For more information regarding operating temperatures refer to Product Specification 108-5410.

Is contact back-out a concern? Do you need confirmation that the contacts are seated?

The power double lock connector system offers an optional double lock

plate. The purpose of the double lock plate is two-fold: 1) allows contacts to be fully seated in the housing and 2) it helps prevent the possibility of contact disengagement when wires are exposed to external pressure.

Do you need to differentiate this connector from other connectors in the application?

The power double lock connector system offers multiple options of colored housings for ease of connector identification during manufacturing and assembly.

What is the benefit of choosing a header with a polarization peg (boss)?

The power double lock connector system offers headers with or without polarization pegs. The purpose of this feature is to polarize the headers to the PCB so the header can not be placed on the PCB in the wrong orientation. For more information regarding PCB layout please refer to the header product drawing.

What is the benefit of choosing a high force contact?

The power double lock connector system offers high force contacts for use in applications where vibration is prominent. It is important to note that the high force contacts increase the amount of mating force. Refer to Product Specification 108-5410 for more information.

What is the benefit of choosing Lock Type II or Lock Type B (non-standard) latch?

- Lock Type II is offered on the 3.96 mm plugs allowing for easier unmating (more finger room to depress the latch).
- Lock Type B is offered on the 6.5 mm plugs providing a slightly lower profile and can be used when the application will not have to be unmated often.

FOR MORE INFORMATION

TE Technical Support Center

USA:	+1 (800) 522-6752
Canada:	+1 (905) 475-6222
Mexico:	+52 (0) 55-1106-0800
Latin/S. America:	+54 (0) 11-4733-2200
Germany:	+49 (0) 6251-133-1999
UK:	+44 (0) 800-267666
France:	+33 (0) 1-3420-8686
Netherlands:	+31 (0) 73-6246-999
China:	+86 (0) 400-820-6015

Part numbers in this brochure are RoHS Compliant*, unless marked otherwise.

*as defined www.te.com/leadfree

te.com

© 2011 Tyco Electronics Corporation, a TE Connectivity Ltd. Company. All Rights Reserved.

1773458-5 CIS LUG FP 1M 03/2011

TE Connectivity, TE connectivity (logo) and TE (logo) are trademarks. Other logos, product and/or company names might be trademarks of their respective owners.

While TE has made every reasonable effort to ensure the accuracy of the information in this brochure, TE does not guarantee that it is error-free, nor does TE make any other representation, warranty or guarantee that the information is accurate, correct, reliable or current. TE reserves the right to make any adjustments to the information contained herein at any time without notice. TE expressly disclaims all implied warranties regarding the information contained herein, including, but not limited to, any implied warranties of merchantability or fitness for a particular purpose. The dimensions in this catalog are for reference purposes only and are subject to change without notice. Specifications are subject to change without notice. Consult TE for the latest dimensions and design specifications.

