

5088450-9 Product Details

[Share](#) [Print](#) [Email](#)

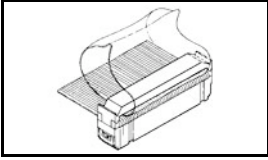

5088450-9

TE Internal Number: 5088450-9

 Active

[View 3D PDF](#)

AMP-LATCH Ribbon Cable Connectors

 Always EU RoHS/ELV Compliant
(Statement of Compliance)

Product Highlights:

- AMP-LATCH Product Line
- Accessory Type = Pull Loop
- Accessory Color = Natural
- Phosphor Bronze Contact Base Material
- Gold or Palladium Nickel or Performance Based Contact Plating, Mating Area, Material

[View all Features](#)

Quick Links

- ▶ [Pricing & Availability](#)
- ▶ [Search for Tooling](#)
- ▶ [Product Feature Selector](#)
- ▶ [Contact Us About This Product](#)

[Add to My Part List](#)

[Request Sample](#)

[Find Similar Products](#)

[Buy Product](#)

Documentation & Additional Information

Product Drawings:

- [PULL LOOP, AMP-LATCH](#) (PDF, English)

Catalog Pages/Data Sheets:

- [Ribbon Cable Interconnect Solutions](#) (PDF, English)

Product Specifications:

- None Available

Application Specifications:

- [AMP-LATCH 2 mm Receptacle Connectors](#) (PDF, English)

Instruction Sheets:

- None Available

CAD Files: (CAD Format & Compression Information)

- [2D Drawing](#) (DXF, Version 0)
- [3D Model](#) (IGES, Version 0)
- [3D Model](#) (STEP, Version 0)

[List all Documents](#)

Additional Information:

- [Product Line Information](#)

Related Products:

- [Tooling](#)

Product Features (Please use the Product Drawing for all design activity)

Product Type Features:

- Product Line = AMP-LATCH
- Accessory Type = Pull Loop
- Accessory Color = Natural
- CSA File Number = LR 7189

Contact Features:

- Contact Base Material = Phosphor Bronze
- [Contact Plating, Mating Area, Material](#) = Gold or Palladium Nickel or Performance Based

Industry Standards:

- [RoHS/ELV Compliance](#) = RoHS compliant, ELV compliant
- [Lead Free Solder Processes](#) = Not relevant for lead free process
- RoHS/ELV Compliance History = Always was RoHS

Operation/Application:

- Contact Transmits (Typical Application) = Signal (Data)

Packaging Features:

- Packaging Method = Box/Carton

Other:

- Series = 2.0 [.079] AMP-LATCH, NOVO
- Brand = AMP

compliant

- Agency/Standard = CSA, UL
- UL Rating = Recognized
- UL File Number = E28476

Corporate Information

[About TE](#)
[Investors](#)
[News Room](#)
[Supplier Portal](#)
[Careers](#)
[Terms & Conditions](#)
[Privacy Policy](#)
[AODA Accessibility Policy](#)
[AODA Multi-Year Accessibility Plan](#)

Quick Links

[Distributor Inventory](#)
[Product Cross Reference](#)
[Documents & Drawings](#)
[Product Compliance Support Center](#)
[Site Map](#)

Customer Support

[Email or Chat With Us](#)
[Find a Phone Number](#)
[Knowledge Base](#)
[Manage Your Account](#)

Keep Me Informed



4

3

2

1

THIS DRAWING IS UNPUBLISHED. RELEASED FOR PUBLICATION
 © COPYRIGHT - By - ALL RIGHTS RESERVED.

LOC	DIST	REVISIONS			
P	LTR	DESCRIPTION	DATE	DWN	APVD
GP	00	P			
		P	REVISED PER ECO-11-004835	11MAR11	RK HMR

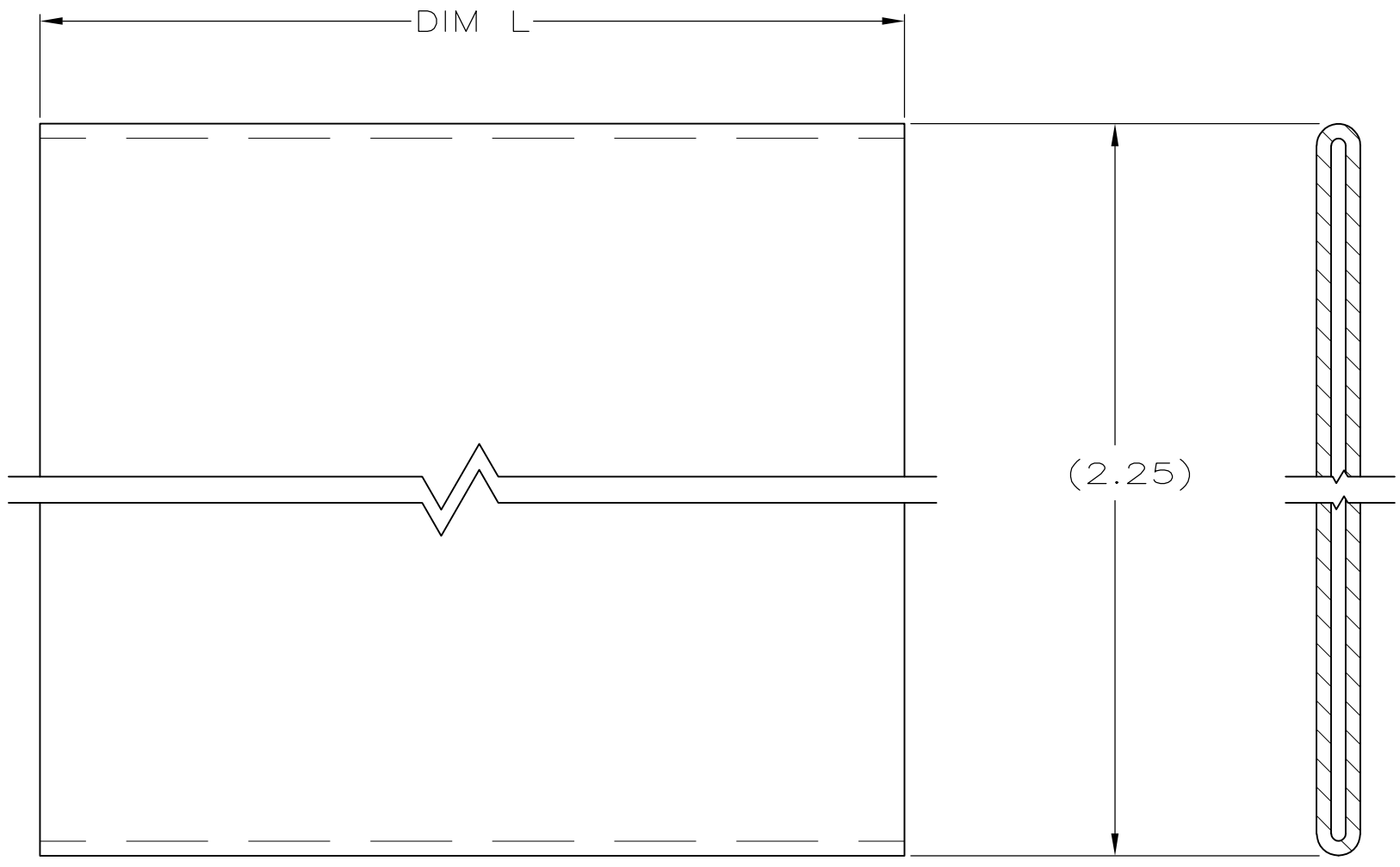

2.80±.20	60 POSN CONN	1-5088450-1
2.32±.18	50 POSN CONN	1-5088450-0
1.82±.18	40 POSN CONN	5088450-9
1.58±.12	34 POSN CONN	5088450-8
1.18±.12	26 POSN CONN	5088450-7
.88±.12	20 POSN CONN	5088450-5
.74±.06	16 POSN CONN	5088450-4
.64±.06	14 POSN CONN	5088450-3
.44±.06	10 POSN CONN	5088450-2
120.00±2.00	-	5088450-1

L	USED WITH	PART NUMBER
---	-----------	-------------

1 PVC LAY FLAT TUBING 94V-1 RATED, COLOR NATURAL.

THIS DRAWING IS A CONTROLLED DOCUMENT.		DWN R.RICHARDSON 1JUNE05	TE Connectivity			
DIMENSIONS: INCHES		CHK C.ROHDE 1JUNE05				
TOLERANCES UNLESS OTHERWISE SPECIFIED:		APVD M.WALMSLEY 1JUNE05	NAME PULL LOOP, AMP-LATCH			
0 PLC ± - 1 PLC ± - 2 PLC ± - 3 PLC ± - 4 PLC ± - ANGLES ± -		PRODUCT SPEC -	APPLICATION SPEC -			
MATERIAL 1	FINISH -	WEIGHT -	SIZE A3	CAGE CODE 00779	DRAWING NO C-5088450	RESTRICTED TO -
CUSTOMER DRAWING			SCALE 10:1	SHEET 1 OF 1	REV P	