

tyco

Electronics

Introducing...

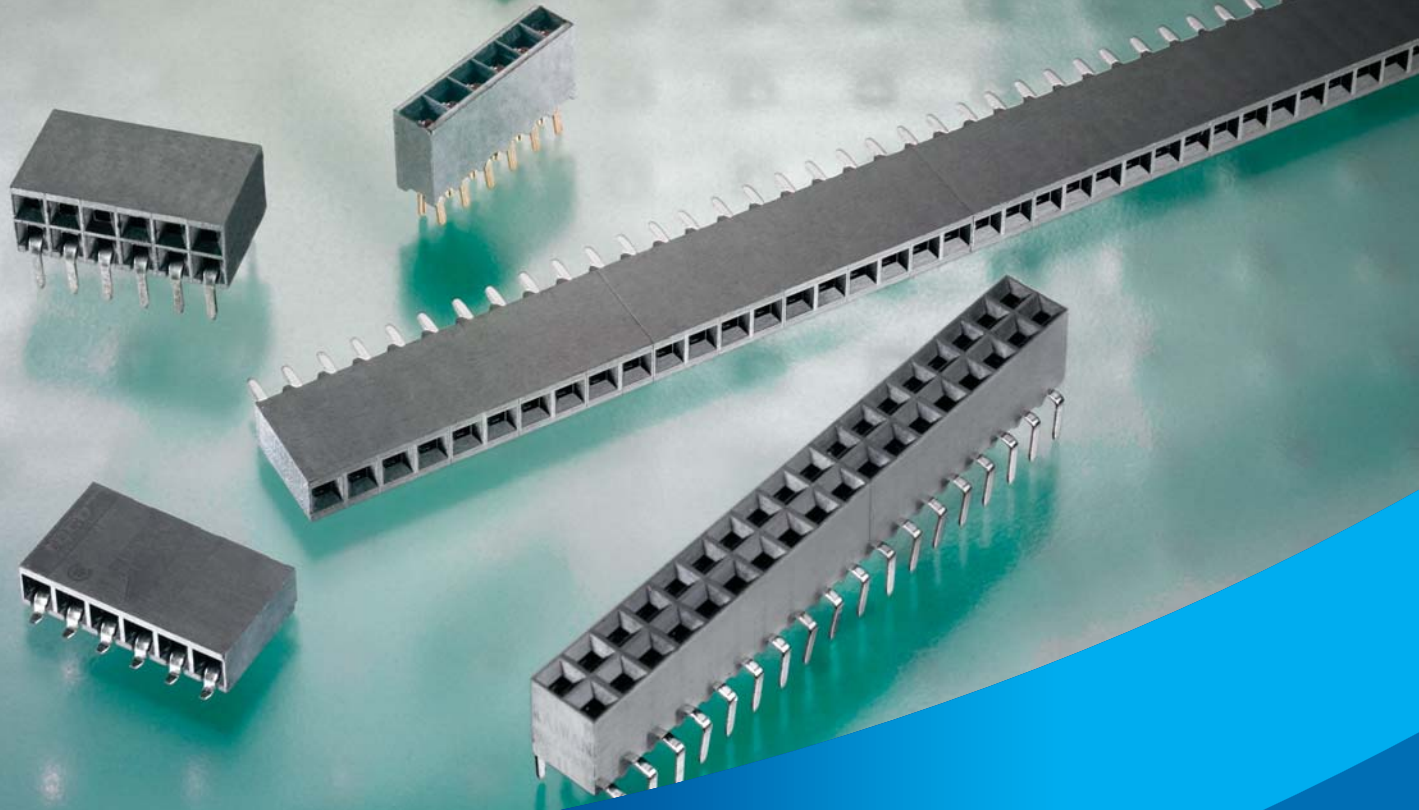

AMPMODU Horizontal and Vertical Receptacles

DESCRIPTION

- New - Horizontal Receptacles are now available in surface mount.
- New – Dual entry Vertical Receptacles that includes single row outrigger and single row surface mount styles.
- Horizontal and Vertical Receptacles are designed to reliably and economically meet the packaging and interconnect requirements of today's electronics industry.
- Available in both single and double row configurations on 0.100 [2.54] x 0.100 [2.54] centerline.
- Thru-hole and surface mount styles compliment the offering to meet all application needs.
- Generally used for applications using the motherboard/daughter board arrangement and mated with unshrouded and Breakaway style headers

APPLICATIONS

- Economical solution to connect two or more printed circuit boards (i.e motherboard/daughter card and parallel)
- Aerospace & Defense
- Rail & Mass Transportation
- Commercial & Building Equipment
- Household Appliances
- Electrical & Electronic Components
- Industrial Machinery & Equipment
- Instrument & Measuring Equipment
- Computers & Peripheral Equipment
- Business & Retail Equipment
- Home Entertainment & Consumer Electronics
- Motor Vehicles
- Commercial & Building Equipment
- Communications Equipment Manufacturers
- Communication Service Providers, Power, and Networking/Cabling

AMPMODU Horizontal and Vertical Receptacles

KEY FEATURES

Horizontal

- **Mod II – Thru-Hole**

- Closed entry housings help prevent post stubbing
- End stackable on both SR and DR to achieve higher position sizes
- Dual cantilever beam contact
- Housings feature PC board stand-offs

- **Mod II – Surface Mount**

- Closed entry housings help prevent post stubbing
- End stackable on both SR and DR to achieve higher positions sizes
- Dual cantilever beam contact
- Housings feature PC board stand-offs

Vertical

- **Mod II – Thru-Hole**

- Top entry only
- End stackable on both SR and DR to achieve higher position sizes
- Side stackable on DR only to achieve higher row count
- Dual cantilever beam contact

- **Mod IV – Thru-Hole**

- New Dual Entry style (top & bottom) with Outrigger and StraightTine Configuration for pass through applications or for use in multiple applications
- End Stackable on SR & DR to achieve higher pin counts
- Side Stackable on DR only to achieve higher row counts
- Dual cantilever beam contact

- **Mod IV – Surface Mount**

- Housing material capable of infrared or vapor phase processes
- New Dual Entry style (top & bottom) with Outrigger and StraightTine Configuration for pass through applications or for use in multiple applications
- Options available for reflow processing:
 - Hold-down
 - Metal Cover for vacuum pickup
 - Tube and Tape & reel packaging

ELECTRICAL

- Current Rating – 3.0 amperes (max.) for single contact; 2.0 amperes (max.) per contact when connector is fully energized
- Contact Resistance – 12 milliohms (max.)
- Insulation Resistance – 5000 megohms (min.) between adjacent contacts
- Dielectric Withstanding Voltage (at sea level) – 750 V rms

MECHANICAL

- Horizontal
 - Mating Force – 6.0 oz.[1.67N] per contact (max.)
 - Unmating Force - .75 oz. [0.21N] per contact (min.) during third mating
 - Durability – 200 cycles
- Vertical
 - Mating Force – 8.0 oz.[2.22N] per contact (max.)
 - Unmating Force - .75 oz. [0.21N] per contact (min.) during third mating
 - Durability – 200 cycles

MATERIALS

- Housings: Black thermoplastic, 94 V-O rated, high temperature plastic
- Contacts: Phosphor bronze

STANDARDS & SPECS

- Product Specifications: 108-25026 & 108-25022
- Application Specification: 114-25018
- Recognized under the Component Program of Underwriters Laboratories Inc., File No. E28476
- Certified by Canadian Standards Association, File No. LR 7189

AMPMODU Horizontal and Vertical Receptacles

PRODUCT OFFERING

Horizontal

- **Mod II – Thru-Hole**
 - Single Row 2-40 & Double Row 4-80 Positions
 - 0.100 [2.54] by 0.100 [2.54] Centerline
 - Duplex 30μ inches gold, 10μ inches gold and tin plating
- **Mod II – Surface Mount**
 - Single Row 2-40 & Double Row 4-80 Positions
 - 0.100 [2.54] by 0.100 [2.54] Centerline
 - Duplex 30μ inches gold, 10μ inches gold and tin plating

Vertical

- **0.100[2.54] by 0.100[2.54] Centerline**
- **Duplex 30μ inches gold, 10μ inches gold and tin plating**
- **Mod II – Thru-Hole**
 - Housing Height of 0.340[8.64]
 - Single Row 2-40 & Double Row 2-40 Positions
- **Mod IV – Thru-Hole**
 - Housing Height of 0.265[6.73]
 - Single Row 2-40 & Double Row 2-80 Position
- **Mod IV – Surface Mount**
 - Housing height of 0.265[6.73]
 - Single Row 3-40 Positions & Double Row 4-80 Positions

PRODUCT DIMENSIONS

Horizontal Surface Mount, Receptacle Assembly

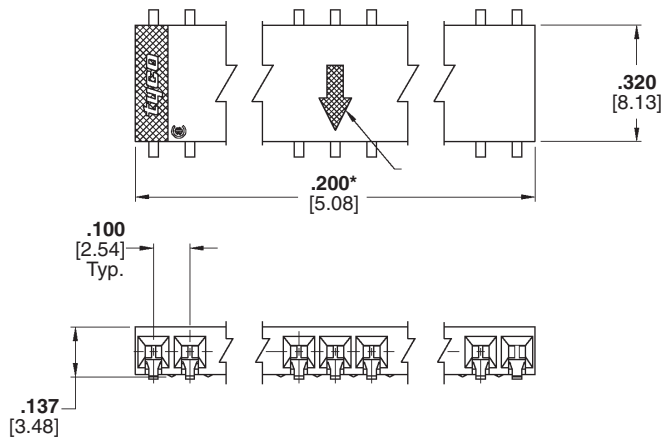

*Dimension for 2-pos. only

1-Row, 2 Position
Part No. 147721-1 shown

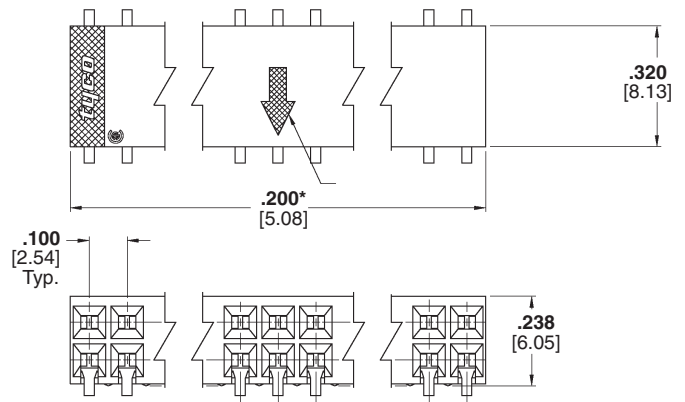

*Dimension for 4 position only

2-Row, 4 Position
Part No. 147722-1 shown

AMPMODU Horizontal and Vertical Receptacles

PRODUCT DIMENSIONS (continued)

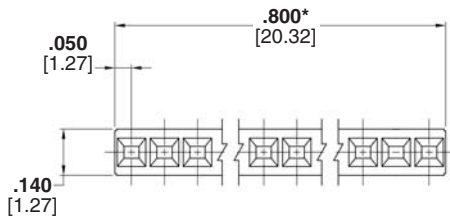
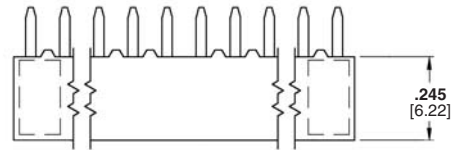
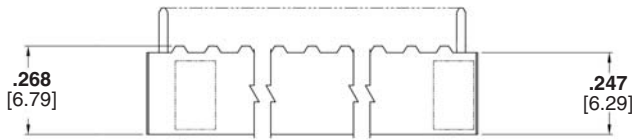

*Dimension for 8 position only

1-Row, 8 Position
Part No. 87879-1 shown

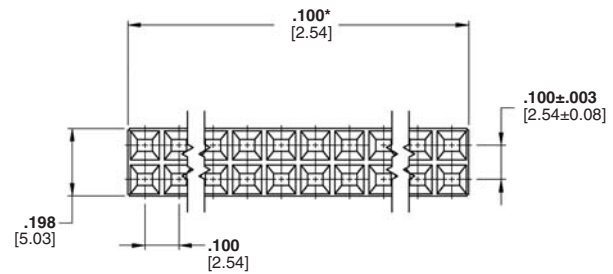

*Dimension for 2 position only

2-Row, 2 Position
Part No. 535542-1 shown

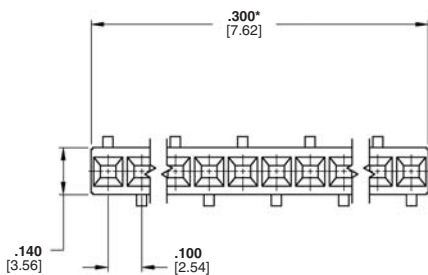
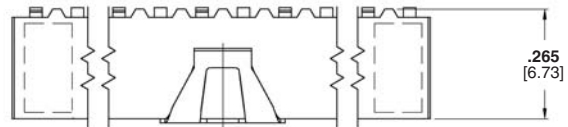
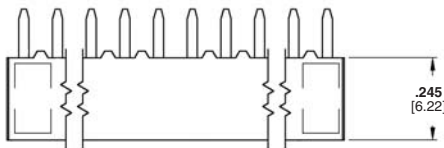

*Dimension for 3 position only

1-Row, 3 Position
Part No. 147720-2 shown

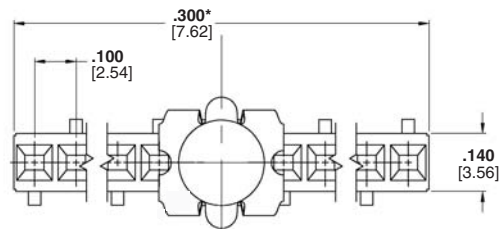

*Dimension for 3 position only

1-Row, 3 Position
Part No. 147738-2 shown

FOR MORE INFORMATION

Technical Support
Internet: www.tycoelectronics.com
E-mail:
newproducts@tycoelectronics.com

USA: 1-800-522-6752
Canada: 1-905-470-4425
Mexico: 52-55-1106-0800
C. America: 57-1-254-4444

South America: 55-11-2103-6000
Hong Kong: 852-2735-1628
Japan: 81-44-844-8013
UK: 44-208-420-8341