

**CHAMP IDC Connector Specifications**

**Plug**

**Style PS—Plug, Screw Lock (Thick Flange)<sup>1</sup>**

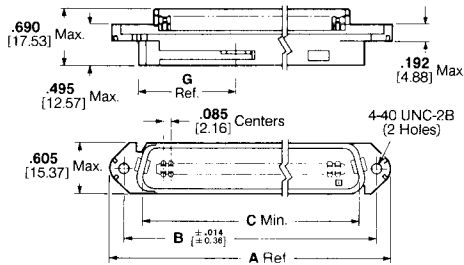

**Style PB—Plug, Bail Lock**

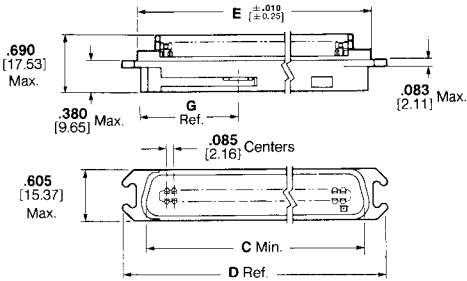

**Receptacle**

**Style RS—Receptacle, Screw or Bail Lock (Thick Flange)<sup>1</sup>**

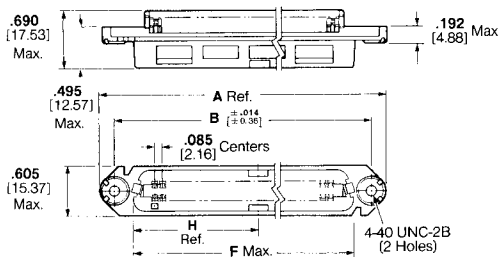

**Style RP—Receptacle, Panel Mount, Screw or Bail Lock (Thin Flange)<sup>2</sup>**

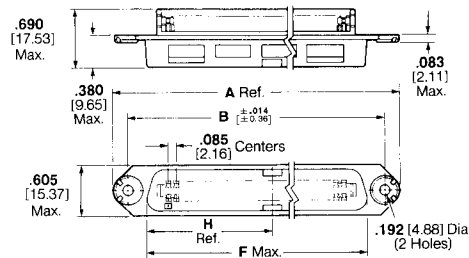

<sup>1</sup>Thick flange connectors are typically for cable-to-cable screw lock applications.

<sup>2</sup>Thin flange connectors are typically for panel mount applications.

No. of Positions	Dimensions							
	A	B	C	D	E	F	G	H
14	1.750 44.45	1.416 35.97	1.001 25.43	1.526 38.76	1.196 30.38	1.000 25.40	.644 16.36	.401 10.19
24	2.175 55.25	1.842 46.79	1.426 36.22	1.951 49.56	1.621 41.17	1.425 36.20	.646 16.41	.825 20.96
36	2.685 68.20	2.352 59.74	1.936 49.17	2.462 62.53	2.132 54.15	1.935 49.15	1.118 28.40	.854 21.69
50	3.280 83.31	2.946 74.83	2.531 64.29	3.056 77.62	2.726 69.24	2.530 64.26	1.123 28.52	1.461 37.11
64	3.875 98.43	3.542 89.97	3.126 79.40	3.651 92.74	3.321 84.35	3.125 79.38	1.608 40.84	1.562 39.67

Note: These dimensions apply to all mating faces of all types of CHAMP Connectors.

No. of Positions	Wire Size				Housing Color Dot Des.	Contact Letter Code	Part Numbers			
	Solid		7 Strand				Plug		Receptacle	
	AWG	mm	AWG	mm <sup>2</sup>			Style PS	Style PB	Style RS	Style RP
14						552300-1	—	—	—	
24						552301-1	552317-1	552305-1	2-552322-1	
36	22	0.65	22	0.40	Green	—	552318-1	—	—	
50						552173-1	552319-1	552064-1	2-552324-1	
64						552303-1	552320-1	552307-1	—	
14						552282-1	552270-1	552312-1	2-552271-1	
24						552283-1	552272-1	552313-1	2-552273-1	
36	24-26	0.51-0.40	24	0.20	Blue	552284-1	552274-1	552314-1	2-552275-1	
50						229974-1	552032-1	229975-1	2-552001-1	
64						552285-1	552276-1	552315-1	2-552277-1	
24						552443-1	552469-1	—	2-552474-1	
36						552444-1	552470-1	—	2-552475-1	
50	—	—	26-27-28	0.14, 0.10, 0.09	Yellow	552390-1	552471-1	552391-1	—	
64						552488-1	—	—	—	

- Notes: 1. A panel mount 50-position plug connector is available in thin flange with .187 [4.75] diameter mounting hole, Part Number 552686-1, which has B slot contacts.  
 2. Style RP is not compatible with integral locking latch receptacle. For thin flange panel mount plug connectors all standard mounting hardware may be utilized with the exception of bail lock mounting hardware.  
 3. Acceptable conductor insulations are polyvinyl chloride (PVC), polyethylene, irradiated polyethylene, polypropylene and TEFLON. **Maximum insulation diameter .045 [1.14] for tools that mass terminate conductors on one side at a time. For tools that insert one conductor per side at a time, .043 [1.09] insulation diameter is the maximum.** As a rule, harder insulations require smaller conductor insulation diameters.

TEFLON is a trademark of E. I. du Pont de Nemours and Company.