

**SPECIFICATIONS:**

**MATERIAL:**  
 BASE & COVER- PET UL94V-0, BLUE  
 ACTUATOR- NYLON PA46 UL94V-0, NATURAL  
 MOVING CONTACT- COPPER ALLOY,  
 SILVER OR GOLD OVER NICKEL  
 FIXED CONTACT- COPPER ALLOY  
 SILVER OR GOLD OVER NICKEL  
 TERMINAL- COPPER ALLOY TIN OVER NICKEL

**ELECTRICAL:**  
 CONTACT RATING: SILVER: 300 MILLIAMPS @ 115 VAC.  
 GOLD: 0.4 VA 20 VDC.  
 CONTACT RESISTANCE: INITIAL 40 MILLIOHMS MAX.  
 INSULATION RESISTANCE: 1000 MEGOHMS MAX.  
 DIELECTRIC STRENGTH: 600 VOLTS RMS AT SEA LEVEL.  
 LIFE EXPECTANCY: 15,000 CYCLES MIN.

**ENVIRONMENTAL:**  
 OPERATING TEMPERATURE: -40°F TO +176°F (-40° TO 80°)  
 SOLDER HEAT RESISTANCE PER 109-202, COND B (THRU-HOLE)  
 & 109-201, COND A (SMT)  
 PROCESS CLEANING: WILL WITHSTAND AQUEOUS OR SOLVENT  
 CLEANING PROCESSES.  
 SOLDERABILITY PER EIA 364-52 CLASS 2 CATEGORY 1

**NOTES: UNLESS OTHERWISE SPECIFIED**

- ALL SWITCHES HAVE OPEN ENDS EXCEPT TOP FLUSH ACTUATOR, WHICH COMES STANDARD WITH TAPE SEAL.
- TAPE AND REEL PER EIA 481 OR 22" ANTI-STATIC TUBES
- ALL MATERIAL AND FINISHES SHALL COMPLY WITH EU DIRECTIVE 2002/95/EC OF 27JAN2003(ROHS)
- STANDARD PRODUCT(AFTER WELD) HEIGHT IS ALLOWED UP TO .180

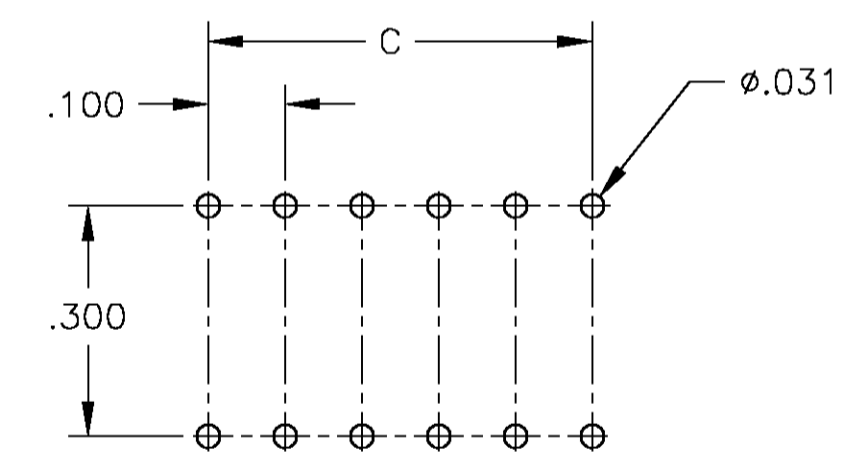
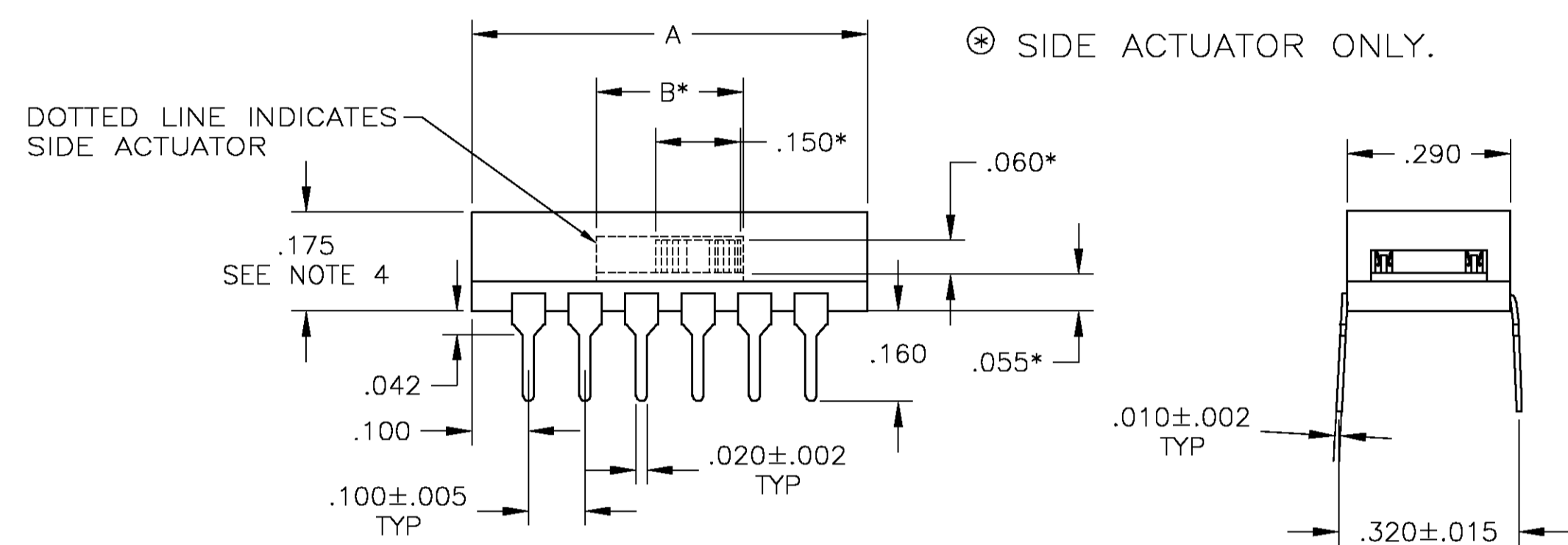
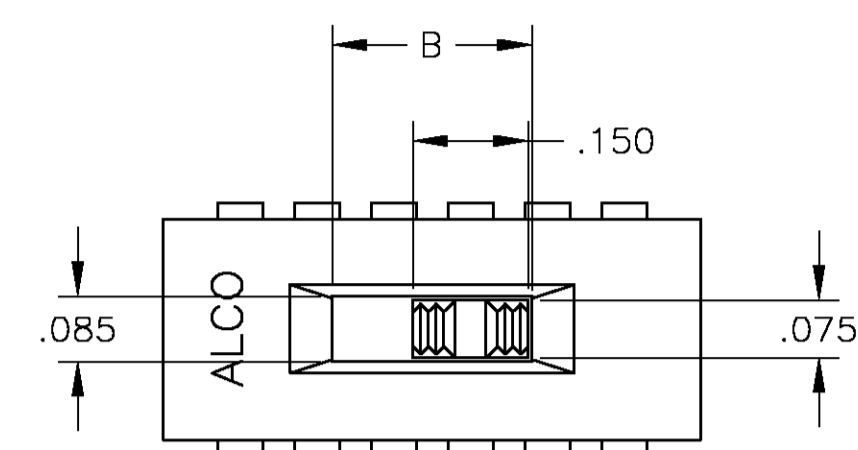

PRINTED CIRCUIT BOARD HOLE PATTERN

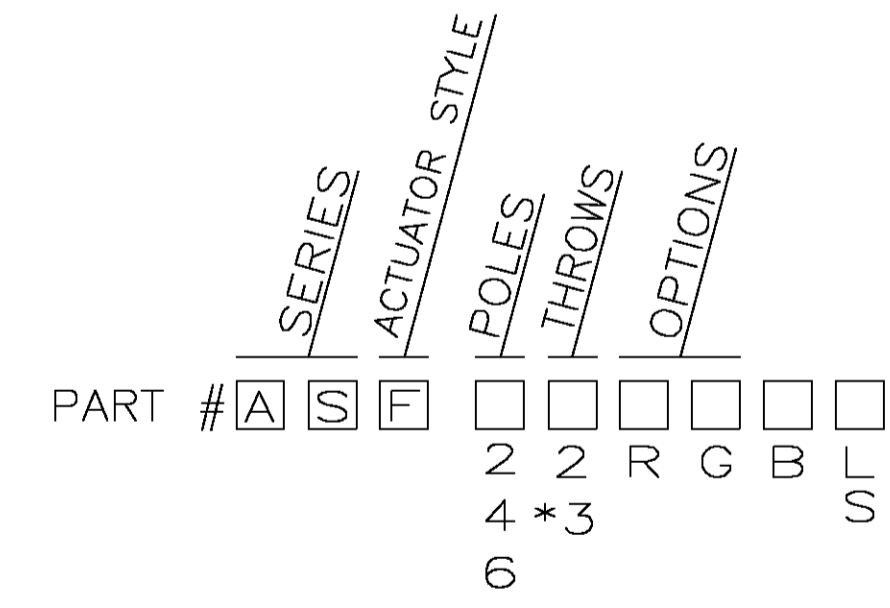

E = EXTENDED ACTUATOR  
 F = FLUSH ACTUATOR  
 \*3 = THROW AVAILABLE IN 4 POLE ONLY  
 R = SIDE ACTUATOR  
 G = GOLD CONTACTS (BLANK SILVER)  
 B = BLACK ACTUATOR  
 L = GULL WING STYLE SURFACE MOUNT  
 S = J-LEAD STYLE SURFACE MOUNT  
 TR = TAPE AND REEL PACKAGING

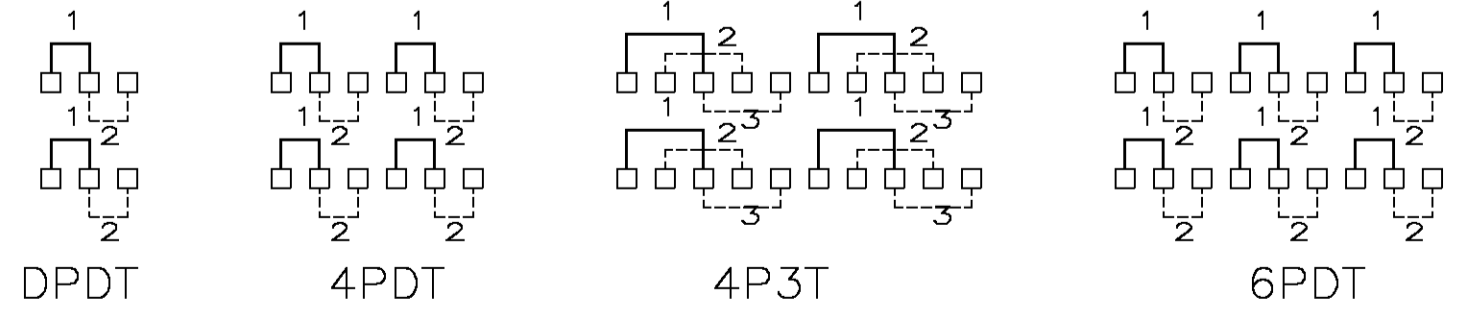

CIRCUIT DIAGRAMS

D	C	B	A	FINISH (ABCD)	MTG STYLE	ACTU- ATION	FUNCTION	ALCO P/N	TYCO P/N
.230	.800	.260	1.000	SILVER	SMT	SIDE	6PDT	ASF62RSTRO4	8-1825011-0
				SILVER	SMT	SIDE	6PDT	ASF62RSO4	7-1825011-9
				GOLD	SMT	SIDE	6PDT	ASF62RGSO4	7-1825011-8
				GOLD	SMT	SIDE	6PDT	ASF62RGS04	7-1825011-7
				SILVER	SMT	SIDE	6PDT	ASF62RLTRO4	7-1825011-6
				SILVER	SMT	SIDE	6PDT	ASF62RLO4	7-1825011-5
				GOLD	SMT	SIDE	6PDT	ASF62RGLTRO4	7-1825011-4
				GOLD	SMT	SIDE	6PDT	ASF62RGL04	7-1825011-3
				SILVER	SMT	TOP	6PDT	ASF62STR04	7-1825011-2
				SILVER	SMT	TOP	6PDT	ASF62S04	7-1825011-1
				GOLD	SMT	TOP	6PDT	ASF62GSTR04	7-1825011-0
				GOLD	SMT	TOP	6PDT	ASF62GS04	6-1825011-9
				SILVER	SMT	TOP	6PDT	ASF62LRO4	6-1825011-8
				SILVER	SMT	TOP	6PDT	ASF62L04	6-1825011-7
				GOLD	SMT	TOP	6PDT	ASF62GLTRO4	6-1825011-6
				GOLD	SMT	TOP	6PDT	ASF62GL04	6-1825011-5
				GOLD	THRU-HOLE	SIDE	6PDT	ASF62RG04	6-1825011-4
				SILVER	THRU-HOLE	SIDE	6PDT	ASF62R04	6-1825011-3
				GOLD	THRU-HOLE	TOP	6PDT	ASF62G04	6-1825011-2
				SILVER	THRU-HOLE	TOP	6PDT	ASF6204	6-1825011-1
.230	.900	.360	1.100	SILVER	SMT	SIDE	4P3T	ASF43RSTRO4	6-1825011-0
				SILVER	SMT	SIDE	4P3T	ASF43RSO4	5-1825011-9
				GOLD	SMT	SIDE	4P3T	ASF43RGSO4	5-1825011-8
				GOLD	SMT	SIDE	4P3T	ASF43RGS04	5-1825011-7
				SILVER	SMT	SIDE	4P3T	ASF43RLTRO4	5-1825011-6
				SILVER	SMT	SIDE	4P3T	ASF43RL04	5-1825011-5
				GOLD	SMT	SIDE	4P3T	ASF43RGLTRO4	5-1825011-4
				GOLD	SMT	SIDE	4P3T	ASF43RGL04	5-1825011-3
				SILVER	SMT	TOP	4P3T	ASF43STR04	5-1825011-2
				SILVER	SMT	TOP	4P3T	ASF43S04	5-1825011-1
				GOLD	SMT	TOP	4P3T	ASF43GSTR04	5-1825011-0
				GOLD	SMT	TOP	4P3T	ASF43GS04	4-1825011-9
				SILVER	SMT	TOP	4P3T	ASF43LRO4	4-1825011-8
				SILVER	SMT	TOP	4P3T	ASF43L04	4-1825011-7
				GOLD	SMT	TOP	4P3T	ASF43GL04	4-1825011-6
				GOLD	SMT	TOP	4P3T	ASF43GL04	4-1825011-5
				GOLD	THRU-HOLE	SIDE	4P3T	ASF43RC04	4-1825011-4
				SILVER	THRU-HOLE	SIDE	4P3T	ASF43R04	4-1825011-3
				GOLD	THRU-HOLE	TOP	4P3T	ASF43G04	4-1825011-2
				SILVER	THRU-HOLE	TOP	4P3T	ASF4304	4-1825011-1
.230	.500	.260	.700	SILVER	SMT	SIDE	4PDT	ASF42RSTRO4	4-1825011-0
				SILVER	SMT	SIDE	4PDT	ASF42RSO4	3-1825011-9
				GOLD	SMT	SIDE	4PDT	ASF42RGSO4	3-1825011-8
				GOLD	SMT	SIDE	4PDT	ASF42RGS04	3-1825011-7
				SILVER	SMT	SIDE	4PDT	ASF42RLTRO4	3-1825011-6
				SILVER	SMT	SIDE	4PDT	ASF42RL04	3-1825011-5
				GOLD	SMT	SIDE	4PDT	ASF42RGLTRO4	3-1825011-4
				GOLD	SMT	SIDE	4PDT	ASF42RGL04	3-1825011-3
				SILVER	SMT	TOP	4PDT	ASF42STR04	3-1825011-2
				SILVER	SMT	TOP	4PDT	ASF42S04	3-1825011-1
				GOLD	SMT	TOP	4PDT	ASF42GSTR04	3-1825011-0
				GOLD	SMT	TOP	4PDT	ASF42GS04	2-1825011-9
				SILVER	SMT	TOP	4PDT	ASF42LRO4	2-1825011-8
				SILVER	SMT	TOP	4PDT	ASF42L04	2-1825011-7
				GOLD	SMT	TOP	4PDT	ASF42GLTRO4	2-1825011-6
				GOLD	SMT	TOP	4PDT	ASF42GL04	2-1825011-5
				GOLD	THRU-HOLE	SIDE	4PDT	ASF42RG04	2-1825011-4
				SILVER	THRU-HOLE	SIDE	4PDT	ASF42R04	2-1825011-3
				GOLD	THRU-HOLE	TOP	4PDT	ASF42G04	2-1825011-2
				SILVER	THRU-HOLE	TOP	4PDT	ASF4204	2-1825011-1
.105	.200	.260	.400	SILVER	SMT	SIDE	DPDT	ASF22RSTRO4	2-1825011-0
				SILVER	SMT	SIDE	DPDT	ASF22RSO4	1-1825011-9
				GOLD	SMT	SIDE	DPDT	ASF22RGSO4	1-1825011-8
				GOLD	SMT	SIDE	DPDT	ASF22RGS04	1-1825011-7
				SILVER	SMT	SIDE	DPDT	ASF22RLTRO4	1-1825011-6
				SILVER	SMT	SIDE	DPDT	ASF22RL04	1-1825011-5
				GOLD	SMT	SIDE	DPDT	ASF22RGLTRO4	1-1825011-4
				GOLD	SMT	SIDE	DPDT	ASF22RGL04	1-1825011-3
				SILVER	SMT	TOP	DPDT	ASF22STR04	1-1825011-2
				SILVER	SMT	TOP	DPDT	ASF22S04	1-1825011-1
				GOLD	SMT	TOP	DPDT	ASF22GSTR04	1-1825011-0
				GOLD	SMT	TOP	DPDT	ASF22GS04	1825011-9
				SILVER	SMT	TOP	DPDT	ASF22LRO4	1825011-8
				SILVER	SMT	TOP	DPDT	ASF22L04	1825011-7
				GOLD	SMT	TOP	DPDT	ASF22GLTRO4	1825011-6
				GOLD	SMT	TOP	DPDT	ASF22GL04	1825011-5
				GOLD	THRU-HOLE	SIDE	DPDT	ASF22RG04	1825011-4
				SILVER	THRU-HOLE	SIDE	DPDT	ASF22R04	1825011-3
				GOLD	THRU-HOLE	TOP	DPDT	ASF22G04	1825011-2
				SILVER	THRU-HOLE	TOP	DPDT	ASF2204	1825011-1

THIS DRAWING IS A CONTROLLED DOCUMENT.

APPROVED: B.S. VISWESWARA, 20FEB05  
 M.S. SARVER  
 M.S. SARVER

TYCO ELECTRONICS CORPORATION  
 HARRISBURG, PA 17105-3608

SLIDE SWITCH ASF, AUTO-INSERTABLE, THRU-HOLE AND SURFACE MOUNT

SIZE: A1 CAGE CODE: 00779 DRAWING NO: 1825011  
 WEIGHT: RESTRICTED TO: 1825011-1

CUSTOMER DRAWING SCALE: 5:1 SHEET: 1 OF 2 REV: 0

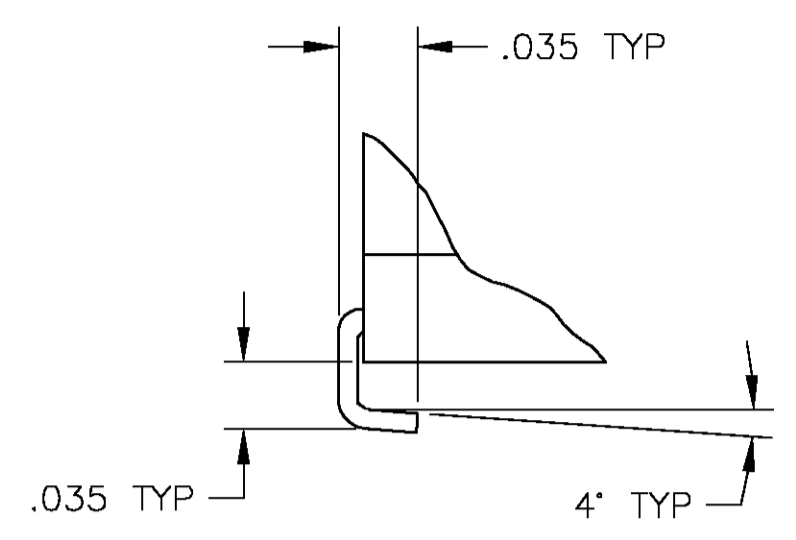
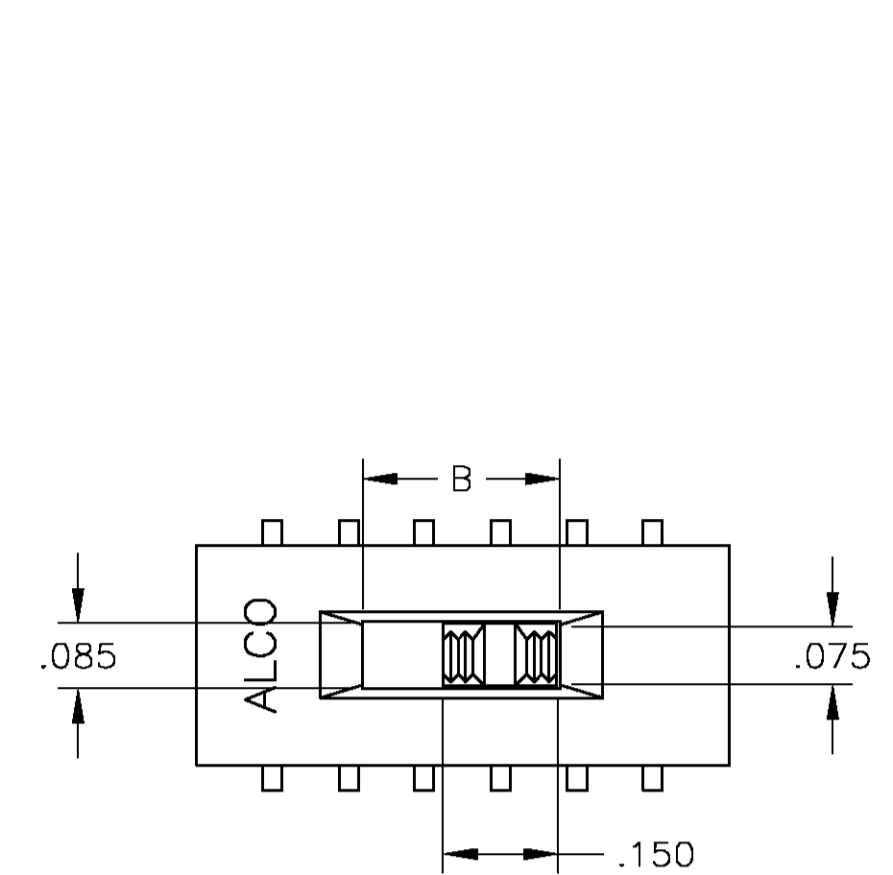

DETAIL A  
SCALE 10:1

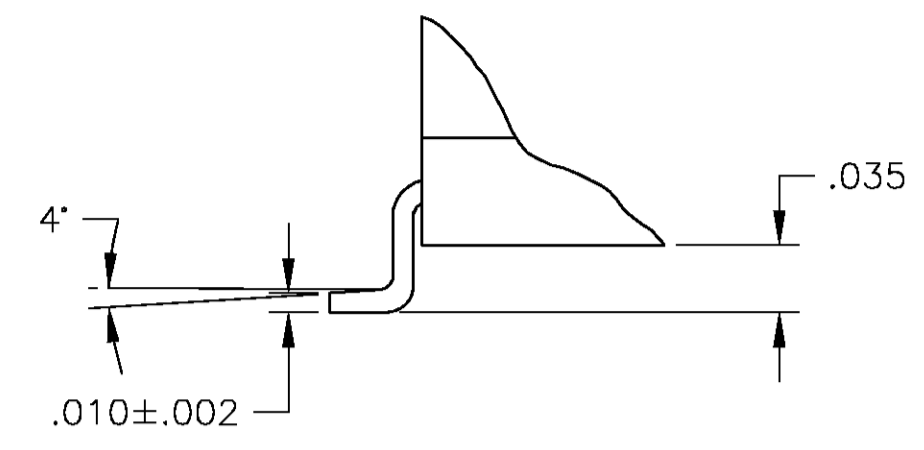
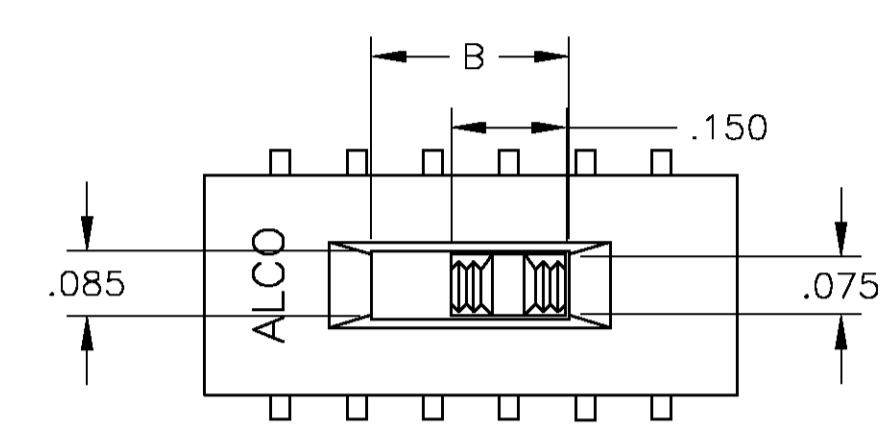

DETAIL B  
SCALE 10:1

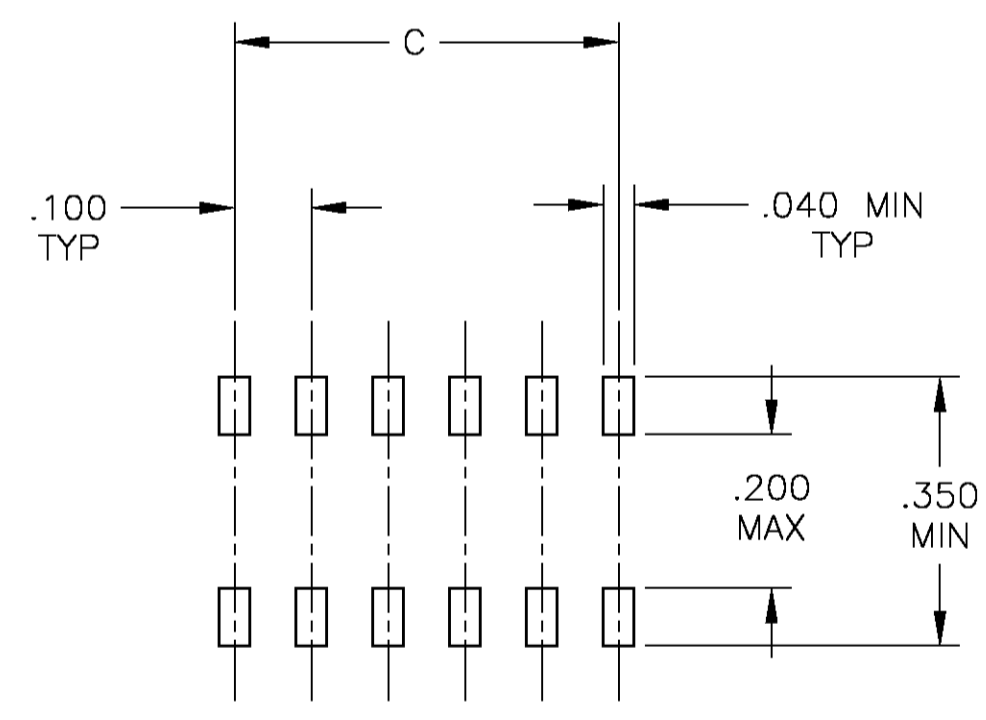
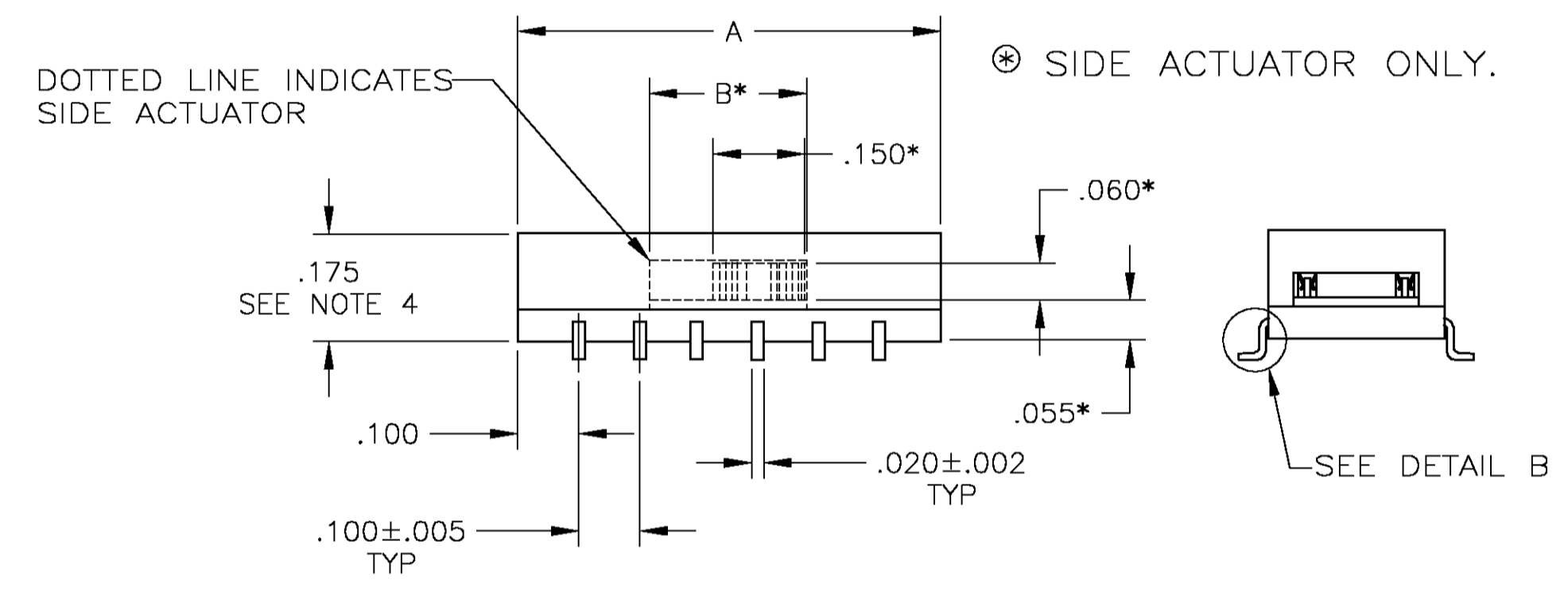
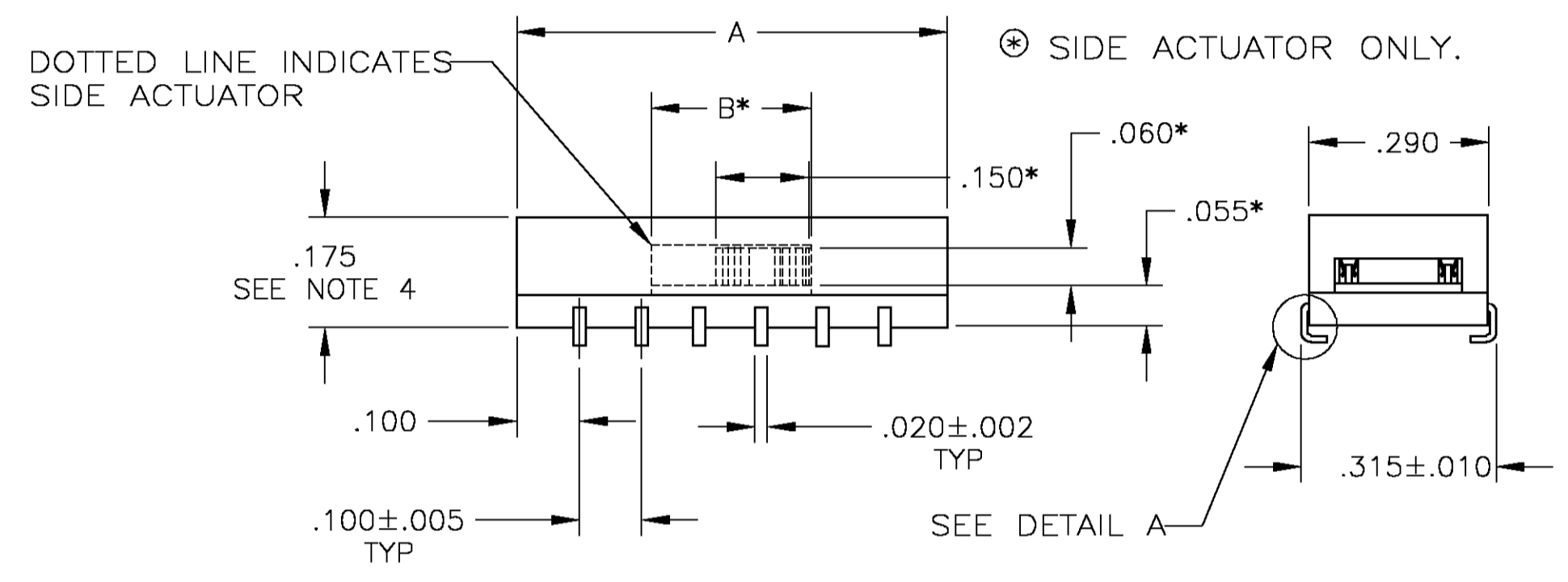

PRINTED CIRCUIT BOARD  
PAD LAYOUT

"S" J-LEAD TYPE SURFACE MOUNT

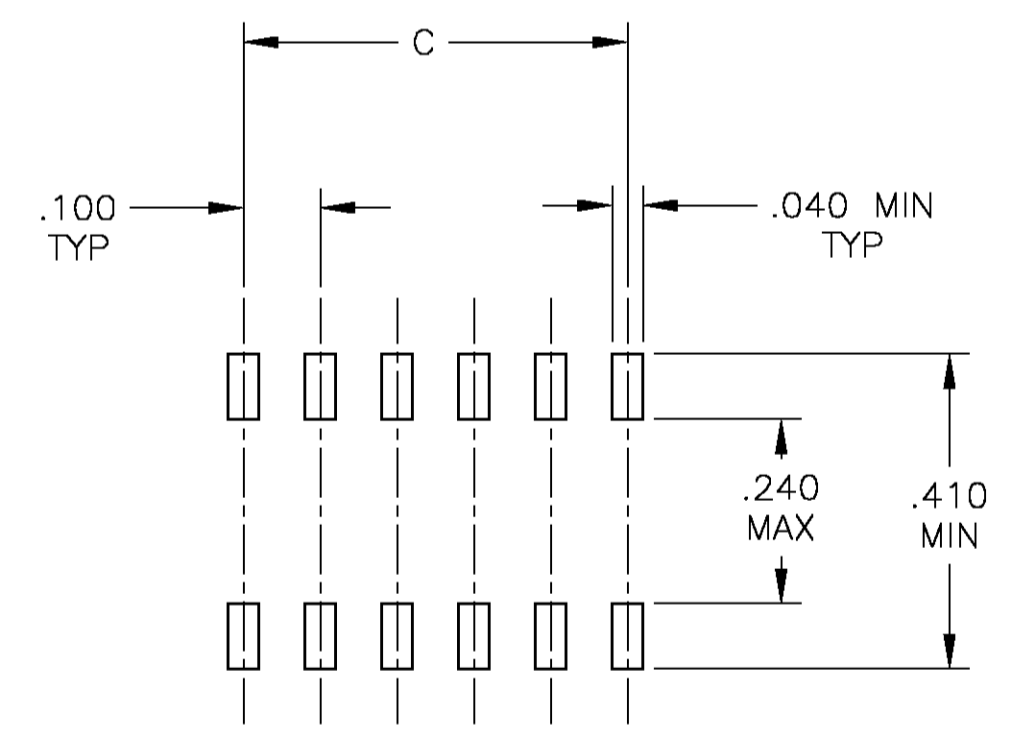

PRINTED CIRCUIT BOARD  
PAD LAYOUT

"L" GULL WING TYPE SURFACE MOUNT

THIS DRAWING IS A CONTROLLED DOCUMENT.		DNW B.S.VISWESWARA	20FEB05		Tyco Electronics Corporation Harrisburg, Pa 17105-3608				
DIMENSIONS: INCHES		CHK M.S.SARVER	APVD M.S.SARVER		NAME SLIDE SWITCH ASE/ASF, AUTO-INSERTABLE, THRU-HOLE AND SURFACE MOUNT				
TOLERANCES UNLESS OTHERWISE SPECIFIED:		0 PLC ± - 1 PLC ± - 2 PLC ± - 3 PLC ± .010 4 PLC ± - ANGLES ± 1°		APPLICATION SPEC	SIZE A1	CAGE CODE 00779	DRAWING NO C=1825011	RESTRICTED TO	
MATERIAL		FINISH		WEIGHT	CUSTOMER DRAWING		SCALE 4:1	SHEET 2 OF 2	REV 0