

THIS DRAWING IS UNPUBLISHED. RELEASED FOR PUBLICATION
 © COPYRIGHT - By - ALL RIGHTS RESERVED.

| LOC | DIST | REVISIONS | | | |
|-----|------|-------------|---------------------------|-----------|-------|
| P | LTR | DESCRIPTION | DATE | DWN | APVD |
| G | 14 | AA | REVISED PER ECO-14-015277 | 13FEB2015 | NK DR |

| | | |
|--------------------------------|--------------------------------|--------------------------------|
| AMP WIRE RANGE | E13288 Listed | LR7189 Certified |
| 22-16 AWG SOLID OR STRANDED | 22-16 AWG SOLID OR STRANDED | 22-16 AWG SOLID OR STRANDED |

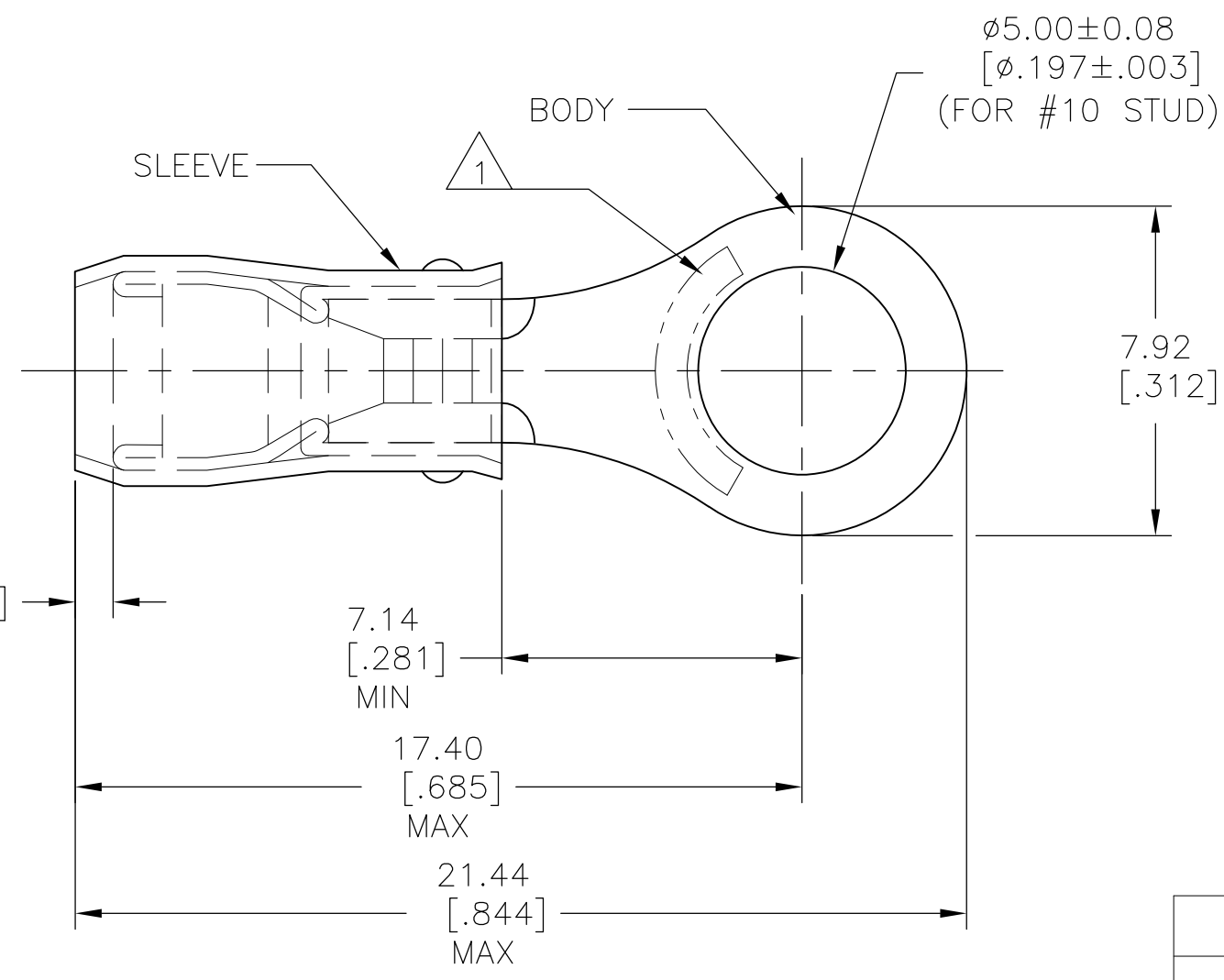

- 1 STAMP AMP 22-18* APPROX AS SHOWN
22-16 TERMINALS ARE STAMPED 22-18 IN
ACCORDANCE WITH MILITARY SPEC MIL-T-7928
COMMERCIAL WIRE RANGE IS 22-16.
- 2 WIRE INSULATION DIA: 2.03-3.18[.080-.125].
- 3 TONGUE MATERIAL THK: 0.79±0.05[.031±.002].

| MILITARY P/N AND CLASS | QUANTITY | PACKAGE TYPE | PART NO |
|-------------------------|----------|------------------|-----------|
| - | 100 | LOOSE PIECE, BOX | 6-36153-1 |
| MS25036-103 CLASS 2 | 5000 | ON TAPE, REEL | 2-36153-2 |
| MS25036-103 CLASS 1 & 2 | 1000 | LOOSE PIECE | 36153 |

| | | |
|---|--|--|
| AMP INCORPORATED CUSTOMER SERVICE SYSTEMS | | MAX RECOMMENDED OPERATING TEMPERATURE: 105°C MAX |
| FOR ADDITIONAL PRODUCT INFORMATION OR COPIES OF DRAWINGS AND TECHNICAL DOCUMENTS | PRODUCT INFORMATION CENTER 1-800-522-6752 | VOLTAGE RATING: 300 V MAX |
| FOR APPLICATION TOOLING INFORMATION | TOOLING ASSISTANCE CENTER 1-800-722-1111 | CIRCULAR MIL AREA: 0.26-1.65mm ² [509-3,260] CIR MILS SOLID OR STRANDED |
| FOR ORDER ENTRY | 1-800-526-5142 | THIS DRAWING IS A CONTROLLED DOCUMENT FOR AMP INCORPORATED. IT IS SUBJECT TO CHANGE AND THE CONTROLLING ENGINEERING ORGANIZATION SHOULD BE CONTACTED FOR THE LATEST REVISION. |

| | | | | |
|--|--|-----------------------------------|--|-----------------------|
| THIS DRAWING IS A CONTROLLED DOCUMENT. | | DWN DK SCHRUM 9/8/93 | TE Connectivity | |
| DIMENSIONS: mm [INCHES] | | CHK RE HERSEY 9/8/93 | | |
| TOLERANCES UNLESS OTHERWISE SPECIFIED: | | APVD ML ELLIS 9/8/93 | NAME TERMINAL, RING TONGUE, PIDG™ WIRE SIZE, 22-16 AWG | |
| 0 PLC ± - 1 PLC ± - 2 PLC ± 0.20[.008] 3 PLC ± - 4 PLC ± - ANGLES ± - | | PRODUCT SPEC UL 486A | SIZE A3 | |
| MATERIAL COPPER PER ASTM B-152 SLEEVE, RED NYLON | | APPLICATION SPEC NOT AVAILABLE | CAGE CODE 00779 | DRAWING NO C-36153 |
| FINISH TIN PLATE PER ASTM B545 | | WEIGHT - | RESTRICTED TO - | |
| CUSTOMER DRAWING | | SCALE NTS | | SHEET 1 OF 2 |
| | | REV AA | | |

THIS DRAWING IS UNPUBLISHED. RELEASED FOR PUBLICATION
 © COPYRIGHT - By - ALL RIGHTS RESERVED.

| LOC | DIST | REVISIONS | | | |
|-----|------|-------------|-------------|-----|------|
| P | LTR | DESCRIPTION | DATE | DWN | APVD |
| G | 14 | - | SEE SHEET 1 | - | - |

AMP
WIRE RANGE

SEE TABLE
STRANDED

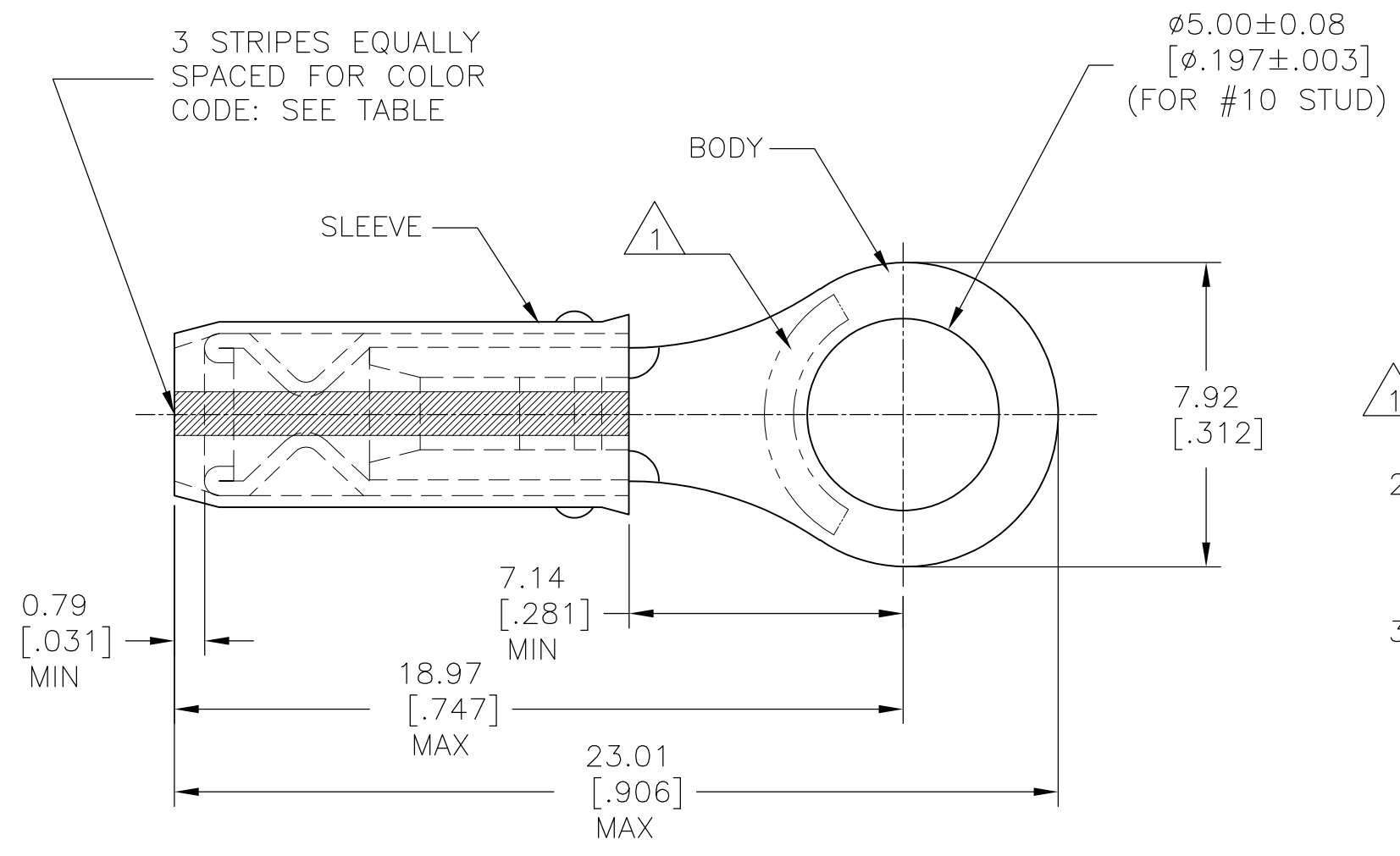

- 1 STAMP AMP [] APPROX AS SHOWN SEE TABLE BELOW.
- 2 WIRE INSULATION DIA: 0.97-2.79[.038-.110] FOR 22 AWG.
1.17-2.79[.046-.110] FOR 20 AWG.
1.42-2.79[.056-.110] FOR 18 AWG.
- 3 TONGUE MATERIAL THK: 0.79±0.05[.031±.002].

| | | | | | | |
|-------------------------|--------------|------------|-----------|----------|------------------|-----------|
| - | WHITE | 18* | 18 | 100 | LOOSE PIECE, BOX | 9-36153-1 |
| - | RED | 20* | 20 | 100 | LOOSE PIECE, BOX | 8-36153-1 |
| - | GREEN | 22* | 22 | 100 | LOOSE PIECE, BOX | 7-36153-1 |
| MS7928/1-33 CLASS 2 | WHITE | 18* | 18 | 5000 | ON TAPE, REEL | 2-36153-9 |
| M7928/1-24 CLASS 2 | RED | 20* | 20 | 5000 | ON TAPE, REEL | 2-36153-8 |
| M7928/1-15 CLASS 2 | GREEN | 22* | 22 | 5000 | ON TAPE, REEL | 2-36153-6 |
| MS7928/1-33 CLASS 1 & 2 | WHITE | 18* | 18 | 1000 | LOOSE PIECE | 2-36153-5 |
| M7928/1-24 CLASS 1 & 2 | RED | 20* | 20 | 1000 | LOOSE PIECE | 2-36153-4 |
| M7928/1-15 CLASS 1 & 2 | GREEN | 22* | 22 | 1000 | LOOSE PIECE | 2-36153-3 |
| MILITARY P/N AND CLASS | STRIPE COLOR | 1 STAMPING | WIRE SIZE | QUANTITY | PACKAGE TYPE | PART NO |

AMP INCORPORATED
CUSTOMER SERVICE SYSTEMS

FOR ADDITIONAL PRODUCT INFORMATION OR COPIES OF DRAWINGS AND TECHNICAL DOCUMENTS FOR APPLICATION TOOLING INFORMATION FOR ORDER ENTRY

PRODUCT INFORMATION CENTER
1-800-522-6752

TOOLING ASSISTANCE CENTER
1-800-722-1111

1-800-526-5142

MAX RECOMMENDED OPERATING TEMPERATURE:
105°C MAX

VOLTAGE RATING: 300 V MAX

| | |
|-------------|-----------------------------|
| WIRE RANGE: | CIRC MIL AREA: |
| 22 | 0.38mm ² [754] |
| 20 | 0.60mm ² [1,186] |
| 18 | 0.96mm ² [1,900] |

STRANDED

THIS DRAWING IS A CONTROLLED DOCUMENT FOR AMP INCORPORATED. IT IS SUBJECT TO CHANGE AND THE CONTROLLING ENGINEERING ORGANIZATION SHOULD BE CONTACTED FOR THE LATEST REVISION.

THIS DRAWING IS A CONTROLLED DOCUMENT.

| | |
|----------------------------|--|
| DIMENSIONS: mm [INCHES] | TOLERANCES UNLESS OTHERWISE SPECIFIED: |
| | 0 PLC ± - |
| | 1 PLC ± - |
| | 2 PLC ± 0.20[.008] |
| | 3 PLC ± - |
| | 4 PLC ± - |
| | ANGLES ± - |

MATERIAL: COPPER PER ASTM B-152 SLEEVE, RED NYLON

FINISH: TIN PLATE PER ASTM B545

| | | |
|------------------|---------------|--------|
| DWN | DK SCHRUM | 9/8/93 |
| CHK | RE HERSEY | 9/8/93 |
| APVD | ML ELLIS | 9/8/93 |
| PRODUCT SPEC | - | - |
| APPLICATION SPEC | NOT AVAILABLE | - |
| WEIGHT | - | - |

CUSTOMER DRAWING

STE TE Connectivity

NAME: TERMINAL, RING TONGUE, I.R., PIDG™ WIRE SIZE, 22-16 AWG

| | | | |
|------|-----------|------------|---------------|
| SIZE | CAGE CODE | DRAWING NO | RESTRICTED TO |
| A3 | 00779 | C-36153 | - |

SCALE: NTS SHEET: 2 OF 2 REV: AA