

## Miniature Spring Sockets (Continued)

### Bullet Nose Sockets (Loose Piece and Tape Mounted)

**Material**

**Spring** — Beryllium copper

**Contact Sleeve** — Copper

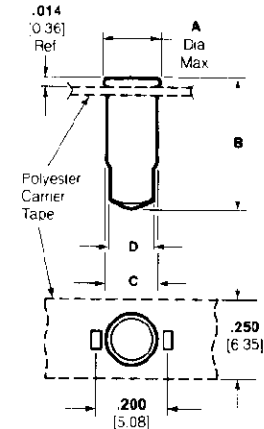

### Flat Bottom Sockets

**Closed Bottom**

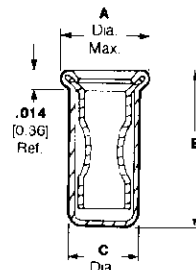

**Open Bottom\***

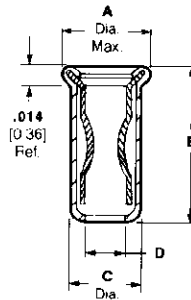

**Knockout Bottom\*\***

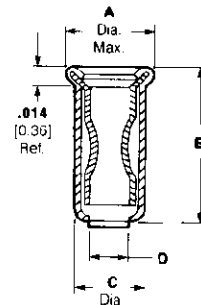

\*Open Bottom Sockets can be made available.  
\*\*See page 137 for knockout plug tool.

**Series 2 Sockets** — For .014-.026 [0.36-0.66] Round and .010-.018 [0.25-0.46] Square Leads<sup>3</sup>

**Flat Bottom** — Recommended Hole Size:  $.052^{+.003}_{-.000}$  [ $1.32^{+0.08}_{-0.00}$ ] for Semiautomatic Insertion or Hand Insertion

| Pin Dia.<br>Range      | Dimensions   |              |              |                | Finish            |                   | Part Numbers  |                 |
|------------------------|--------------|--------------|--------------|----------------|-------------------|-------------------|---------------|-----------------|
|                        | A            | B            | C            | D <sup>4</sup> | Spring            | Sleeve            | Closed Bottom | Knockout Bottom |
| .028-.021<br>0.46-0.53 | .070<br>1.78 | .138<br>3.51 | .050<br>1.27 | .030<br>0.75   | Gold <sup>1</sup> | Gold <sup>2</sup> | 2-331272-2    | 3-331272-0      |
|                        |              |              |              |                | Gold <sup>1</sup> | Tin               | 2-331272-3    | 3-331272-1      |
|                        |              |              |              |                | Tin               | Tin               | 2-331272-1    | —               |
| .014-.026<br>0.36-0.66 | .070<br>1.78 | .260<br>6.6C | .050<br>1.27 | .030<br>0.76   | Gold <sup>1</sup> | Gold <sup>2</sup> | 50863-4       | —               |
|                        |              |              |              |                | Gold <sup>1</sup> | Tin               | 50863-5       | 50863-3         |
|                        |              |              |              |                | Tin               | Tin               | 50863-8       | 50863-7         |
| .022-.025<br>0.56-0.64 | .070<br>1.78 | .138<br>3.51 | .050<br>1.27 | .030<br>0.76   | Gold <sup>1</sup> | Gold <sup>2</sup> | 2-331272-6    | 3-331272-4      |
|                        |              |              |              |                | Gold <sup>1</sup> | Tin               | 2-331272-7    | 3-331272-5      |
|                        |              |              |              |                | Tin               | Tin               | 2-331272-5    | 3-331272-3      |
| .014-.026<br>0.36-0.66 | .070<br>1.78 | .178<br>4.52 | .050<br>1.27 | .030<br>0.76   | Gold <sup>1</sup> | Gold <sup>2</sup> | 50462-6       | —               |
|                        |              |              |              |                | Gold <sup>1</sup> | Tin               | 50462-8       | 50462-5         |
|                        |              |              |              |                | Tin               | Tin               | 50462-7       | 50462-4         |

**Bullet Nose** — Recommended Hole Size:  $.052^{+.003}_{-.000}$  [ $1.32^{+0.08}_{-0.00}$ ] for Semiautomatic/Automatic Insertion or Hand Insertion

| Pin Dia.<br>Range      | Dimensions   |              |              |              | Finish            |        | Part Numbers |                                |                             |
|------------------------|--------------|--------------|--------------|--------------|-------------------|--------|--------------|--------------------------------|-----------------------------|
|                        | A            | B            | C            | D            | Spring            | Sleeve | Loose Piece  | Polyester Carrier Tape         |                             |
|                        |              |              |              |              |                   |        |              | Without Sealant<br>50,000/Reel | With Sealant<br>50,000/Reel |
| .014-.026<br>0.35-0.66 | .075<br>1.91 | .184<br>4.67 | .051<br>1.30 | .047<br>1.19 | Gold <sup>1</sup> | Tin    | 645952-2     | —                              | 645955-2                    |
|                        |              |              |              |              |                   |        |              | 645952-1                       | 645955-1                    |
| .020-.026<br>0.51-0.66 | .075<br>1.91 | .158<br>4.01 | .048<br>1.22 | .047<br>1.19 | Gold <sup>1</sup> | Tin    | 645951-2     | 645954-2                       | 645953-2                    |
|                        |              |              |              |              |                   |        |              | 645951-1                       | 645954-1                    |

<sup>1</sup>.000030 [0.00076] gold plating.

<sup>2</sup>Gold flash.

<sup>3</sup>To calculate diameter required for rectangular or square leads: Pin Diameter =  $\sqrt{(Lead Width)^2 + (Lead Thickness)^2}$  + .003 [0.08].

<sup>4</sup>Applies to Open Bottom and Knockout Bottom Sockets only.