



**Have a Question?**  
 Chat with a Product Information Specialist

What can we help you find?

[Products](#) [Industries](#) [Resources](#) [About TE](#) [My Account](#) [Innovation](#) [Support Center](#)

## 745203-9 Product Details

[Share](#) [Print](#) [Email](#)



**745203-9**

TE Internal Number: 745203-9

Active

[View 3D PDF](#)

### Standard Cable Connectors

Always EU RoHS/ELV Compliant (Statement of Compliance)

#### Product Highlights:

- Connector
- Product Series = HDE-20 (IDC)
- 9 Positions
- Without Enclosure
- Connector Style = Plug

[View all Features](#)

### Quick Links

- ▶ [Pricing & Availability](#)
- ▶ [Search for Tooling](#)
- ▶ [View Mating Products \(24\)](#)
- ▶ [Product Feature Selector](#)
- ▶ [Contact Us About This Product](#)

[Add to My Part List](#) [Request Sample](#) [Find Similar Products](#) [Buy Product](#)

### Documentation & Additional Information

#### Product Drawings:

- [PLUG ASSEMBLY, SIZE 1, 9 POSITION, AMPLIMITE \(PDF, English\)](#)

#### Catalog Pages/Data Sheets:

- None Available

#### Product Specifications:

- [AMPLIMITE HDE-20 Insulation Displacement Connector \(PDF, English\)](#)

#### Application Specifications:

- [AMPLIMITE HDE-20 IDC Connectors \(PDF, English\)](#)

#### Instruction Sheets:

- [AMPLIMITE High-Density \(HDE-20\) Insulation Displacement... \(PDF, English\)](#)

#### CAD Files: (CAD Format & Compression Information)

- [2D Drawing \(DXF, Version S\)](#)
- [3D Model \(IGES, Version S\)](#)
- [3D Model \(STEP, Version S\)](#)

[List all Documents](#)

#### Additional Information:

- [Product Line Information](#)

#### Related Products:

- [Tooling](#)
- [Mating Products \(24\)](#)

### Product Features (Please use the Product Drawing for all design activity)

#### Product Type Features:

- **Product Type** = Connector
- **Product Series** = HDE-20 (IDC)
- **Wire/Cable Type** = Discrete Wire, Round Jacketed Cable
- **Termination Method to Wire/Cable** = Insulation Displacement Crimp (IDC)
- **Wire Insulation Diameter (mm [in])** = 1.52 [0.060]
- **Mating Connector Lock** = With
- **Mating Connector Lock Type** = Mounting Holes
- **Shell Size** = 1
- **Shell Type** = All Plastic
- **Grounding Indents** = Without
- **Grade** = Standard
- **Color** = Black

#### Termination Features:

- **Solder Tail Contact Plating** = Matte Tin over Nickel

#### Body Features:

- **Wire Range (mm<sup>2</sup> [AWG])** = 0.15 - 0.40 [26-22]

#### Contact Features:

- **Contact Type** = Pin
- **Contact Base Material** = Phosphor Bronze
- **Contact Plating, Mating Area, Material** = Gold Flash over Palladium Nickel or Gold (30) over Nickel
- **Contact Size** = 20

#### Housing Features:

- **Enclosure** = Without
- **Connector Style** = Plug
- **Housing Material** = Thermoplastic - GF
- **UL Flammability Rating** = UL 94V-0

#### Configuration Features:

- **Number of Positions** = 9
- **Preloaded** = Yes

#### Industry Standards:

- **RoHS/ELV Compliance** = RoHS compliant, ELV compliant
- **Lead Free Solder Processes** = Not relevant for lead free process
- **RoHS/ELV Compliance History** = Always was RoHS compliant

#### Other:

- **Brand** = AMP
- **Comment** = All connectors are preloaded. Individual conductor strands should be larger than 0.13 [0.005] diameter. Contacts accept a max. wire insulation thickness of 0.38 [0.015]. HDE connectors are designed for terminating solid or stranded (7-strand max.) wire.; HDE connectors are designed for terminating solid or stranded (7-strand max.) wire.; Individual conductor strands should be larger than 0.127 in. [0.005] diameter.

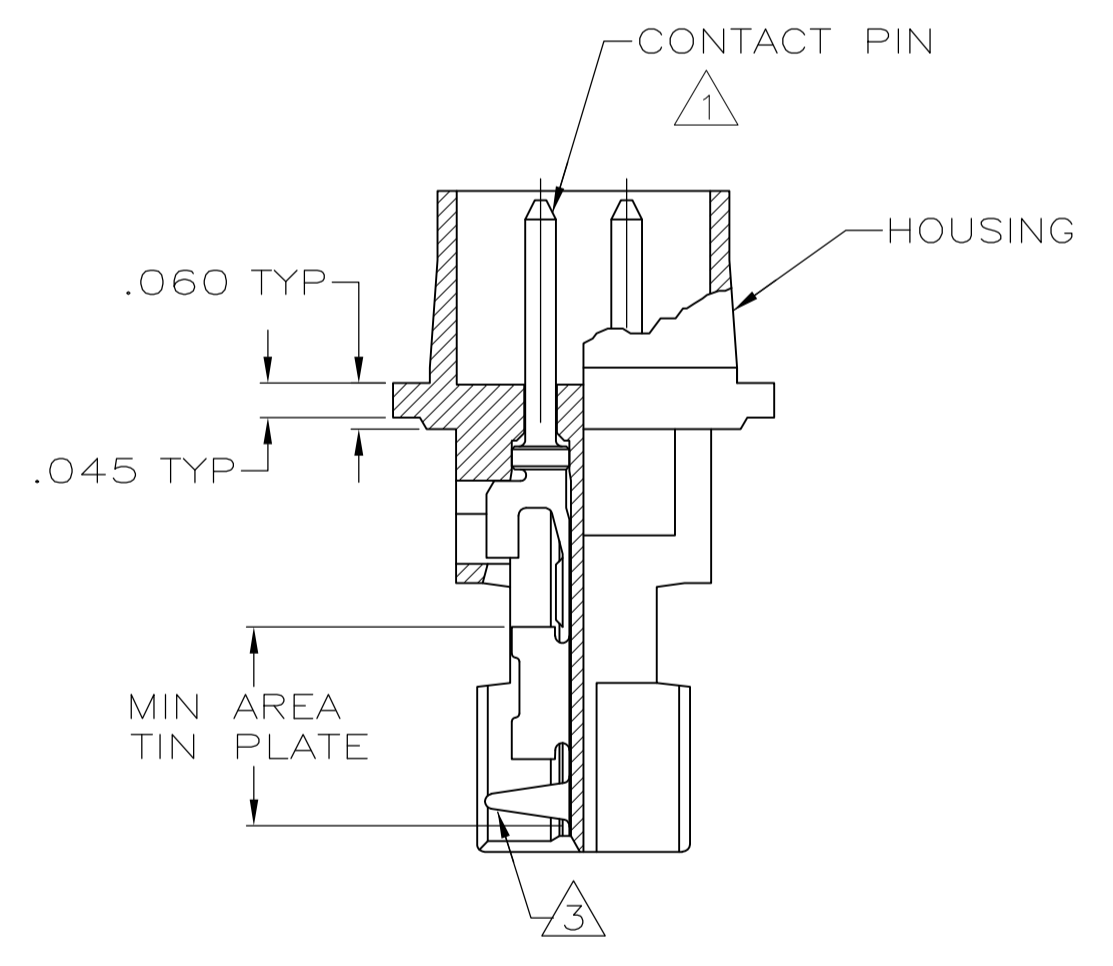
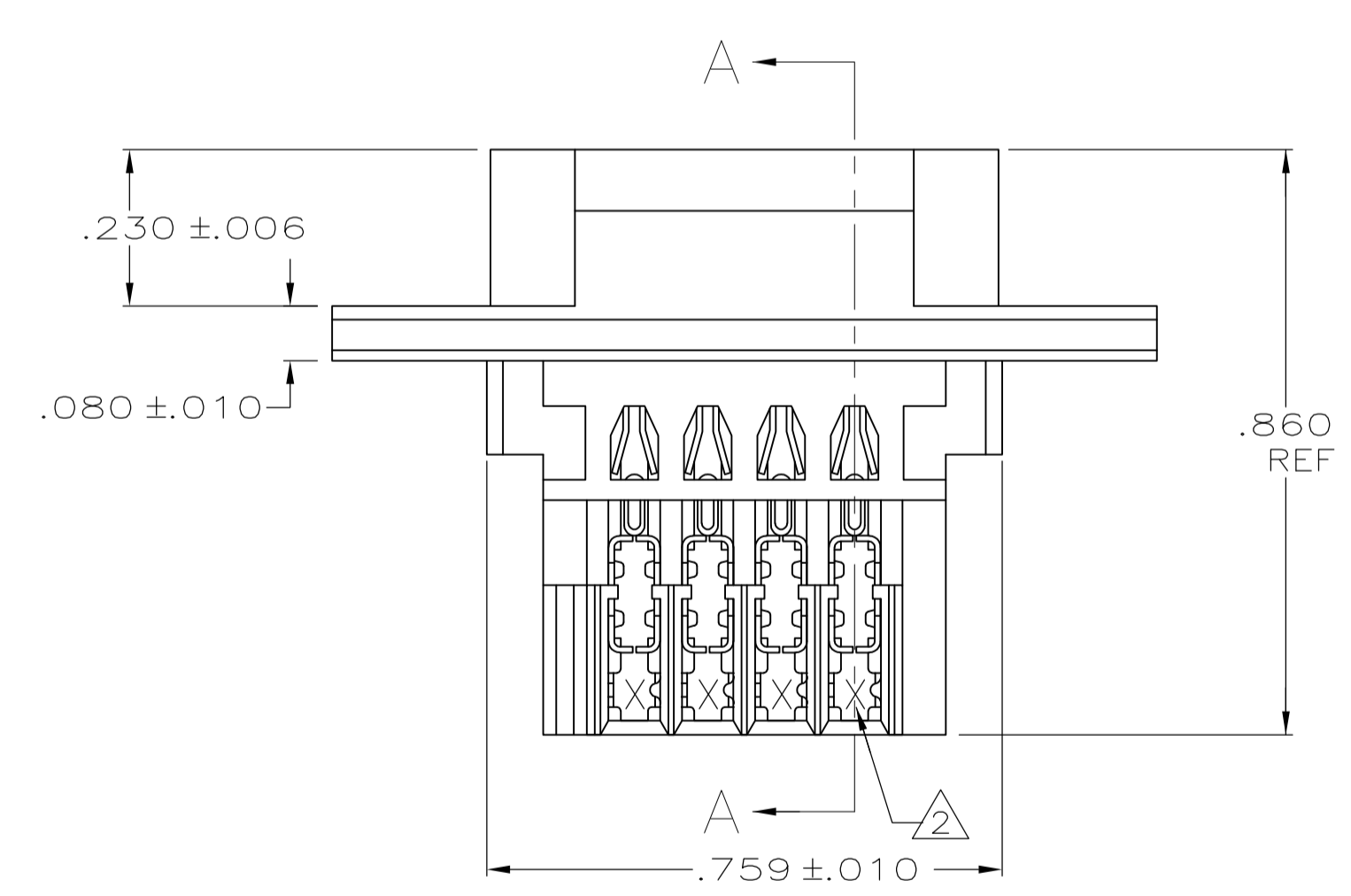
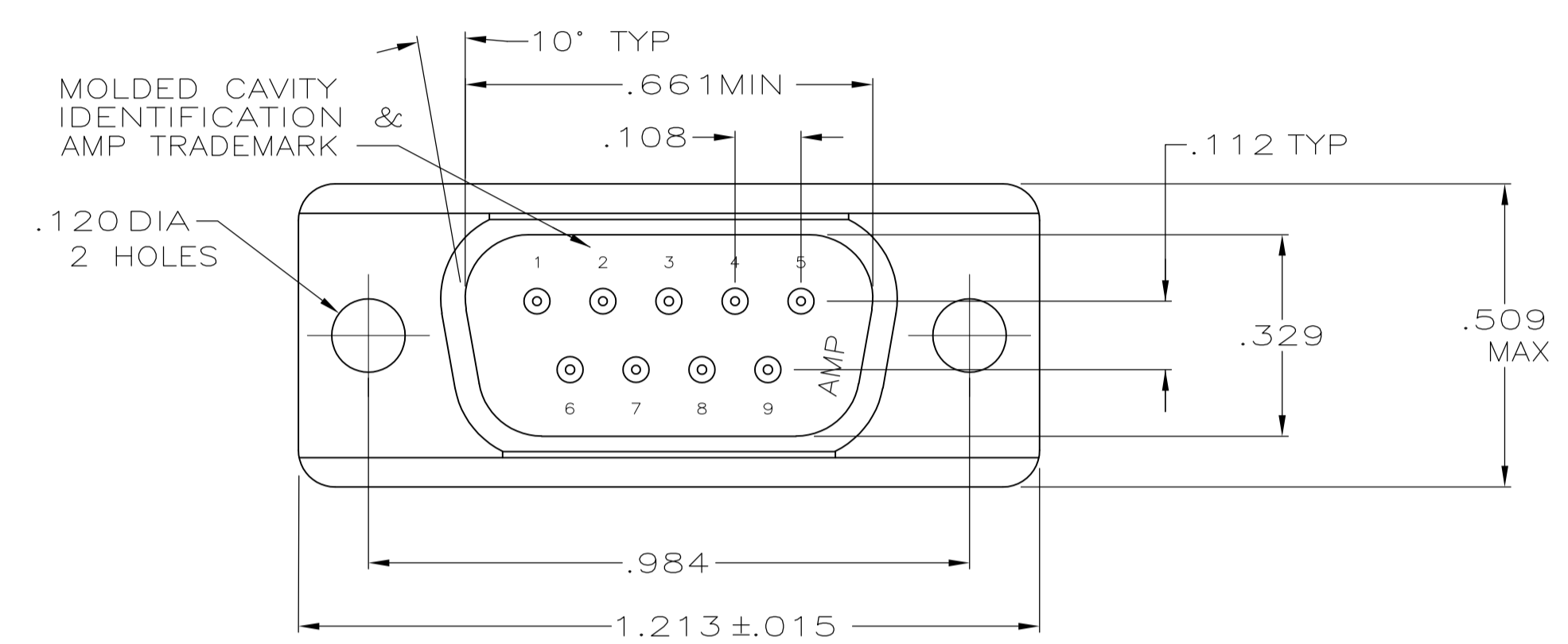

SECTION A-A

- 1 HOUSING FULLY LOADED WITH CONTACTS.
- 2 NUMBER ON CONTACT INDICATES WIRE RANGE.
- 3 CONTACT INSULATION RANGE: .060 MAXIMUM O.D.
- 4 CONTACTS PLATED GOLD PLATED FOR LENGTH OF .150 MIN FROM MATING END, .000030 MIN GOLD IN MATED AREA. .000100-.000200 BRIGHT TIN OR BRIGHT IN TIN-LEAD AREA SHOWN. .000050 NICKEL UNDERPLATE ON ENTIRE CONTACT.
- 5 CONTACTS PLATED GOLD PLATED FOR LENGTH OF .150 MIN FROM MATING END, GOLD FLASH IN MATED AREA. .000100-.000200 BRIGHT TIN OR BRIGHT IN TIN-LEAD AREA SHOWN. .000030 NICKEL UNDERPLATE ON ENTIRE CONTACT.
- 6 CONTACTS PLATED .000100-.000200 THICK BRIGHT TIN OR BRIGHT TIN-LEAD WITH .000050 THICK NICKEL UNDERPLATE BOTH OVER ENTIRE CONTACT.
- 7 CONTACTS GOLD PLATED FOR A LENGTH OF .150 MIN FROM MATING END, .000030 MIN GOLD IN MATED AREA, .000100-.000200 MATTE TIN IN AREA SHOWN, ALL OVER .000050 MIN NICKEL UNDERPLATE ON ENTIRE CONTACT.  
OR  
CONTACTS GOLD PLATED FOR A LENGTH OF .150 MIN FROM MATING END, GOLD FLASH OVER PALLADIUM-NICKEL, .000030 MIN TOTAL IN MATED AREA, .000100-.000200 MATTE TIN IN AREA SHOWN, ALL OVER .000050 MIN NICKEL UNDERPLATE ON ENTIRE CONTACT.
- 8 CONTACTS PLATED GOLD FLASH FOR A LENGTH OF .150 MIN FROM MATING END, .000100-.000200 MATTE TIN IN AREA SHOWN, ALL OVER .000030 MIN NICKEL UNDERPLATE ON ENTIRE CONTACT.
- 9 HOUSING: BLACK THERMOPLASTIC 94V-0 RATED.  
CONTACTS: PHOSPHOR BRONZE.

	2	#22-26	1-745203-1
OBSOLETE	3	#20-22	1-745203-0
	2	#22-26	745203-9
OBSOLETE	1	#26-30	745203-8
	1	#26-30	745203-7
SUPD BY 745203-3	3	#20-22	745203-6
OBSOLETE	2	#22-26	745203-5
OBSOLETE	1	#26-30	745203-4
OBSOLETE	3	#20-22	745203-3
OBSOLETE	2	#22-26	745203-2
OBSOLETE	1	#26-30	745203-1
FINISH	2	AWG WIRE RANGE	PART NUMBER

THIS DRAWING IS A CONTROLLED DOCUMENT.

DIMENSIONS: INCHES	TOLERANCES UNLESS OTHERWISE SPECIFIED:	DIN 11-17-04	TE Connectivity
0 PLC ± -	1 PLC ± -	L VARELA - DOCKS 11-17-04	
2 PLC ± -	3 PLC ± .005	J GERACE 11-17-04	
4 PLC ± -	ANGLES ± .2°	M WALMSLEY 11-17-04	
MATERIAL	FINISH	NAME	PLUG ASSEMBLY, SIZE 1, 9 POSITION, AMPLIMITE
SEE TABLE	SEE TABLE	PRODUCT SPEC	108-40011
		APPLICATION SPEC	114-40002
		SIZE	A1
		WEIGHT	00779
		CUSTOMER DRAWING	745203

SCALE 4:1 SHEET 1 OF 1 REV T1