

DO NOT SCALE

DIMENSIONS IN mm

METRIC

THIRD ANGLE PROJECTION

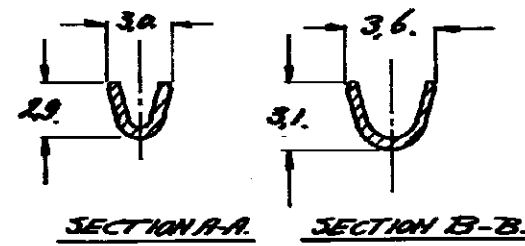
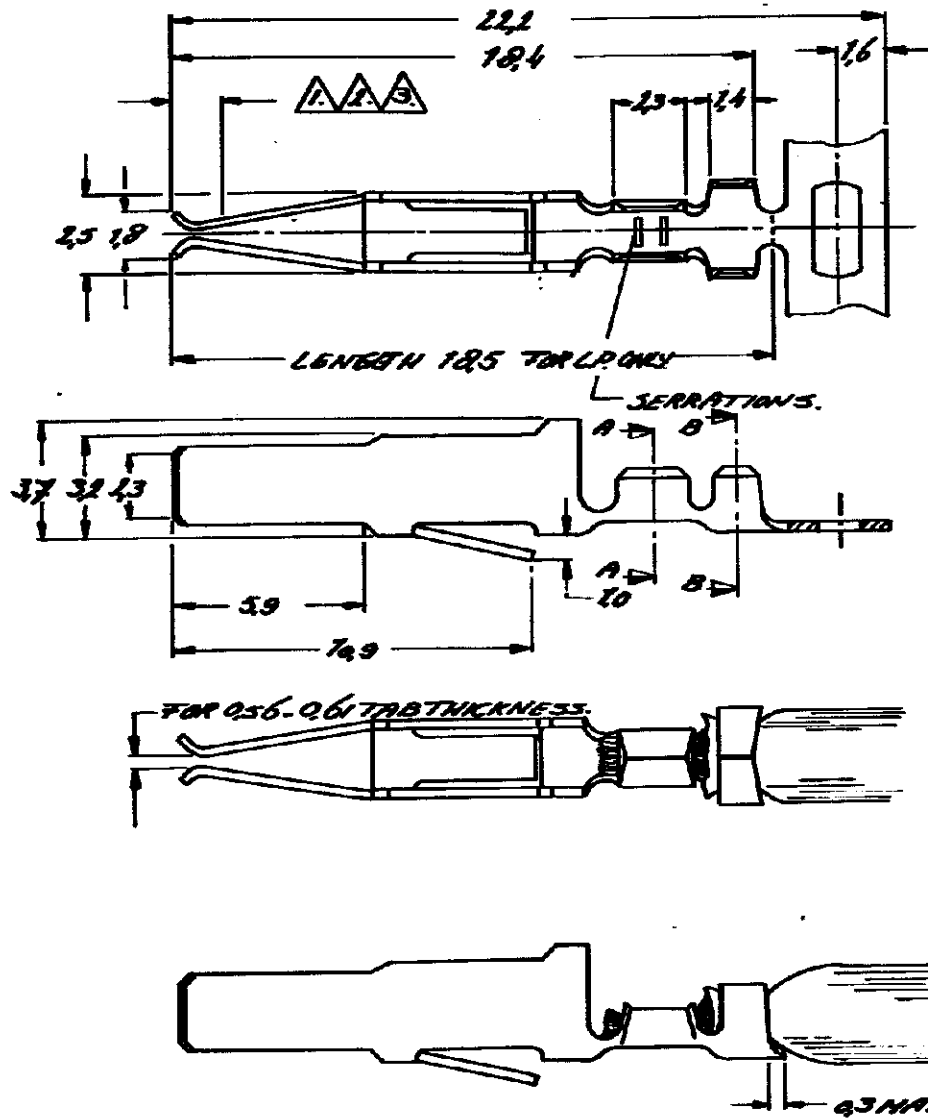
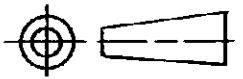

FOR REFERENCE ONLY
WILL NOT BE UP - DATED

NOTES:

- ① 1.15 μm SELECTIVE GOLD OVER 1.15 μm NICKEL REMAINDER 1.15 μm Ni.
- ② 0.75 μm SELECTIVE GOLD OVER 1.15 μm NICKEL REMAINDER 1.15 μm Ni.
- ③ 0.4 μm SELECTIVE GOLD OVER 1.15 μm NICKEL REMAINDER 1.15 μm Ni.

166633-3.	SEE NOTE B	P.H. BRONZE.	166461-4.
166633-2.	SEE NOTE E	P.H. BRONZE	166461-3.
166633-1.	SEE NOTE A	P.H. BRONZE	166461-2.
LOOSE PIECE.	FINISH	MATERIAL	PART NUMBER
CUSTOMER DRAWING FOR REFERENCE ONLY WILL NOT BE UPDATED	AMP		AMP-HOLLAND B.V. 's-Hertogenbosch, The Netherlands
	THIS DRAWING IS UNPUBLISHED		RELEASED FOR PUBLICATION . 19
© COPYRIGHT 19 BY AMP-HOLLAND B.V. ALL INTERNATIONAL RIGHTS RESERVED. AMP PRODUCTS MAY BE COVERED BY U.S. AND FOREIGN PATENTS AND/OR PATENTS PENDING.			
DR. TR. HUISMAN 18-3-83	WIRE RANGE 0.50-1.5 mm ²	NAME CRIMP ON / 3MM IN. TAB RECEPTACLE STRIP	REV DATE D M Y 08 01 93
CHK. P. van. 22/3-83	INSUL RANGE 2.0-2.5 mm	SIZE A3	REV. LTR C
APP. P. 24.3.83	SHEET 7 OF 7	DRAWING NO C-166461-E.	

8

7

6

5

4

3

2

1

NOT the LATEST REVISION