

REVISIONS

P	LTR	DESCRIPTION	DATE	DWN	APVD
	C	REVISED	01OCT2009	T.S	N.Y
	D	ECR-18-010764	27JUL2018	P.P	P.J

P/N 2069250-1 AS SHOWN:

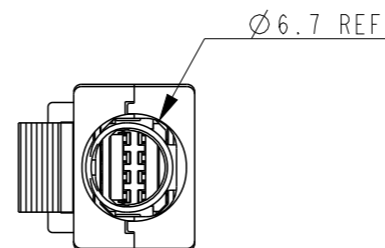
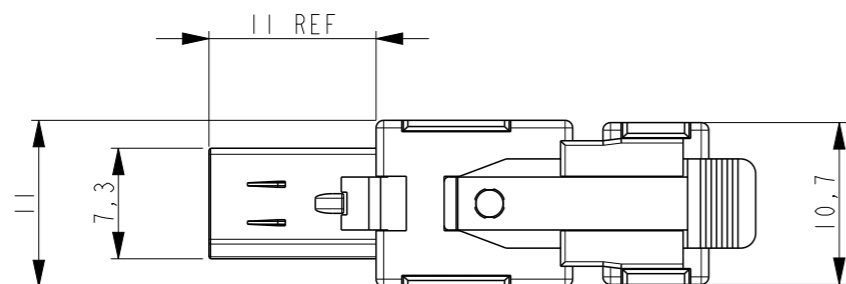

D-SHAPE TYPE 1

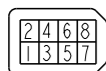

CIRCUIT NO.

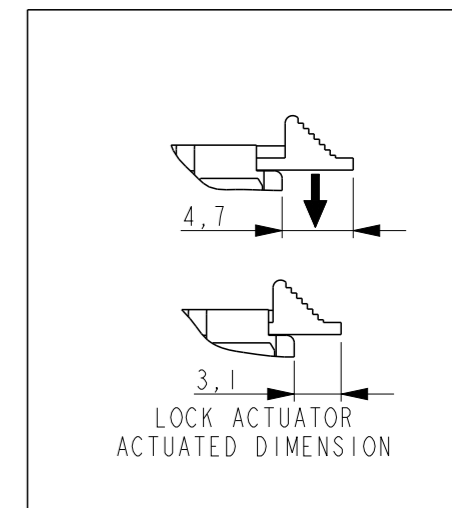
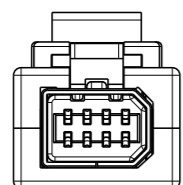

P/N 1-2069250-2 AS SHOWN:

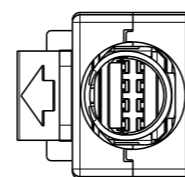
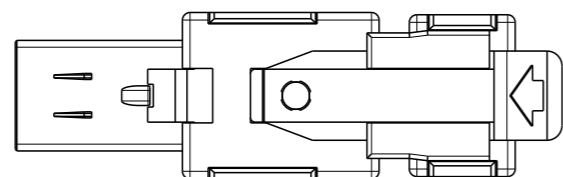

D-SHAPE TYPE 2

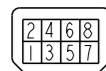

CIRCUIT NO.

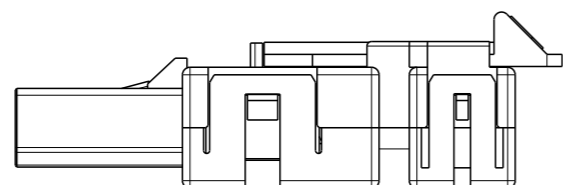
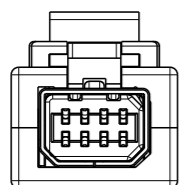

1. APPLICABLE CABLE RECOMMENDED AWG30-26 X 8C
MAX AWG22 x4C
OVERALL DIAMETER 6.7MAX.
 2. DATE CODE IS DESCRIBED ON THE BUNDLED CUSTOMER DRAWING.
 3. THE PRODUCT OF THIS DRAWING NO. IS PACKED INDIVIDUALLY
IN PACKAGE OF EXCLUSIVE USE.
BEFORE THIS KIT IS PACKED TO TRAY, ITEM 6 SHOULD BE ASSEMBLED TO
ITEM 7.
 4. MATERIALS:
 - HEAT SHRINKABLE TUBE: CROSS-LINKED POLYOLEFIN
 - COPPER FOIL TAPE: ELECTROLYSIS COPPER FOIL, ACRYLIC ADHESIVE MATERIAL
 - BOTTOM COVER: POLYESTER OF GLASS FILLED THERMO PLASTIC(UL94V-0)
 - TOP COVER,EJECTOR EXT VER.: POLYESTER OF GLASS FILLED THERMO PLASTIC(UL94V-0)
 - PLUG LOCK ACTUATOR: POLYESTER OF GLASS FILLED THERMO PLASTIC(UL94V-0)
 - LOCK EJECTOR EXT VER: POLYESTER OF GLASS FILLED THERMO PLASTIC(UL94V-0)
 - PLUG HSG COVER: POLYESTER OF GLASS FILLED THERMO PLASTIC(UL94V-0)
 - PLUG HSG SUB ASSY:
 - HSG:POLY-AMID OF GLASS FILLED THERMO PLASTIC(UL94V-0)
 - CONTACT PLATING:COPPER ALLOY
- UNDER ALL SURFACE: Ni PLATING 1.27µm. MIN.
TOP CONTACT AREA: Au PLATING 0.5µm. MIN.
SOLDERING AREA: Au FLASH

THIS DRAWING IS A CONTROLLED DOCUMENT.

DIMENSIONS: mm	TOLERANCES UNLESS OTHERWISE SPECIFIED: ±0.3
	0 PLC ±
	1 PLC ±
	2 PLC ±
	3 PLC ±0,013
	4 PLC ±
	ANGLES ±
MATERIAL SEE TABLE 表参照	FINISH SEE TABLE 表参照

DWN	S. INOMATA	03DEC2008
CHK	A. OOISHI	03DEC2008
APVD	A. OOISHI	03DEC2008
PRODUCT SPEC	108-78405	
APPLICATION SPEC	114-5431	
WEIGHT	-	
Customer Drawing		



NAME INDUSTRIAL MINI I/O PLUG CONN. KIT TYPE 1 and 2, SOLDER LOCK EJECTOR EXTEND VERSION			
SIZE	CAGE CODE	DRAWING NO	RESTRICTED TO
A3	00779	C-2069250	-
SCALE		SHEET	REV
2:1		1 OF 2	D

P	LTR	DESCRIPTION	DATE	DWN	APVD
-	-	SEE SHEET 1	-	-	-

D-SHAPE TYPE 1

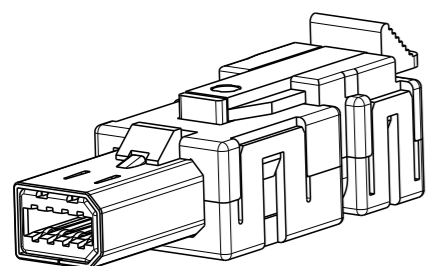

D-SHAPE TYPE 2

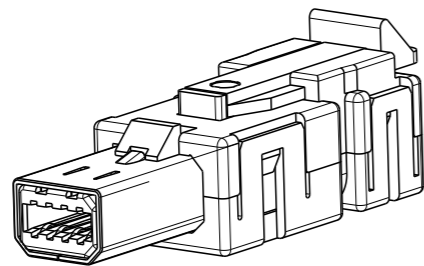

ACTUATOR TYPE A1 or A2

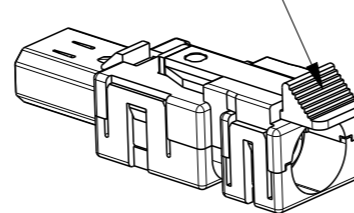

SCALE 3:2

ACTUATOR TYPE B

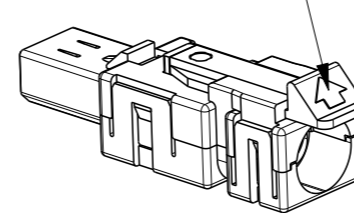

SCALE 3:2

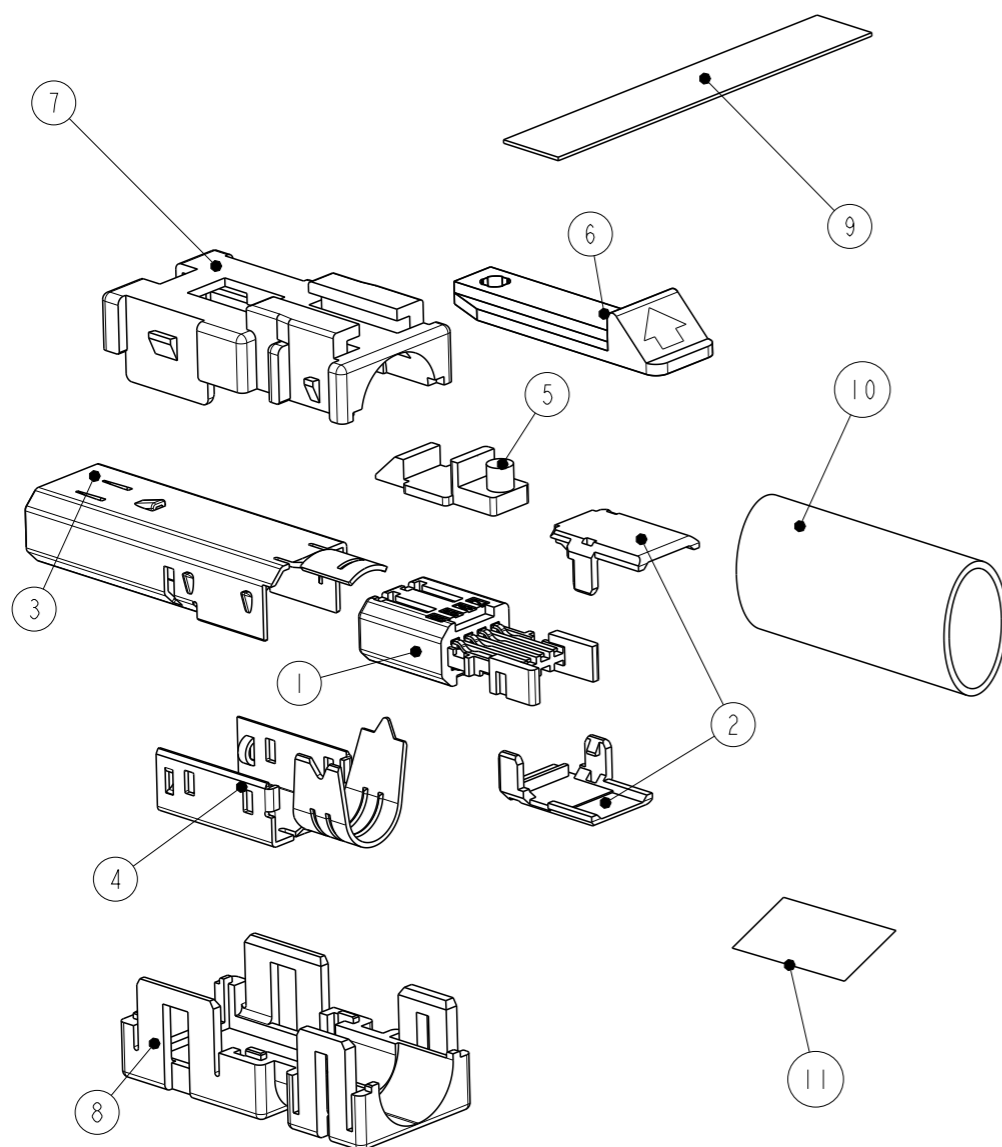

INACTIVE	INACTIVE	INACTIVE	INACTIVE	INACTIVE	INACTIVE		ACTUATOR TYPE	COLOR		
TYPE 2	TYPE 1	TYPE 2	TYPE 1	TYPE 2	TYPE 1					
						N/A			CUSTOMER DRAWING NO. 2069250 PRINTED ON A4 SIZE	11
						2040712-1			HEAT SHRINKABLE TUBE	10
						2040711-1			COPPER FOIL TAPE	9
						1981091-1		BLACK	BOTTOM COVER	8
						2069251-1		BLACK	TOP COVER, EJECTOR EXTENSION VERSION	7
-	-	-	-	-	-	2-2069253-2	B	ORANGE	PLUG LOCK ACTUATOR	6
		-	-	-	-	2-2069253-1	A2	ORANGE		
-	-			-	-	1-2069253-2	B	WHITE		
-	-	-	-	-	-	1-2069253-1	A2	WHITE		
-	-	-	-			2069253-1	A1	BLACK		
						2069252-1		BLACK		
						1981093-1			BOTTOM SHELL	4
	-		-		-	1-1981092-1			TOP SHELL	3
-		-		-		1981092-1				
2	2	2	2	2	2	1981088-1			PLUG HOUSING COVER	2
	-		-		-	1-1981094-1			PLUG HOUSING SUB ASSY	1
-		-		-		1981094-1				
1-2069250-3	2069250-3	1-2069250-2	2069250-2	1-2069250-1	2069250-1	PART NO.			PART NAME	ITEM NO.

THIS DRAWING IS A CONTROLLED DOCUMENT.

DWN 03DEC2008

S. INOMATA

CHK 03DEC2008

A. OOISHI

APVD 03DEC2008

A. OOISHI

PRODUCT SPEC

108-78405

APPLICATION SPEC

114-5431

WEIGHT -

Customer Drawing



NAME INDUSTRIAL MINI I/O
PLUG CONN. KIT TYPE 1 and 2,
SOLDER LOCK EJECTOR EXTEND VERSION

SIZE	CAGE CODE	DRAWING NO	RESTRICTED TO
A3	00779	C-2069250	-

DIMENSIONS:
mm

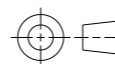

TOLERANCES UNLESS OTHERWISE SPECIFIED:

0-PLC	±
1-PLC	±
2-PLC	±
3-PLC	±0,013
4-PLC	±
ANGLES	±

MATERIAL

FINISH

SCALE 2:1 SHEET 2 OF 2 REV D