

THIS DRAWING IS UNPUBLISHED. RELEASED FOR PUBLICATION
 © COPYRIGHT - By - ALL RIGHTS RESERVED.

LOC	DIST	REVISIONS					
		P	LTR	DESCRIPTION	DATE	DWN	APVD
CM	00	B3		REVISED PER ECR-17-013148	29MAY2018	BDA	SG

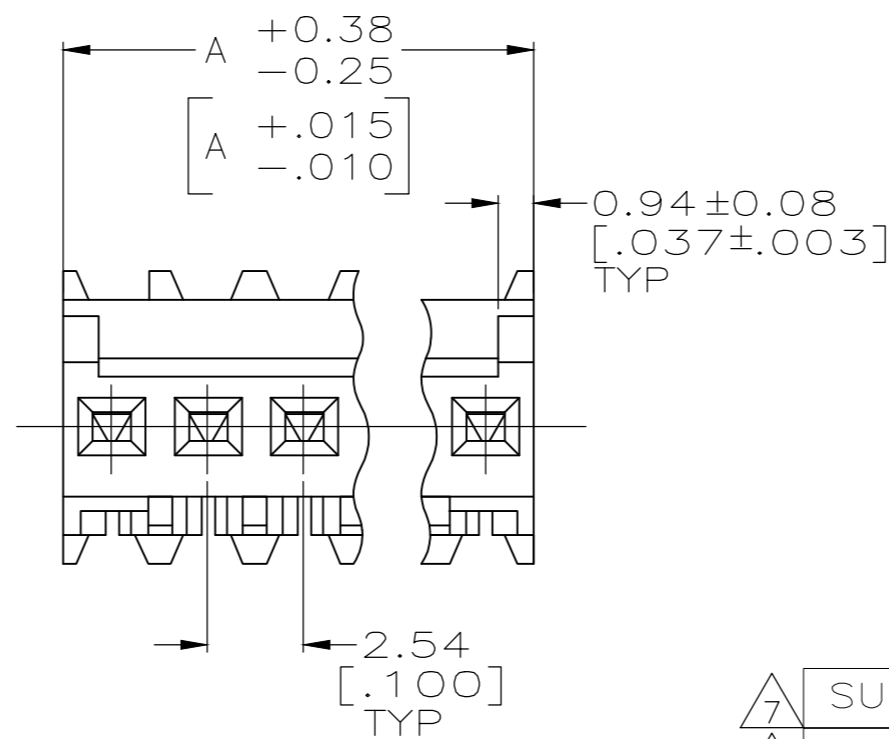
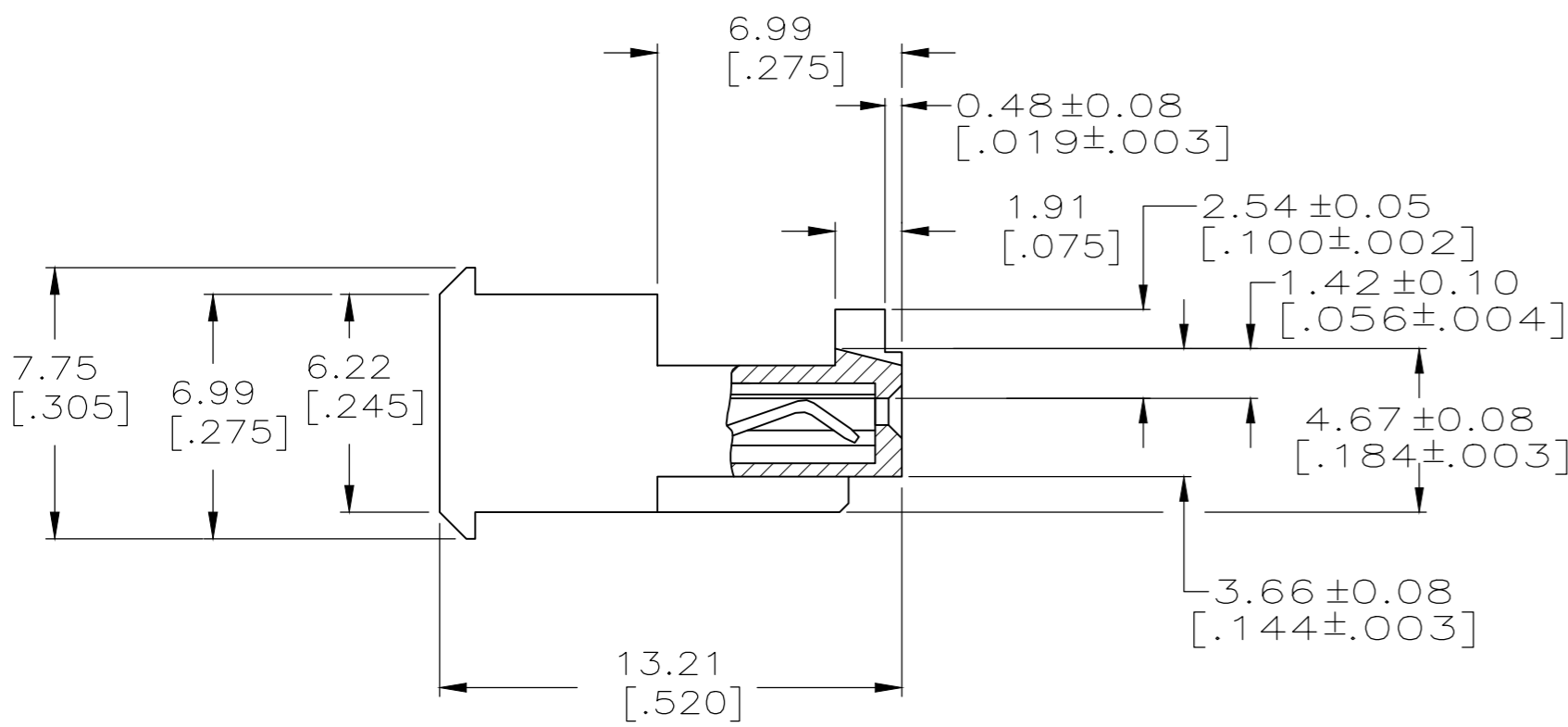
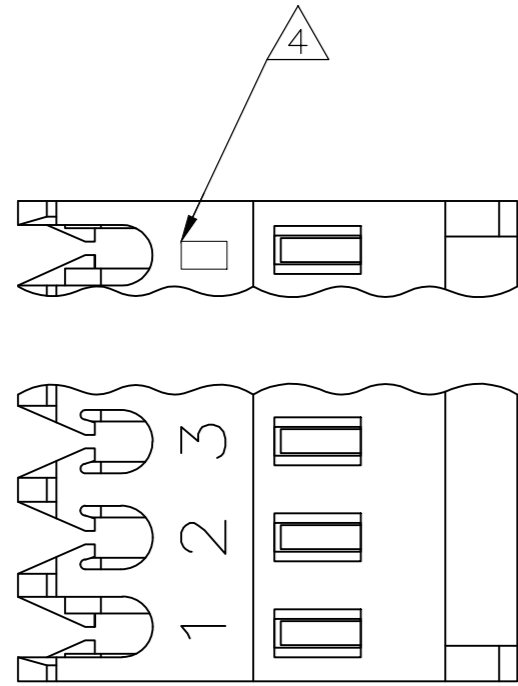

LEAD	LEAD		
	38.10 [1.500]	15	4-644578-5
	35.56 [1.400]	14	4-644578-4
	33.02 [1.300]	13	4-644578-3
	30.48 [1.200]	12	4-644578-2
	27.94 [1.100]	11	4-644578-1
	25.40 [1.000]	10	4-644578-0
	22.86 [.900]	9	3-644578-9
	20.32 [.800]	8	3-644578-8
	17.78 [.700]	7	3-644578-7
	15.24 [.600]	6	3-644578-6
12.70 [.500]	5	3-644578-5	
10.16 [.400]	4	3-644578-4	
7.62 [.300]	3	3-644578-3	
5.08 [.200]	2	3-644578-2	

MATERIAL: CONNECTOR-NYLON UL94V-0 (BLACK)
 CONTACTS-0.30 [.012] THICK COPPER ALLOY
 BRIGHT TIN-LEAD 0.00203 [.000080] MIN THICK FOR CONTACTS
 644578-2 THRU 1-644578-5
 MATTE WHISKER MITIGATED TIN PLATE 0.00203 [.000080] MIN THICK
 OVER 0.00076 [.000030] MIN THICK NICKEL FOR CONTACTS
 3-644578-2 THRU 4-644578-5

2. CONTACTS ACCEPT 22 AWG WIRE WITH 1.52 [.060] MAX INSULATION DIAMETER.

3. CONTACTS MUST ACCEPT 0.64 ± 0.03 [.025 ± .001] SQUARE POST AND REMAIN LOCKED IN POSITION.

4. IDENTIFICATION NUMBER FOR LAST CIRCUIT MAY NOT APPEAR ON ALL ASSEMBLIES.

5. DIMENSIONS IN BRACKETS ARE IN INCHES.

6. HOUSING FEATURES ARE: FEED THRU WITH LOCKING RAMP AND WITH POLARIZING TAB.

7. OBSOLETE PARTS: OBSOLETE CIS STREAMLINING PER D.RENAUD/D.SINISI

8. OBSOLETE PARTS

7	SUPERSEDED
7	SUPERSEDED
8	SUPERSEDED
7 SUPERSEDED	
8	SUPERSEDED
7	SUPERSEDED
OBSOLETE	

CONTAINS LEAD	CONTAINS LEAD		
	38.10 [1.500]	15	4-644578-5
	35.56 [1.400]	14	4-644578-4
	33.02 [1.300]	13	4-644578-3
	30.48 [1.200]	12	4-644578-2
	27.94 [1.100]	11	4-644578-1
	25.40 [1.000]	10	4-644578-0
	22.86 [.900]	9	644578-9
	20.32 [.800]	8	644578-8
	17.78 [.700]	7	644578-7
	15.24 [.600]	6	644578-6
12.70 [.500]	5	644578-5	
10.16 [.400]	4	644578-4	
7.62 [.300]	3	644578-3	
5.08 [.200]	2	644578-2	
DIM A		NO.OF POSN	ASSEMBLY

THIS DRAWING IS A CONTROLLED DOCUMENT.		DWN S. HOOVER 03-DEC-2004		
DIMENSIONS: mm [INCHES]		CHK D. BOSSI 03-DEC-2004		
TOLERANCES UNLESS OTHERWISE SPECIFIED:		APVD D. BOSSI 03-DEC-2004	NAME	
0 PLC ±		PRODUCT SPEC		MTA .100 CONNECTOR ASSEMBLY 22 AWG, UL94V-0, SPECIAL
1 PLC ±		APPLICATION SPEC		
2 PLC ± 0.13 [.005]		108-1050		SIZE CAGE CODE DRAWING NO RESTRICTED TO
3 PLC ±		114-1019		
4 PLC ±		WEIGHT		A2 00779 C=644578
MATERIAL		FINISH		CUSTOMER DRAWING
1		4		SCALE 5:1 SHEET 1 OF 1 REV B3