

THIS DRAWING IS UNPUBLISHED.

RELEASED FOR PUBLICATION MAR , 2006.

© COPYRIGHT 2006 By -

ALL RIGHTS RESERVED.

REVISIONS

P	LTR	DESCRIPTION	DATE	DWN	APVD
	C1	REVISED PER ECR-19-015681	09OCT2019	RZ	RS

NOTES

- ① 100 TRAY PACK IN ACCORDANCE WITH AMP SPEC 107-3275
- ② SINGLE PACK IN ACCORDANCE WITH AMP SPEC 107-3275
- ③ Au PLATING
- ④ Ni PLATING
- 5. FOR TECHNICAL DATA REFER TO YOUR LOCAL TE CONNECTIVITY SALES OFFICE
- 6. ALL DIMENSIONS ARE NOMINAL FOR REFERENCE ONLY UNLESS OTHERWISE STATED
- 7. DURABILITY: 50 CYCLES

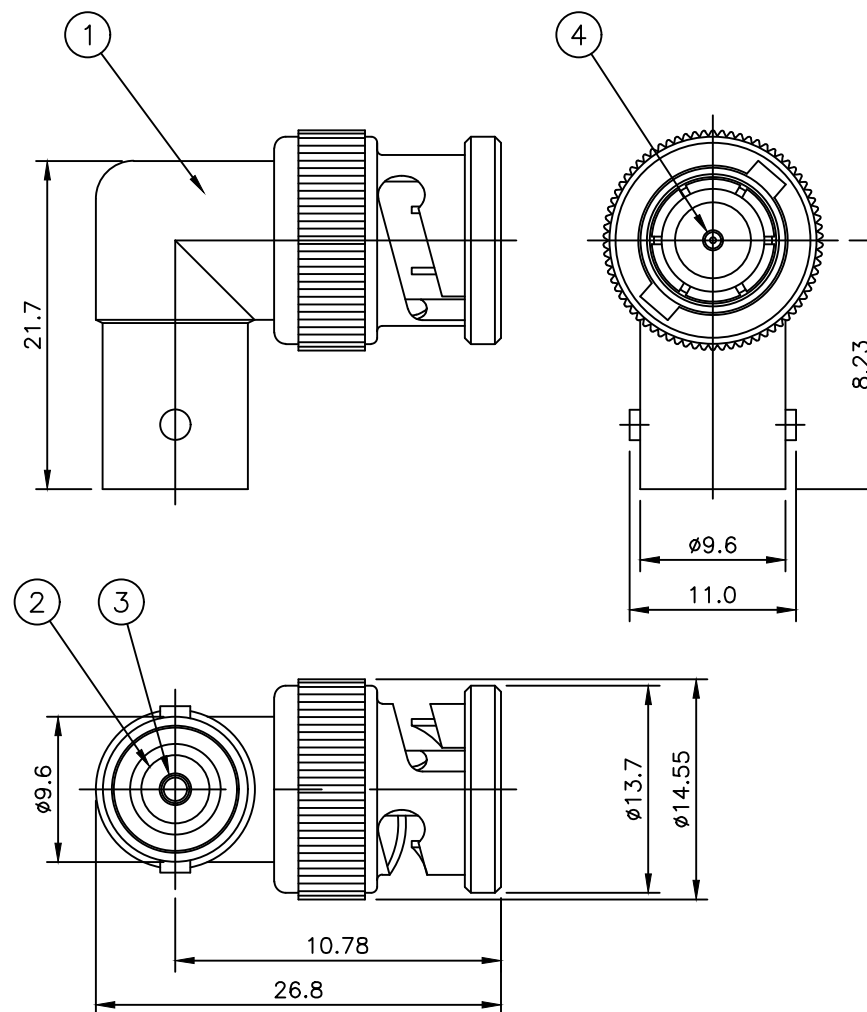

QTY	PLC	DESCRIPTION	MATERIAL	FINISH	ITEM
1	1	MALE CONTACT	BRASS	③	4
1	1	FEMALE CONTACT	PHOS BRONZE	③	3
1	1	INSULATOR	PE-606		2
1	1	BODY	ZINC ALLOY	④	1
5--1	5--0	MATERIAL			
		DESCRIPTION			
QUANTITY PER ASSY					PARTS LIST

THIS DRAWING IS A CONTROLLED DOCUMENT.		DWN RITA ZUO 10 Mar 09	TE Connectivity BNC ELBOW ADAPTOR PLUG - JACK 50 OHMS											
DIMENSIONS: mm		CHK ANSON MA 10 Mar 09												
TOLERANCES UNLESS OTHERWISE SPECIFIED:		APVD BOB ZHAO 10 Mar 09												
<table border="1"> <tr><td>0 PLC</td><td>± 0.5</td></tr> <tr><td>1 PLC</td><td>± 0.3</td></tr> <tr><td>2 PLC</td><td>± 0.2</td></tr> <tr><td>3 PLC</td><td>± -</td></tr> <tr><td>4 PLC</td><td>± -</td></tr> <tr><td>ANGLES</td><td>± -</td></tr> </table>		0 PLC				± 0.5	1 PLC	± 0.3	2 PLC	± 0.2	3 PLC	± -	4 PLC	± -
0 PLC	± 0.5													
1 PLC	± 0.3													
2 PLC	± 0.2													
3 PLC	± -													
4 PLC	± -													
ANGLES	± -													
MATERIAL SEE TABLE		FINISH -	PRODUCT SPEC 108-112000	SIZE	RESTRICTED TO									
			APPLICATION SPEC -	CAGE CODE A300779										
			WEIGHT 0.000000	DRAWING NO C-1634526										
			CUSTOMER DRAWING	SCALE NTS	SHEET 1 OF 1									
				REV C1										