

Cost Effective, Reduced Depth, Shielded Line Filter

SRB Series



UL Recognized
CSA Certified
VDE Approved



SRB Series

With one of the smallest depths available on the market today, the SRB Series features a complete shield design with various capacitance values. This unique combination offers varying levels of common mode performance which minimizes conducted emissions and may reduce radiated emissions.

The SRB Series is rated up to 15 Amps, 250 VAC.* All configurations are available unfiltered or with one of eight different capacitor values to address different performance needs. The SRB Series features a multitude of installation and termination options including flange or snap-in mounting, and quick connect terminal, wire leaded, and pin termination options. This product is ideally suited for power supplies or other applications which require a minimum depth low cost solution.

*10 Amps VDE

Electrical Schematic

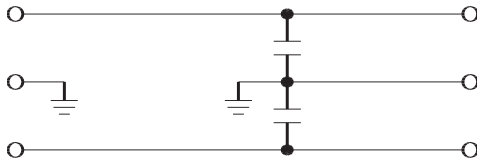

Capacitor Options

Capacitor Value Identifier	Capacitor Value
Q	33pF
R	100pF
S	220pF
T	330pF
W	470pF
X	1000pF
Y*	2200pF
Z*	3300pF

*Not available in SRB8 Styles.

PCB Layout

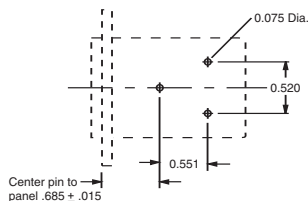

Specifications

Maximum leakage current, each line-to-ground

Capacitor Identifier/Value	@120 VAC 60 Hz	@250 VAC 50Hz
Blank/None	2uA	5uA
Q / 33pF	2.1uA	3.65uA
R / 100pF	9.6uA	16.6uA
S / 220pF	19.2uA	33.2uA
T / 330pF	24.0uA	41.5uA
W / 470pF	0.04mA	0.07mA
X / 1000pF	0.07mA	0.13mA
Y / 2200pF	0.16mA	0.28mA
Z / 3300pF	0.24mA	0.42mA

Hipot rating (one minute):

line-to-ground	1500 VDC
line-to-line	1450 VDC

Operating frequency:

50/60 Hz

Rated voltage (max.):

250 VAC

Minimum insertion loss in dB:

Line-to-ground in 50 ohm circuit

Capacitor ID	Frequency Mhz					
	1	5	10	50	100	300
Q	-	-	-	-	-	20
R	-	-	-	3	6	22
S	-	-	1	6	17	19
T	-	-	2	13	13	19
W	-	2	4	18	13	20
X	-	5	9	25	10	17
Y	1	10	15	20	8	22
Z	2	14	18	17	7	15

Case Styles

SRB1

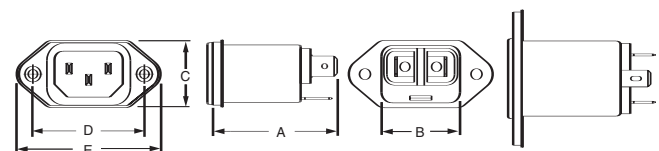

Cost Effective, Reduced Depth, Shielded Line Filter (Continued)

SRB Series

Case Styles (continued)

SRB2

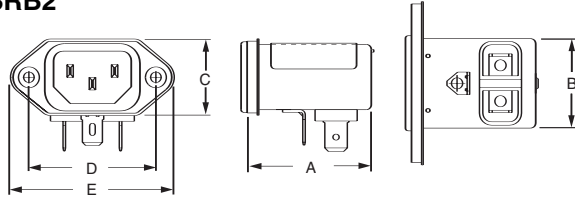

SRBP

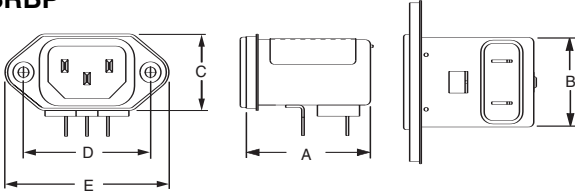

SRB8

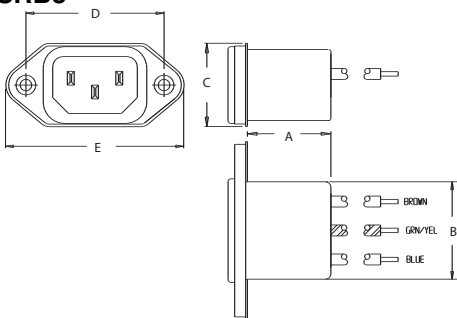

SRBS1

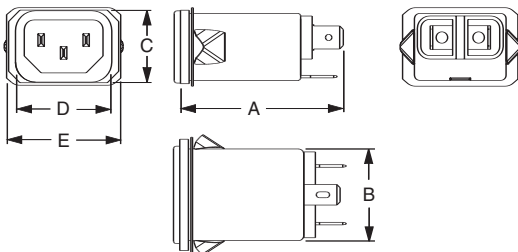

SRBS8

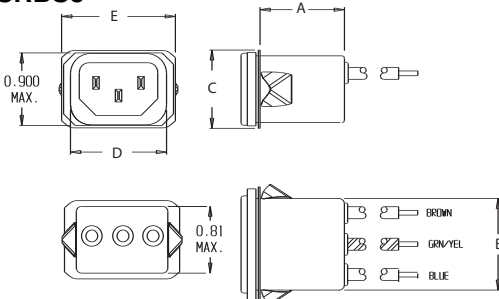

Typical dimensions:

Terminals: .250 [6.35] (3) Holes: .07 [1.8] Dia. (2) Slot: .07 x .16 [1.8 x 4.1]
 Mounting holes: .132 [3.35] Dia. (2) w/.236 Dia. x 90° countersunk for a #4 flathead screw
 Style 8 wire leads: 4.0 [101.6] min. 1-15A, 18AWG

Case Dimensions

Part No.	A (max)	B (max)	C (max)	D $\pm .015$ $\pm .380$	E (max)
15SRB1	1.75 44.45	1.13 28.70	0.96 24.38	1.580 40.00	2.04 51.76
15SRB2	1.54 39.12	1.13 28.70	0.96 24.38	1.58 40.00	2.04 51.76
15SRBP	1.54 39.12	1.13 28.70	0.96 24.38	1.58 40.00	2.04 51.76
15SRB8	.94 23.82	1.13 28.70	0.96 24.38	1.58 40.00	2.04 51.76
15SRBS1	1.75 44.45	1.13 28.70	0.96 24.38	1.19 30.10	1.41 35.81
15SRBS8	1.12 28.45	1.13 28.70	0.96 24.38	1.19 30.10	1.41 35.81

Part Numbers

15SRB1	15SRB1-S	15SRB1-X
15SRBS1	15SRBS1-S	15SRBS1-X
15SRB2	15SRB2-S	15SRB2-X
15SRB8	15SRB8-S	15SRB8-X
15SRBS8	15SRBS8-S	15SRBS8-X
15SRBP	15SRBP-S	15SRBP-X
15SRB1-Q	15SRB1-T	15SRB1-Y
15SRBS1-Q	15SRBS1-T	15SRBS1-Y
15SRB2-Q	15SRB2-T	15SRB2-Y
15SRB8-Q	15SRB8-T	15SRBP-Y
15SRBS8-Q	15SRBS8-T	15SRB1-Z
15SRBP-Q	15SRBP-T	15SRBS1-Z
15SRB1-R	15SRB1-W	15SRB2-Z
15SRBS1-R	15SRBS1-W	15SRBP-Z
15SRB2-R	15SRB2-W	
15SRB8-R	15SRB8-W	
15SRBS8-R	15SRBS8-W	
15SRBP-R	15SRBP-W	

Recommended Panel Cutouts

SRBS

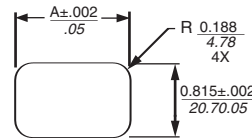

Panel Thickness A Dim. ± .002
 .031-.052 [.79-1.32] 1.260 [32.00]
 0.046-0.068 [1.17-1.73] 1.350 [34.29]

SRB

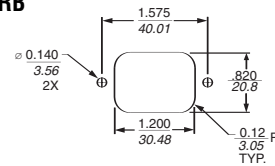

Panel Cutout (front mount)

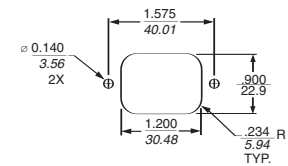

Panel Cutout (back mount)

Notes:

Tolerance ± .005 [0.13]
 Panel Thickness .031-.047 [.78-1.19]
 SRB1 and SRB8 styles allow for front or back mounting
 SRB2 and SRBP allow for back mounting only