

# LXV Series

- Low impedance
- Endurance with ripple current : 2,000 to 5,000 hours at 105°C
- Solvent resistant type (see PRECAUTIONS AND GUIDELINES)
- RoHS Compliant

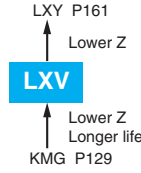

## SPECIFICATIONS

Items	Characteristics
Category	
Temperature Range	-55 to +105°C
Rated Voltage Range	6.3 to 100V <sub>dc</sub>
Capacitance Tolerance	±20% (M) (at 20°C, 120Hz)
Leakage Current	I=0.01CV or 3μA, whichever is greater. Where, I : Max. leakage current (μA), C : Nominal capacitance (μF), V : Rated voltage (V) (at 20°C after 2 minutes)
Dissipation Factor (tanδ)	Rated voltage (V <sub>dc</sub> )
	tanδ (Max.)
Low Temperature Characteristics	Capacitance change ΔC (-55°C/+20°C) 0.7min.
	Max. impedance ratio (-55°C/+20°C) 3max.(6.3V <sub>dc</sub> : 4max.) (at 120Hz)
Endurance	The following specifications shall be satisfied when the capacitors are restored to 20°C after subjected to DC voltage with the rated ripple current is applied (the peak voltage shall not exceed the rated voltage) for the specified period of time at 105°C.
	Time
	Capacitance change
	D.F. (tanδ)
	Leakage current
Shelf Life	The following specifications shall be satisfied when the capacitors are restored to 20°C after exposing them for 1,000 hours at 105°C without voltage applied. Before the measurement, the capacitor shall be preconditioned by applying voltage according to Item 4.1 of JIS C 5101-4.
	Capacitance change
	D.F. (tanδ)
	Leakage current

## DIMENSIONS [mm]

- Terminal Code : E

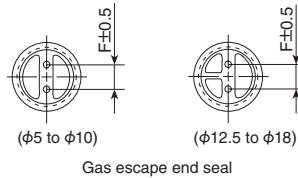
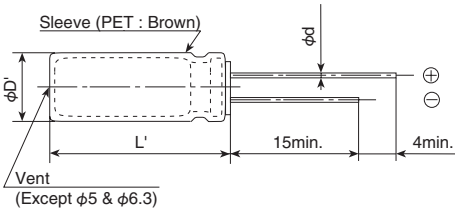

φD	5	6.3	8	10	12.5	16	18
φd	0.5	0.5	0.6	0.6	0.6	0.8	0.8
F	2.0	2.5	3.5	5.0	5.0	7.5	7.5
φD'	φD+0.5max.						
L'	L+1.5max.						

## PART NUMBERING SYSTEM

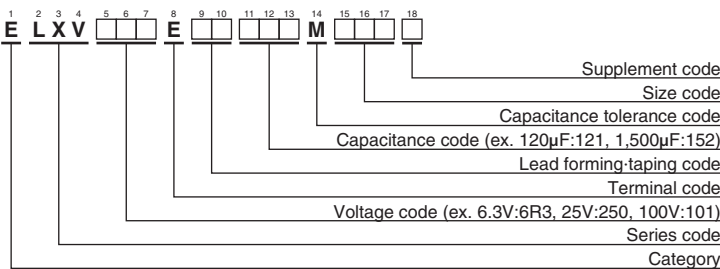

Please refer to "Product code guide (radial lead type)"



◆STANDARD RATINGS

WV (Vdc)	Cap (μF)	Case size φD×L(mm)	Impedance (Ωmax/100kHz)		Rated ripple current (mA <sub>rms</sub> /105°C, 100kHz)	Part No.	WV (Vdc)	Cap (μF)	Case size φD×L(mm)	Impedance (Ωmax/100kHz)		Rated ripple current (mA <sub>rms</sub> /105°C, 100kHz)	Part No.																																																																																																																																																																																																																																																																																																																																																																																																																																																																																																																																																																																																																							
			20°C	-10°C						20°C	-10°C																																																																																																																																																																																																																																																																																																																																																																																																																																																																																																																																																																																																																									
			50V Section <table border="1"> <tr><td>82</td><td>8 × 15</td><td>0.24</td><td>0.72</td><td>505</td><td>ELXV500E□□820MH15D</td></tr> <tr><td>82</td><td>10 × 12.5</td><td>0.16</td><td>0.40</td><td>530</td><td>ELXV500E□□820MJC5S</td></tr> <tr><td>120</td><td>8 × 20</td><td>0.18</td><td>0.52</td><td>610</td><td>ELXV500E□□121MH20D</td></tr> <tr><td>120</td><td>10 × 16</td><td>0.12</td><td>0.30</td><td>755</td><td>ELXV500E□□121MJ16S</td></tr> <tr><td>180</td><td>10 × 20</td><td>0.088</td><td>0.22</td><td>945</td><td>ELXV500E□□181MJ20S</td></tr> <tr><td>220</td><td>10 × 25</td><td>0.068</td><td>0.17</td><td>1,150</td><td>ELXV500E□□221MJ25S</td></tr> <tr><td>330</td><td>10 × 30</td><td>0.059</td><td>0.15</td><td>1,260</td><td>ELXV500E□□331MJ30S</td></tr> <tr><td>330</td><td>12.5 × 20</td><td>0.059</td><td>0.15</td><td>1,190</td><td>ELXV500E□□331MK20S</td></tr> <tr><td>470</td><td>12.5 × 25</td><td>0.045</td><td>0.11</td><td>1,500</td><td>ELXV500E□□471MK25S</td></tr> <tr><td>560</td><td>12.5 × 30</td><td>0.039</td><td>0.098</td><td>1,720</td><td>ELXV500E□□561MK30S</td></tr> <tr><td>680</td><td>12.5 × 35</td><td>0.033</td><td>0.083</td><td>1,900</td><td>ELXV500E□□681MK35S</td></tr> <tr><td>680</td><td>16 × 20</td><td>0.043</td><td>0.11</td><td>1,500</td><td>ELXV500E□□681ML20S</td></tr> <tr><td>820</td><td>12.5 × 40</td><td>0.029</td><td>0.073</td><td>2,120</td><td>ELXV500E□□821MK40S</td></tr> <tr><td>820</td><td>16 × 25</td><td>0.033</td><td>0.083</td><td>1,880</td><td>ELXV500E□□821ML25S</td></tr> <tr><td>820</td><td>18 × 20</td><td>0.039</td><td>0.098</td><td>1,660</td><td>ELXV500E□□821MM20S</td></tr> <tr><td>1,000</td><td>16 × 30</td><td>0.029</td><td>0.073</td><td>2,150</td><td>ELXV500E□□102ML30S</td></tr> <tr><td>1,000</td><td>18 × 25</td><td>0.030</td><td>0.075</td><td>2,020</td><td>ELXV500E□□102MM25S</td></tr> <tr><td>1,200</td><td>16 × 35</td><td>0.025</td><td>0.063</td><td>2,320</td><td>ELXV500E□□122ML35S</td></tr> <tr><td>1,500</td><td>16 × 40</td><td>0.021</td><td>0.053</td><td>2,650</td><td>ELXV500E□□152ML40S</td></tr> <tr><td>1,500</td><td>18 × 30</td><td>0.026</td><td>0.065</td><td>2,340</td><td>ELXV500E□□152MM30S</td></tr> <tr><td>1,800</td><td>18 × 35</td><td>0.023</td><td>0.058</td><td>2,620</td><td>ELXV500E□□182MM35S</td></tr> <tr><td>2,200</td><td>18 × 40</td><td>0.020</td><td>0.050</td><td>2,790</td><td>ELXV500E□□222MM40S</td></tr> </table> 63V Section <table border="1"> <tr><td>12</td><td>5 × 11.5</td><td>1.9</td><td>4.8</td><td>100</td><td>ELXV630E□□120MEB5D</td></tr> <tr><td>27</td><td>6.3 × 11.5</td><td>1.1</td><td>2.8</td><td>160</td><td>ELXV630E□□270MFB5D</td></tr> <tr><td>39</td><td>6.3 × 15</td><td>0.62</td><td>1.6</td><td>230</td><td>ELXV630E□□390MF15D</td></tr> <tr><td>47</td><td>8 × 12</td><td>0.49</td><td>1.3</td><td>275</td><td>ELXV630E□□470MH12D</td></tr> <tr><td>56</td><td>10 × 12.5</td><td>0.27</td><td>0.68</td><td>420</td><td>ELXV630E□□560MJC5S</td></tr> <tr><td>68</td><td>8 × 15</td><td>0.34</td><td>0.85</td><td>360</td><td>ELXV630E□□680MH15D</td></tr> <tr><td>68</td><td>10 × 16</td><td>0.21</td><td>0.53</td><td>523</td><td>ELXV630E□□680MJ16S</td></tr> <tr><td>82</td><td>8 × 20</td><td>0.21</td><td>0.53</td><td>500</td><td>ELXV630E□□820MH20D</td></tr> <tr><td>120</td><td>10 × 20</td><td>0.16</td><td>0.40</td><td>650</td><td>ELXV630E□□121MJ20S</td></tr> <tr><td>150</td><td>10 × 25</td><td>0.13</td><td>0.33</td><td>780</td><td>ELXV630E□□151MJ25S</td></tr> <tr><td>180</td><td>10 × 30</td><td>0.10</td><td>0.25</td><td>960</td><td>ELXV630E□□181MJ30S</td></tr> <tr><td>220</td><td>12.5 × 20</td><td>0.11</td><td>0.28</td><td>870</td><td>ELXV630E□□221MK20S</td></tr> <tr><td>270</td><td>12.5 × 25</td><td>0.074</td><td>0.19</td><td>1,150</td><td>ELXV630E□□271MK25S</td></tr> <tr><td>390</td><td>12.5 × 30</td><td>0.068</td><td>0.17</td><td>1,280</td><td>ELXV630E□□391MK30S</td></tr> <tr><td>390</td><td>16 × 20</td><td>0.085</td><td>0.22</td><td>1,100</td><td>ELXV630E□□391ML20S</td></tr> <tr><td>470</td><td>12.5 × 35</td><td>0.063</td><td>0.16</td><td>1,390</td><td>ELXV630E□□471MK35S</td></tr> <tr><td>470</td><td>16 × 25</td><td>0.055</td><td>0.14</td><td>1,480</td><td>ELXV630E□□471ML25S</td></tr> <tr><td>560</td><td>12.5 × 40</td><td>0.051</td><td>0.13</td><td>1,530</td><td>ELXV630E□□561MK40S</td></tr> <tr><td>560</td><td>18 × 20</td><td>0.085</td><td>0.22</td><td>1,170</td><td>ELXV630E□□561MM20S</td></tr> <tr><td>680</td><td>16 × 30</td><td>0.046</td><td>0.12</td><td>1,720</td><td>ELXV630E□□681ML30S</td></tr> <tr><td>680</td><td>18 × 25</td><td>0.055</td><td>0.14</td><td>1,520</td><td>ELXV630E□□681MM25S</td></tr> <tr><td>820</td><td>16 × 35</td><td>0.040</td><td>0.10</td><td>1,910</td><td>ELXV630E□□821ML35S</td></tr> <tr><td>820</td><td>18 × 30</td><td>0.046</td><td>0.12</td><td>1,770</td><td>ELXV630E□□821MM30S</td></tr> <tr><td>1,000</td><td>16 × 40</td><td>0.036</td><td>0.09</td><td>2,070</td><td>ELXV630E□□102ML40S</td></tr> <tr><td>1,000</td><td>18 × 35</td><td>0.040</td><td>0.10</td><td>1,970</td><td>ELXV630E□□102MM35S</td></tr> <tr><td>1,200</td><td>18 × 40</td><td>0.036</td><td>0.09</td><td>2,130</td><td>ELXV630E□□122MM40S</td></tr> </table> 80V Section <table border="1"> <tr><td>8.2</td><td>5 × 11.5</td><td>1.9</td><td>5.1</td><td>100</td><td>ELXV800E□□8R2MEB5D</td></tr> <tr><td>18</td><td>6.3 × 11.5</td><td>1.1</td><td>3.0</td><td>150</td><td>ELXV800E□□180MFB5D</td></tr> </table> 80V Section (continued) <table border="1"> <tr><td>27</td><td>6.3 × 15</td><td>0.62</td><td>1.7</td><td>220</td><td>ELXV800E□□270MF15D</td></tr> <tr><td>33</td><td>8 × 12</td><td>0.53</td><td>1.5</td><td>275</td><td>ELXV800E□□330MH12D</td></tr> <tr><td>39</td><td>10 × 12.5</td><td>0.47</td><td>1.3</td><td>380</td><td>ELXV800E□□390MJC5S</td></tr> <tr><td>47</td><td>8 × 15</td><td>0.35</td><td>0.97</td><td>360</td><td>ELXV800E□□470MH15D</td></tr> <tr><td>56</td><td>8 × 20</td><td>0.27</td><td>0.74</td><td>490</td><td>ELXV800E□□560MH20D</td></tr> <tr><td>56</td><td>10 × 16</td><td>0.33</td><td>0.90</td><td>500</td><td>ELXV800E□□560MJ16S</td></tr> <tr><td>82</td><td>10 × 20</td><td>0.26</td><td>0.70</td><td>620</td><td>ELXV800E□□820MJ20S</td></tr> <tr><td>100</td><td>10 × 25</td><td>0.19</td><td>0.52</td><td>795</td><td>ELXV800E□□101MJ25S</td></tr> <tr><td>150</td><td>10 × 30</td><td>0.15</td><td>0.41</td><td>955</td><td>ELXV800E□□151MJ30S</td></tr> <tr><td>150</td><td>12.5 × 20</td><td>0.15</td><td>0.41</td><td>890</td><td>ELXV800E□□151MK20S</td></tr> <tr><td>180</td><td>12.5 × 25</td><td>0.11</td><td>0.30</td><td>1,040</td><td>ELXV800E□□181MK25S</td></tr> <tr><td>270</td><td>12.5 × 30</td><td>0.094</td><td>0.26</td><td>1,270</td><td>ELXV800E□□271MK30S</td></tr> <tr><td>270</td><td>16 × 20</td><td>0.11</td><td>0.30</td><td>1,240</td><td>ELXV800E□□271ML20S</td></tr> <tr><td>330</td><td>12.5 × 35</td><td>0.087</td><td>0.24</td><td>1,450</td><td>ELXV800E□□331MK35S</td></tr> <tr><td>330</td><td>16 × 25</td><td>0.081</td><td>0.22</td><td>1,440</td><td>ELXV800E□□331ML25S</td></tr> <tr><td>390</td><td>12.5 × 40</td><td>0.060</td><td>0.17</td><td>1,610</td><td>ELXV800E□□391MK40S</td></tr> <tr><td>390</td><td>18 × 20</td><td>0.085</td><td>0.23</td><td>1,450</td><td>ELXV800E□□391MM20S</td></tr> <tr><td>470</td><td>16 × 30</td><td>0.058</td><td>0.16</td><td>1,790</td><td>ELXV800E□□471ML30S</td></tr> <tr><td>470</td><td>18 × 25</td><td>0.070</td><td>0.19</td><td>1,650</td><td>ELXV800E□□471MM25S</td></tr> <tr><td>560</td><td>16 × 35</td><td>0.052</td><td>0.14</td><td>2,000</td><td>ELXV800E□□561ML35S</td></tr> <tr><td>680</td><td>16 × 40</td><td>0.041</td><td>0.11</td><td>2,200</td><td>ELXV800E□□681ML40S</td></tr> <tr><td>680</td><td>18 × 30</td><td>0.058</td><td>0.16</td><td>1,850</td><td>ELXV800E□□681MM30S</td></tr> <tr><td>820</td><td>18 × 35</td><td>0.052</td><td>0.14</td><td>1,990</td><td>ELXV800E□□821MM35S</td></tr> <tr><td>1,000</td><td>18 × 40</td><td>0.041</td><td>0.11</td><td>2,370</td><td>ELXV800E□□102MM40S</td></tr> </table> 100V Section <table border="1"> <tr><td>5.6</td><td>5 × 11.5</td><td>1.9</td><td>5.1</td><td>100</td><td>ELXV101E□□5R6MEB5D</td></tr> <tr><td>12</td><td>6.3 × 11.5</td><td>1.1</td><td>3.0</td><td>150</td><td>ELXV101E□□120MFB5D</td></tr> <tr><td>18</td><td>6.3 × 15</td><td>0.62</td><td>1.7</td><td>220</td><td>ELXV101E□□180MF15D</td></tr> <tr><td>22</td><td>8 × 12</td><td>0.53</td><td>1.5</td><td>275</td><td>ELXV101E□□220MH12D</td></tr> <tr><td>27</td><td>10 × 12.5</td><td>0.47</td><td>1.3</td><td>380</td><td>ELXV101E□□270MJC5S</td></tr> <tr><td>33</td><td>8 × 15</td><td>0.35</td><td>0.97</td><td>360</td><td>ELXV101E□□330MH15D</td></tr> <tr><td>33</td><td>10 × 16</td><td>0.33</td><td>0.90</td><td>500</td><td>ELXV101E□□330MJ16S</td></tr> <tr><td>39</td><td>8 × 20</td><td>0.27</td><td>0.74</td><td>490</td><td>ELXV101E□□390MH20D</td></tr> <tr><td>56</td><td>10 × 20</td><td>0.26</td><td>0.70</td><td>620</td><td>ELXV101E□□560MJ20S</td></tr> <tr><td>68</td><td>10 × 25</td><td>0.19</td><td>0.52</td><td>795</td><td>ELXV101E□□680MJ25S</td></tr> <tr><td>100</td><td>10 × 30</td><td>0.15</td><td>0.41</td><td>955</td><td>ELXV101E□□101MJ30S</td></tr> <tr><td>100</td><td>12.5 × 20</td><td>0.15</td><td>0.41</td><td>890</td><td>ELXV101E□□101MK20S</td></tr> <tr><td>120</td><td>12.5 × 25</td><td>0.11</td><td>0.30</td><td>1,040</td><td>ELXV101E□□121MK25S</td></tr> <tr><td>180</td><td>12.5 × 30</td><td>0.094</td><td>0.26</td><td>1,270</td><td>ELXV101E□□181MK30S</td></tr> <tr><td>180</td><td>16 × 20</td><td>0.11</td><td>0.30</td><td>1,240</td><td>ELXV101E□□181ML20S</td></tr> <tr><td>220</td><td>12.5 × 35</td><td>0.087</td><td>0.24</td><td>1,450</td><td>ELXV101E□□221MK35S</td></tr> <tr><td>220</td><td>16 × 25</td><td>0.081</td><td>0.22</td><td>1,440</td><td>ELXV101E□□221ML25S</td></tr> <tr><td>270</td><td>12.5 × 40</td><td>0.060</td><td>0.17</td><td>1,610</td><td>ELXV101E□□271MK40S</td></tr> <tr><td>270</td><td>18 × 20</td><td>0.085</td><td>0.23</td><td>1,450</td><td>ELXV101E□□271MM20S</td></tr> <tr><td>330</td><td>16 × 30</td><td>0.058</td><td>0.16</td><td>1,790</td><td>ELXV101E□□331ML30S</td></tr> <tr><td>330</td><td>18 × 25</td><td>0.070</td><td>0.19</td><td>1,650</td><td>ELXV101E□□331MM25S</td></tr> <tr><td>390</td><td>16 × 35</td><td>0.052</td><td>0.14</td><td>2,000</td><td>ELXV101E□□391ML35S</td></tr> <tr><td>390</td><td>18 × 30</td><td>0.058</td><td>0.16</td><td>1,850</td><td>ELXV101E□□391MM30S</td></tr> <tr><td>470</td><td>16 × 40</td><td>0.041</td><td>0.11</td><td>2,200</td><td>ELXV101E□□471ML40S</td></tr> <tr><td>560</td><td>18 × 35</td><td>0.052</td><td>0.14</td><td>1,990</td><td>ELXV101E□□561MM35S</td></tr> <tr><td>680</td><td>18 × 40</td><td>0.041</td><td>0.11</td><td>2,370</td><td>ELXV101E□□681MM40S</td></tr> </table>													82	8 × 15	0.24	0.72	505	ELXV500E□□820MH15D	82	10 × 12.5	0.16	0.40	530	ELXV500E□□820MJC5S	120	8 × 20	0.18	0.52	610	ELXV500E□□121MH20D	120	10 × 16	0.12	0.30	755	ELXV500E□□121MJ16S	180	10 × 20	0.088	0.22	945	ELXV500E□□181MJ20S	220	10 × 25	0.068	0.17	1,150	ELXV500E□□221MJ25S	330	10 × 30	0.059	0.15	1,260	ELXV500E□□331MJ30S	330	12.5 × 20	0.059	0.15	1,190	ELXV500E□□331MK20S	470	12.5 × 25	0.045	0.11	1,500	ELXV500E□□471MK25S	560	12.5 × 30	0.039	0.098	1,720	ELXV500E□□561MK30S	680	12.5 × 35	0.033	0.083	1,900	ELXV500E□□681MK35S	680	16 × 20	0.043	0.11	1,500	ELXV500E□□681ML20S	820	12.5 × 40	0.029	0.073	2,120	ELXV500E□□821MK40S	820	16 × 25	0.033	0.083	1,880	ELXV500E□□821ML25S	820	18 × 20	0.039	0.098	1,660	ELXV500E□□821MM20S	1,000	16 × 30	0.029	0.073	2,150	ELXV500E□□102ML30S	1,000	18 × 25	0.030	0.075	2,020	ELXV500E□□102MM25S	1,200	16 × 35	0.025	0.063	2,320	ELXV500E□□122ML35S	1,500	16 × 40	0.021	0.053	2,650	ELXV500E□□152ML40S	1,500	18 × 30	0.026	0.065	2,340	ELXV500E□□152MM30S	1,800	18 × 35	0.023	0.058	2,620	ELXV500E□□182MM35S	2,200	18 × 40	0.020	0.050	2,790	ELXV500E□□222MM40S	12	5 × 11.5	1.9	4.8	100	ELXV630E□□120MEB5D	27	6.3 × 11.5	1.1	2.8	160	ELXV630E□□270MFB5D	39	6.3 × 15	0.62	1.6	230	ELXV630E□□390MF15D	47	8 × 12	0.49	1.3	275	ELXV630E□□470MH12D	56	10 × 12.5	0.27	0.68	420	ELXV630E□□560MJC5S	68	8 × 15	0.34	0.85	360	ELXV630E□□680MH15D	68	10 × 16	0.21	0.53	523	ELXV630E□□680MJ16S	82	8 × 20	0.21	0.53	500	ELXV630E□□820MH20D	120	10 × 20	0.16	0.40	650	ELXV630E□□121MJ20S	150	10 × 25	0.13	0.33	780	ELXV630E□□151MJ25S	180	10 × 30	0.10	0.25	960	ELXV630E□□181MJ30S	220	12.5 × 20	0.11	0.28	870	ELXV630E□□221MK20S	270	12.5 × 25	0.074	0.19	1,150	ELXV630E□□271MK25S	390	12.5 × 30	0.068	0.17	1,280	ELXV630E□□391MK30S	390	16 × 20	0.085	0.22	1,100	ELXV630E□□391ML20S	470	12.5 × 35	0.063	0.16	1,390	ELXV630E□□471MK35S	470	16 × 25	0.055	0.14	1,480	ELXV630E□□471ML25S	560	12.5 × 40	0.051	0.13	1,530	ELXV630E□□561MK40S	560	18 × 20	0.085	0.22	1,170	ELXV630E□□561MM20S	680	16 × 30	0.046	0.12	1,720	ELXV630E□□681ML30S	680	18 × 25	0.055	0.14	1,520	ELXV630E□□681MM25S	820	16 × 35	0.040	0.10	1,910	ELXV630E□□821ML35S	820	18 × 30	0.046	0.12	1,770	ELXV630E□□821MM30S	1,000	16 × 40	0.036	0.09	2,070	ELXV630E□□102ML40S	1,000	18 × 35	0.040	0.10	1,970	ELXV630E□□102MM35S	1,200	18 × 40	0.036	0.09	2,130	ELXV630E□□122MM40S	8.2	5 × 11.5	1.9	5.1	100	ELXV800E□□8R2MEB5D	18	6.3 × 11.5	1.1	3.0	150	ELXV800E□□180MFB5D	27	6.3 × 15	0.62	1.7	220	ELXV800E□□270MF15D	33	8 × 12	0.53	1.5	275	ELXV800E□□330MH12D	39	10 × 12.5	0.47	1.3	380	ELXV800E□□390MJC5S	47	8 × 15	0.35	0.97	360	ELXV800E□□470MH15D	56	8 × 20	0.27	0.74	490	ELXV800E□□560MH20D	56	10 × 16	0.33	0.90	500	ELXV800E□□560MJ16S	82	10 × 20	0.26	0.70	620	ELXV800E□□820MJ20S	100	10 × 25	0.19	0.52	795	ELXV800E□□101MJ25S	150	10 × 30	0.15	0.41	955	ELXV800E□□151MJ30S	150	12.5 × 20	0.15	0.41	890	ELXV800E□□151MK20S	180	12.5 × 25	0.11	0.30	1,040	ELXV800E□□181MK25S	270	12.5 × 30	0.094	0.26	1,270	ELXV800E□□271MK30S	270	16 × 20	0.11	0.30	1,240	ELXV800E□□271ML20S	330	12.5 × 35	0.087	0.24	1,450	ELXV800E□□331MK35S	330	16 × 25	0.081	0.22	1,440	ELXV800E□□331ML25S	390	12.5 × 40	0.060	0.17	1,610	ELXV800E□□391MK40S	390	18 × 20	0.085	0.23	1,450	ELXV800E□□391MM20S	470	16 × 30	0.058	0.16	1,790	ELXV800E□□471ML30S	470	18 × 25	0.070	0.19	1,650	ELXV800E□□471MM25S	560	16 × 35	0.052	0.14	2,000	ELXV800E□□561ML35S	680	16 × 40	0.041	0.11	2,200	ELXV800E□□681ML40S	680	18 × 30	0.058	0.16	1,850	ELXV800E□□681MM30S	820	18 × 35	0.052	0.14	1,990	ELXV800E□□821MM35S	1,000	18 × 40	0.041	0.11	2,370	ELXV800E□□102MM40S	5.6	5 × 11.5	1.9	5.1	100	ELXV101E□□5R6MEB5D	12	6.3 × 11.5	1.1	3.0	150	ELXV101E□□120MFB5D	18	6.3 × 15	0.62	1.7	220	ELXV101E□□180MF15D	22	8 × 12	0.53	1.5	275	ELXV101E□□220MH12D	27	10 × 12.5	0.47	1.3	380	ELXV101E□□270MJC5S	33	8 × 15	0.35	0.97	360	ELXV101E□□330MH15D	33	10 × 16	0.33	0.90	500	ELXV101E□□330MJ16S	39	8 × 20	0.27	0.74	490	ELXV101E□□390MH20D	56	10 × 20	0.26	0.70	620	ELXV101E□□560MJ20S	68	10 × 25	0.19	0.52	795	ELXV101E□□680MJ25S	100	10 × 30	0.15	0.41	955	ELXV101E□□101MJ30S	100	12.5 × 20	0.15	0.41	890	ELXV101E□□101MK20S	120	12.5 × 25	0.11	0.30	1,040	ELXV101E□□121MK25S	180	12.5 × 30	0.094	0.26	1,270	ELXV101E□□181MK30S	180	16 × 20	0.11	0.30	1,240	ELXV101E□□181ML20S	220	12.5 × 35	0.087	0.24	1,450	ELXV101E□□221MK35S	220	16 × 25	0.081	0.22	1,440	ELXV101E□□221ML25S	270	12.5 × 40	0.060	0.17	1,610	ELXV101E□□271MK40S	270	18 × 20	0.085	0.23	1,450	ELXV101E□□271MM20S	330	16 × 30	0.058	0.16	1,790	ELXV101E□□331ML30S	330	18 × 25	0.070	0.19	1,650	ELXV101E□□331MM25S	390	16 × 35	0.052	0.14	2,000	ELXV101E□□391ML35S	390	18 × 30	0.058	0.16	1,850	ELXV101E□□391MM30S	470	16 × 40	0.041	0.11	2,200	ELXV101E□□471ML40S	560	18 × 35	0.052	0.14	1,990	ELXV101E□□561MM35S	680	18 × 40	0.041
82	8 × 15	0.24	0.72	505	ELXV500E□□820MH15D																																																																																																																																																																																																																																																																																																																																																																																																																																																																																																																																																																																																																															
82	10 × 12.5	0.16	0.40	530	ELXV500E□□820MJC5S																																																																																																																																																																																																																																																																																																																																																																																																																																																																																																																																																																																																																															
120	8 × 20	0.18	0.52	610	ELXV500E□□121MH20D																																																																																																																																																																																																																																																																																																																																																																																																																																																																																																																																																																																																																															
120	10 × 16	0.12	0.30	755	ELXV500E□□121MJ16S																																																																																																																																																																																																																																																																																																																																																																																																																																																																																																																																																																																																																															
180	10 × 20	0.088	0.22	945	ELXV500E□□181MJ20S																																																																																																																																																																																																																																																																																																																																																																																																																																																																																																																																																																																																																															
220	10 × 25	0.068	0.17	1,150	ELXV500E□□221MJ25S																																																																																																																																																																																																																																																																																																																																																																																																																																																																																																																																																																																																																															
330	10 × 30	0.059	0.15	1,260	ELXV500E□□331MJ30S																																																																																																																																																																																																																																																																																																																																																																																																																																																																																																																																																																																																																															
330	12.5 × 20	0.059	0.15	1,190	ELXV500E□□331MK20S																																																																																																																																																																																																																																																																																																																																																																																																																																																																																																																																																																																																																															
470	12.5 × 25	0.045	0.11	1,500	ELXV500E□□471MK25S																																																																																																																																																																																																																																																																																																																																																																																																																																																																																																																																																																																																																															
560	12.5 × 30	0.039	0.098	1,720	ELXV500E□□561MK30S																																																																																																																																																																																																																																																																																																																																																																																																																																																																																																																																																																																																																															
680	12.5 × 35	0.033	0.083	1,900	ELXV500E□□681MK35S																																																																																																																																																																																																																																																																																																																																																																																																																																																																																																																																																																																																																															
680	16 × 20	0.043	0.11	1,500	ELXV500E□□681ML20S																																																																																																																																																																																																																																																																																																																																																																																																																																																																																																																																																																																																																															
820	12.5 × 40	0.029	0.073	2,120	ELXV500E□□821MK40S																																																																																																																																																																																																																																																																																																																																																																																																																																																																																																																																																																																																																															
820	16 × 25	0.033	0.083	1,880	ELXV500E□□821ML25S																																																																																																																																																																																																																																																																																																																																																																																																																																																																																																																																																																																																																															
820	18 × 20	0.039	0.098	1,660	ELXV500E□□821MM20S																																																																																																																																																																																																																																																																																																																																																																																																																																																																																																																																																																																																																															
1,000	16 × 30	0.029	0.073	2,150	ELXV500E□□102ML30S																																																																																																																																																																																																																																																																																																																																																																																																																																																																																																																																																																																																																															
1,000	18 × 25	0.030	0.075	2,020	ELXV500E□□102MM25S																																																																																																																																																																																																																																																																																																																																																																																																																																																																																																																																																																																																																															
1,200	16 × 35	0.025	0.063	2,320	ELXV500E□□122ML35S																																																																																																																																																																																																																																																																																																																																																																																																																																																																																																																																																																																																																															
1,500	16 × 40	0.021	0.053	2,650	ELXV500E□□152ML40S																																																																																																																																																																																																																																																																																																																																																																																																																																																																																																																																																																																																																															
1,500	18 × 30	0.026	0.065	2,340	ELXV500E□□152MM30S																																																																																																																																																																																																																																																																																																																																																																																																																																																																																																																																																																																																																															
1,800	18 × 35	0.023	0.058	2,620	ELXV500E□□182MM35S																																																																																																																																																																																																																																																																																																																																																																																																																																																																																																																																																																																																																															
2,200	18 × 40	0.020	0.050	2,790	ELXV500E□□222MM40S																																																																																																																																																																																																																																																																																																																																																																																																																																																																																																																																																																																																																															
12	5 × 11.5	1.9	4.8	100	ELXV630E□□120MEB5D																																																																																																																																																																																																																																																																																																																																																																																																																																																																																																																																																																																																																															
27	6.3 × 11.5	1.1	2.8	160	ELXV630E□□270MFB5D																																																																																																																																																																																																																																																																																																																																																																																																																																																																																																																																																																																																																															
39	6.3 × 15	0.62	1.6	230	ELXV630E□□390MF15D																																																																																																																																																																																																																																																																																																																																																																																																																																																																																																																																																																																																																															
47	8 × 12	0.49	1.3	275	ELXV630E□□470MH12D																																																																																																																																																																																																																																																																																																																																																																																																																																																																																																																																																																																																																															
56	10 × 12.5	0.27	0.68	420	ELXV630E□□560MJC5S																																																																																																																																																																																																																																																																																																																																																																																																																																																																																																																																																																																																																															
68	8 × 15	0.34	0.85	360	ELXV630E□□680MH15D																																																																																																																																																																																																																																																																																																																																																																																																																																																																																																																																																																																																																															
68	10 × 16	0.21	0.53	523	ELXV630E□□680MJ16S																																																																																																																																																																																																																																																																																																																																																																																																																																																																																																																																																																																																																															
82	8 × 20	0.21	0.53	500	ELXV630E□□820MH20D																																																																																																																																																																																																																																																																																																																																																																																																																																																																																																																																																																																																																															
120	10 × 20	0.16	0.40	650	ELXV630E□□121MJ20S																																																																																																																																																																																																																																																																																																																																																																																																																																																																																																																																																																																																																															
150	10 × 25	0.13	0.33	780	ELXV630E□□151MJ25S																																																																																																																																																																																																																																																																																																																																																																																																																																																																																																																																																																																																																															
180	10 × 30	0.10	0.25	960	ELXV630E□□181MJ30S																																																																																																																																																																																																																																																																																																																																																																																																																																																																																																																																																																																																																															
220	12.5 × 20	0.11	0.28	870	ELXV630E□□221MK20S																																																																																																																																																																																																																																																																																																																																																																																																																																																																																																																																																																																																																															
270	12.5 × 25	0.074	0.19	1,150	ELXV630E□□271MK25S																																																																																																																																																																																																																																																																																																																																																																																																																																																																																																																																																																																																																															
390	12.5 × 30	0.068	0.17	1,280	ELXV630E□□391MK30S																																																																																																																																																																																																																																																																																																																																																																																																																																																																																																																																																																																																																															
390	16 × 20	0.085	0.22	1,100	ELXV630E□□391ML20S																																																																																																																																																																																																																																																																																																																																																																																																																																																																																																																																																																																																																															
470	12.5 × 35	0.063	0.16	1,390	ELXV630E□□471MK35S																																																																																																																																																																																																																																																																																																																																																																																																																																																																																																																																																																																																																															
470	16 × 25	0.055	0.14	1,480	ELXV630E□□471ML25S																																																																																																																																																																																																																																																																																																																																																																																																																																																																																																																																																																																																																															
560	12.5 × 40	0.051	0.13	1,530	ELXV630E□□561MK40S																																																																																																																																																																																																																																																																																																																																																																																																																																																																																																																																																																																																																															
560	18 × 20	0.085	0.22	1,170	ELXV630E□□561MM20S																																																																																																																																																																																																																																																																																																																																																																																																																																																																																																																																																																																																																															
680	16 × 30	0.046	0.12	1,720	ELXV630E□□681ML30S																																																																																																																																																																																																																																																																																																																																																																																																																																																																																																																																																																																																																															
680	18 × 25	0.055	0.14	1,520	ELXV630E□□681MM25S																																																																																																																																																																																																																																																																																																																																																																																																																																																																																																																																																																																																																															
820	16 × 35	0.040	0.10	1,910	ELXV630E□□821ML35S																																																																																																																																																																																																																																																																																																																																																																																																																																																																																																																																																																																																																															
820	18 × 30	0.046	0.12	1,770	ELXV630E□□821MM30S																																																																																																																																																																																																																																																																																																																																																																																																																																																																																																																																																																																																																															
1,000	16 × 40	0.036	0.09	2,070	ELXV630E□□102ML40S																																																																																																																																																																																																																																																																																																																																																																																																																																																																																																																																																																																																																															
1,000	18 × 35	0.040	0.10	1,970	ELXV630E□□102MM35S																																																																																																																																																																																																																																																																																																																																																																																																																																																																																																																																																																																																																															
1,200	18 × 40	0.036	0.09	2,130	ELXV630E□□122MM40S																																																																																																																																																																																																																																																																																																																																																																																																																																																																																																																																																																																																																															
8.2	5 × 11.5	1.9	5.1	100	ELXV800E□□8R2MEB5D																																																																																																																																																																																																																																																																																																																																																																																																																																																																																																																																																																																																																															
18	6.3 × 11.5	1.1	3.0	150	ELXV800E□□180MFB5D																																																																																																																																																																																																																																																																																																																																																																																																																																																																																																																																																																																																																															
27	6.3 × 15	0.62	1.7	220	ELXV800E□□270MF15D																																																																																																																																																																																																																																																																																																																																																																																																																																																																																																																																																																																																																															
33	8 × 12	0.53	1.5	275	ELXV800E□□330MH12D																																																																																																																																																																																																																																																																																																																																																																																																																																																																																																																																																																																																																															
39	10 × 12.5	0.47	1.3	380	ELXV800E□□390MJC5S																																																																																																																																																																																																																																																																																																																																																																																																																																																																																																																																																																																																																															
47	8 × 15	0.35	0.97	360	ELXV800E□□470MH15D																																																																																																																																																																																																																																																																																																																																																																																																																																																																																																																																																																																																																															
56	8 × 20	0.27	0.74	490	ELXV800E□□560MH20D																																																																																																																																																																																																																																																																																																																																																																																																																																																																																																																																																																																																																															
56	10 × 16	0.33	0.90	500	ELXV800E□□560MJ16S																																																																																																																																																																																																																																																																																																																																																																																																																																																																																																																																																																																																																															
82	10 × 20	0.26	0.70	620	ELXV800E□□820MJ20S																																																																																																																																																																																																																																																																																																																																																																																																																																																																																																																																																																																																																															
100	10 × 25	0.19	0.52	795	ELXV800E□□101MJ25S																																																																																																																																																																																																																																																																																																																																																																																																																																																																																																																																																																																																																															
150	10 × 30	0.15	0.41	955	ELXV800E□□151MJ30S																																																																																																																																																																																																																																																																																																																																																																																																																																																																																																																																																																																																																															
150	12.5 × 20	0.15	0.41	890	ELXV800E□□151MK20S																																																																																																																																																																																																																																																																																																																																																																																																																																																																																																																																																																																																																															
180	12.5 × 25	0.11	0.30	1,040	ELXV800E□□181MK25S																																																																																																																																																																																																																																																																																																																																																																																																																																																																																																																																																																																																																															
270	12.5 × 30	0.094	0.26	1,270	ELXV800E□□271MK30S																																																																																																																																																																																																																																																																																																																																																																																																																																																																																																																																																																																																																															
270	16 × 20	0.11	0.30	1,240	ELXV800E□□271ML20S																																																																																																																																																																																																																																																																																																																																																																																																																																																																																																																																																																																																																															
330	12.5 × 35	0.087	0.24	1,450	ELXV800E□□331MK35S																																																																																																																																																																																																																																																																																																																																																																																																																																																																																																																																																																																																																															
330	16 × 25	0.081	0.22	1,440	ELXV800E□□331ML25S																																																																																																																																																																																																																																																																																																																																																																																																																																																																																																																																																																																																																															
390	12.5 × 40	0.060	0.17	1,610	ELXV800E□□391MK40S																																																																																																																																																																																																																																																																																																																																																																																																																																																																																																																																																																																																																															
390	18 × 20	0.085	0.23	1,450	ELXV800E□□391MM20S																																																																																																																																																																																																																																																																																																																																																																																																																																																																																																																																																																																																																															
470	16 × 30	0.058	0.16	1,790	ELXV800E□□471ML30S																																																																																																																																																																																																																																																																																																																																																																																																																																																																																																																																																																																																																															
470	18 × 25	0.070	0.19	1,650	ELXV800E□□471MM25S																																																																																																																																																																																																																																																																																																																																																																																																																																																																																																																																																																																																																															
560	16 × 35	0.052	0.14	2,000	ELXV800E□□561ML35S																																																																																																																																																																																																																																																																																																																																																																																																																																																																																																																																																																																																																															
680	16 × 40	0.041	0.11	2,200	ELXV800E□□681ML40S																																																																																																																																																																																																																																																																																																																																																																																																																																																																																																																																																																																																																															
680	18 × 30	0.058	0.16	1,850	ELXV800E□□681MM30S																																																																																																																																																																																																																																																																																																																																																																																																																																																																																																																																																																																																																															
820	18 × 35	0.052	0.14	1,990	ELXV800E□□821MM35S																																																																																																																																																																																																																																																																																																																																																																																																																																																																																																																																																																																																																															
1,000	18 × 40	0.041	0.11	2,370	ELXV800E□□102MM40S																																																																																																																																																																																																																																																																																																																																																																																																																																																																																																																																																																																																																															
5.6	5 × 11.5	1.9	5.1	100	ELXV101E□□5R6MEB5D																																																																																																																																																																																																																																																																																																																																																																																																																																																																																																																																																																																																																															
12	6.3 × 11.5	1.1	3.0	150	ELXV101E□□120MFB5D																																																																																																																																																																																																																																																																																																																																																																																																																																																																																																																																																																																																																															
18	6.3 × 15	0.62	1.7	220	ELXV101E□□180MF15D																																																																																																																																																																																																																																																																																																																																																																																																																																																																																																																																																																																																																															
22	8 × 12	0.53	1.5	275	ELXV101E□□220MH12D																																																																																																																																																																																																																																																																																																																																																																																																																																																																																																																																																																																																																															
27	10 × 12.5	0.47	1.3	380	ELXV101E□□270MJC5S																																																																																																																																																																																																																																																																																																																																																																																																																																																																																																																																																																																																																															
33	8 × 15	0.35	0.97	360	ELXV101E□□330MH15D																																																																																																																																																																																																																																																																																																																																																																																																																																																																																																																																																																																																																															
33	10 × 16	0.33	0.90	500	ELXV101E□□330MJ16S																																																																																																																																																																																																																																																																																																																																																																																																																																																																																																																																																																																																																															
39	8 × 20	0.27	0.74	490	ELXV101E□□390MH20D																																																																																																																																																																																																																																																																																																																																																																																																																																																																																																																																																																																																																															
56	10 × 20	0.26	0.70	620	ELXV101E□□560MJ20S																																																																																																																																																																																																																																																																																																																																																																																																																																																																																																																																																																																																																															
68	10 × 25	0.19	0.52	795	ELXV101E□□680MJ25S																																																																																																																																																																																																																																																																																																																																																																																																																																																																																																																																																																																																																															
100	10 × 30	0.15	0.41	955	ELXV101E□□101MJ30S																																																																																																																																																																																																																																																																																																																																																																																																																																																																																																																																																																																																																															
100	12.5 × 20	0.15	0.41	890	ELXV101E□□101MK20S																																																																																																																																																																																																																																																																																																																																																																																																																																																																																																																																																																																																																															
120	12.5 × 25	0.11	0.30	1,040	ELXV101E□□121MK25S																																																																																																																																																																																																																																																																																																																																																																																																																																																																																																																																																																																																																															
180	12.5 × 30	0.094	0.26	1,270	ELXV101E□□181MK30S																																																																																																																																																																																																																																																																																																																																																																																																																																																																																																																																																																																																																															
180	16 × 20	0.11	0.30	1,240	ELXV101E□□181ML20S																																																																																																																																																																																																																																																																																																																																																																																																																																																																																																																																																																																																																															
220	12.5 × 35	0.087	0.24	1,450	ELXV101E□□221MK35S																																																																																																																																																																																																																																																																																																																																																																																																																																																																																																																																																																																																																															
220	16 × 25	0.081	0.22	1,440	ELXV101E□□221ML25S																																																																																																																																																																																																																																																																																																																																																																																																																																																																																																																																																																																																																															
270	12.5 × 40	0.060	0.17	1,610	ELXV101E□□271MK40S																																																																																																																																																																																																																																																																																																																																																																																																																																																																																																																																																																																																																															
270	18 × 20	0.085	0.23	1,450	ELXV101E□□271MM20S																																																																																																																																																																																																																																																																																																																																																																																																																																																																																																																																																																																																																															
330	16 × 30	0.058	0.16	1,790	ELXV101E□□331ML30S																																																																																																																																																																																																																																																																																																																																																																																																																																																																																																																																																																																																																															
330	18 × 25	0.070	0.19	1,650	ELXV101E□□331MM25S																																																																																																																																																																																																																																																																																																																																																																																																																																																																																																																																																																																																																															
390	16 × 35	0.052	0.14	2,000	ELXV101E□□391ML35S																																																																																																																																																																																																																																																																																																																																																																																																																																																																																																																																																																																																																															
390	18 × 30	0.058	0.16	1,850	ELXV101E□□391MM30S																																																																																																																																																																																																																																																																																																																																																																																																																																																																																																																																																																																																																															
470	16 × 40	0.041	0.11	2,200	ELXV101E□□471ML40S																																																																																																																																																																																																																																																																																																																																																																																																																																																																																																																																																																																																																															
560	18 × 35	0.052	0.14	1,990	ELXV101E□□561MM35S																																																																																																																																																																																																																																																																																																																																																																																																																																																																																																																																																																																																																															
680	18 × 40	0.041	0.11	2,370	ELXV101E□□681MM40S																																																																																																																																																																																																																																																																																																																																																																																																																																																																																																																																																																																																																															

□ □ : Enter the appropriate lead forming or taping code.

◆RATED RIPPLE CURRENT MULTIPLIERS

●Frequency Multipliers

Rated voltage (Vdc)	Case size φD (mm)	Frequency (Hz)				Rated voltage (Vdc)	Case size φD (mm)	Frequency (Hz)			
		120	1k	10k	100k			120	1k	10k	100k
6.3 & 10	5 to 8	0.65	0.83	0.95	1.00	35 & 50	5 to 8	0.40	0.66	0.85	1.00
	10 & 12.5	0.70	0.85	0.96	1.00		10 & 12.5	0.50	0.73	0.89	1.00
	16 & 18	0.85	0.92	0.97	1.00		16 & 18	0.60	0.81	0.94	1.00
16 & 25	5 to 8	0.55	0.76	0.91	1.00	63 to 100	5 to 8	0.20	0.55	0.80	1.00
	10 & 12.5	0.65	0.83	0.93	1.00		10 & 12.5	0.35	0.65	0.85	1.00
	16 & 18	0.70	0.87	0.96	1.00		16 & 18	0.50	0.75	0.90	1.00

The endurance of capacitors is reduced with internal heating produced by ripple current at the rate of halving the lifetime with every 5°C rise.

When long life performance is required in actual use, the rms ripple current has to be reduced.