



**THIS PRODUCT MANUFACTURED WITH LEAD-FREE PROCESSING**

**DESIGNED AND DIMENSIONED IN MILLIMETERS [INCHES]  
ALL DIMENSIONS REFERENCE EXCEPT AS SHOWN**

BCU-C-X-X.XX-XX-P

DO NOT SCALE FROM THIS PRINT

END 1  
-C: SEALED TYPE C PLUG

PLATING  
-S: CONTACT AREA 30µ" GOLD

STYLE  
-P: PLASTIC

END 2  
-UC: UNSEALED TYPE C PLUG  
-SC: SEALED TYPE C PLUG  
-BC: BLUNT CUT

ASSEMBLED LENGTH  
-0.50: (0.5 M) CABLE  
-1.00: (1 M) CABLE  
-2.00: (2 M) CABLE  
STANDARD LENGTH  
(SEE NOTE 2 & 3)

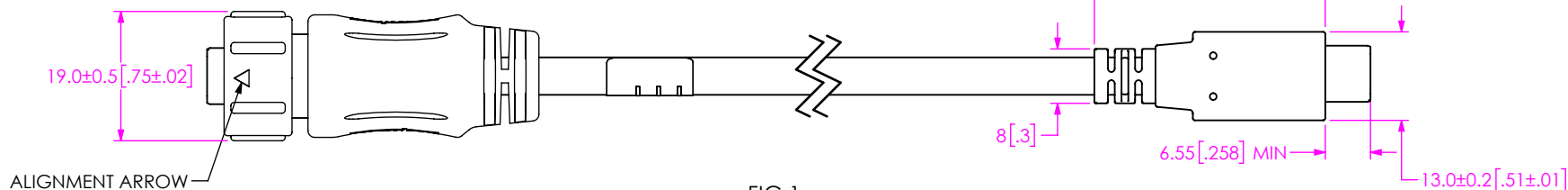
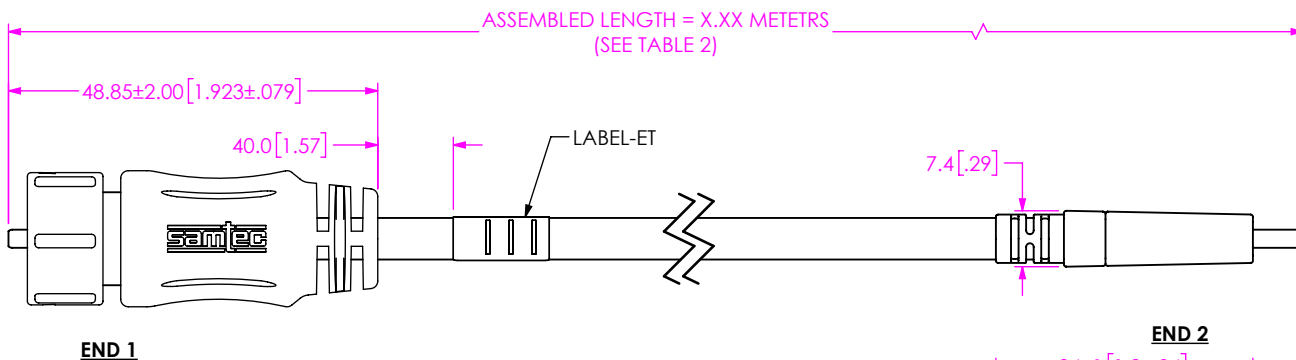
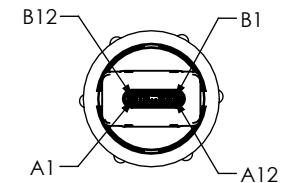
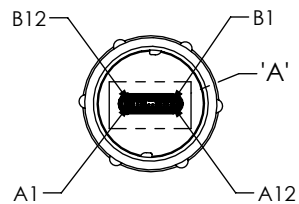
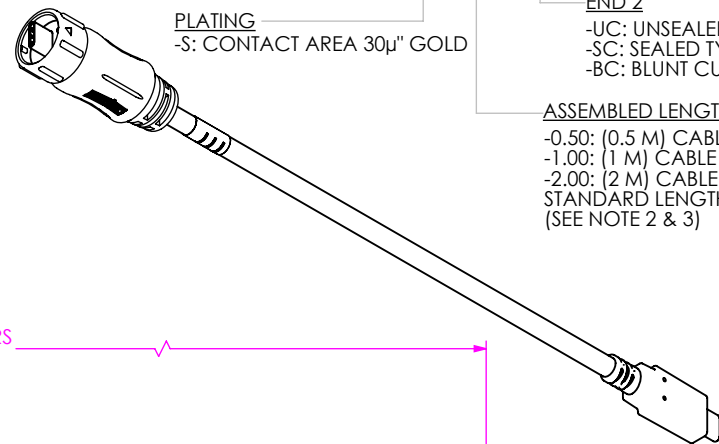

FIG 1  
BCU-C-X-X.XX-UC-P SHOWN

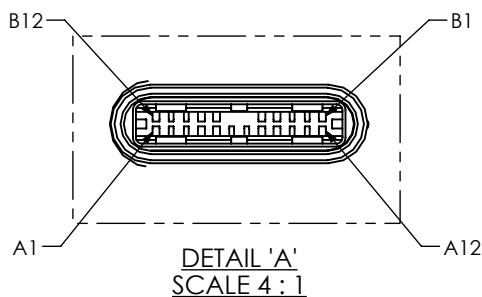

TABLE 2	
ASSEMBLED LENGTH	TOLERANCE
≤0.25M	+25 MM
0.5M-1.5M	+50 MM
2.0M	+100 MM

NOTES:

1. END 1 MATING WITH BRU-C-P OR BPCU-C-X-X.XX-XX-P.
2. CABLE LENGTH 2M MAX. OTHER LENGTH REQUIRE MOQ.
3. CABLE LENGTHS ABOVE 0.8M FOR GEN2 AND 1.5M FOR GEN1 ARE NOT SUPPORT WITH SI DATA.

**PROPRIETARY NOTE**  
THIS DOCUMENT CONTAINS CONFIDENTIAL AND PROPRIETARY INFORMATION AND ALL DESIGN, MANUFACTURING, REPRODUCTION, USE, PATENT RIGHTS AND SALES RIGHTS ARE EXPRESSLY RESERVED BY SAMTEC, INC. THIS DOCUMENT SHALL NOT BE DISCLOSED, IN WHOLE OR PART, TO ANY UNAUTHORIZED PERSON OR ENTITY NOR REPRODUCED, TRANSFERRED OR INCORPORATED IN ANY OTHER PROJECT IN ANY MANNER WITHOUT THE EXPRESS WRITTEN CONSENT OF SAMTEC, INC.

DO NOT SCALE DRAWING SHEET SCALE: 1:1  
MATERIAL: LOCK NUT: THERMOPLASTIC, COLOR: BLACK  
RUBBER PAD: SILICONE, COLOR: BLACK  
OVER MOLD & INNER MOLD: PVC, COLOR: BLACK



520 PARK EAST BLVD, NEW ALBANY, IN 47150  
PHONE: 812-944-6733 FAX: 812-948-5047  
e-Mail info@SAMTEC.com code 55322

DESCRIPTION: USB-C CABLE ASSEMBLY  
DWG. NO. BCU-C-X-X.XX-XX-P  
BY: JACK Z 2/21/2022 SHEET 1 OF 3

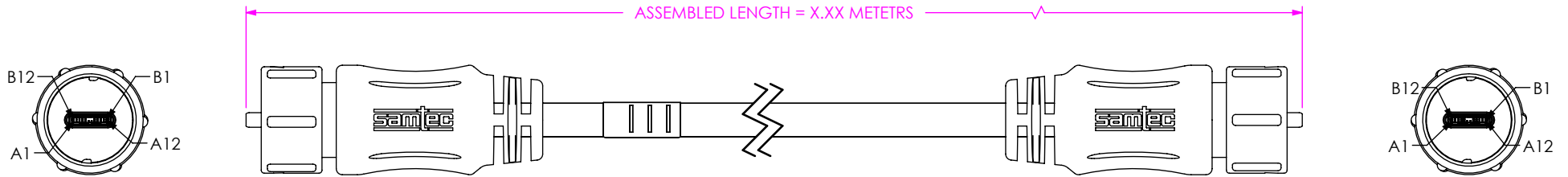

FIG 2  
BCU-C-X-X.XX-SC-P SHOWN  
(DIFFERENT AS SHOWN, OTHERWISE SAME AS FIG 1)

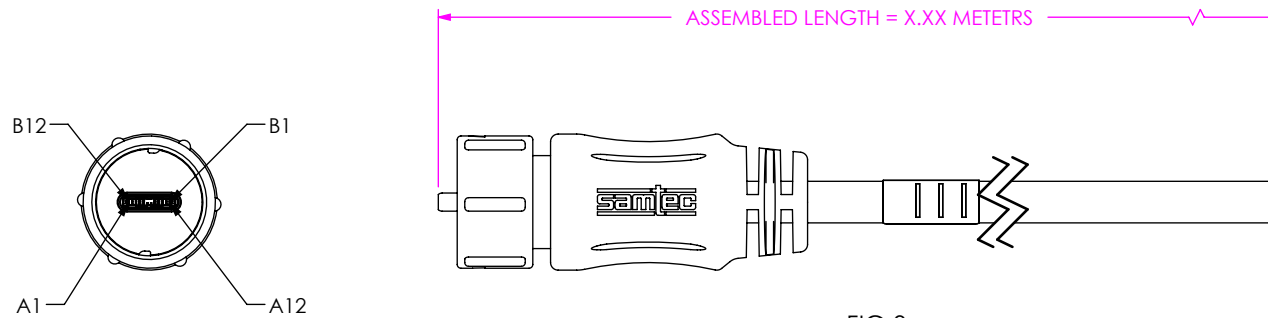

FIG 3  
BCU-C-X-X.XX-BC-P SHOWN  
(DIFFERENT AS SHOWN, OTHERWISE SAME AS FIG 1)

**PROPRIETARY NOTE**  
 \* THIS DOCUMENT CONTAINS CONFIDENTIAL AND PROPRIETARY INFORMATION AND ALL DESIGN, MANUFACTURING, REPRODUCTION, USE, PATENT RIGHTS AND SALES RIGHTS ARE EXPRESSLY RESERVED BY SAMTEC, INC. THIS DOCUMENT SHALL NOT BE DISCLOSED, IN WHOLE OR PART, TO ANY UNAUTHORIZED PERSON OR ENTITY NOR REPRODUCED, TRANSFERRED OR INCORPORATED IN ANY OTHER PROJECT IN ANY MANNER WITHOUT THE EXPRESS WRITTEN CONSENT OF SAMTEC, INC. \*

**samtec**

520 PARK EAST BLVD., NEW ALBANY, IN 47150  
 PHONE: 812-944-6733 FAX: 812-948-5047  
 e-Mail info@SAMTEC.com code 55322

SHEET SCALE: 1:1

DESCRIPTION: USB-C CABLE ASSEMBLY

DWG. NO. BCU-C-X-X.XX-XX-P

BY: JACK Z 2/21/2022 SHEET 2 OF 3

TABLE 1: PIN-OUT				
END 1	COLOR	END 2		
		-UC	-SC	-BC
A1	DRAIN	A1	A1	NC
A2	YELLOW (BLUE MYLAR)	B11	B11	
A3	BLUE (BLUE MYLAR)	B10	B10	
A4	RED (24 AWG)	A4	A4	
A5	BLUE (32 AWG)	A5	A5	
A6	GREEN	A6	A6	
A7	WHITE	A7	A7	
A8	RED (32 AWG)	B8	B8	
A9	RED (24 AWG)	A9	A9	
A10	VIOLET (SLIVER MYLAR)	B3	B3	
A11	ORANGE (SLIVER MYLAR)	B2	B2	
A12	DRAIN	A12	A12	
B1	DRAIN	B1	B1	
B2	YELLOW (SLIVER MYLAR)	A11	A11	
B3	BLUE (SLIVER MYLAR)	A10	A10	
B4	RED (24 AWG)	B4	B4	
B5	YELLOW (32 AWG)	B5	B5	
B6	NO CONNECTED	B6	B6	
B7	NO CONNECTED	B7	B7	
B8	BLACK (32 AWG)	A8	A8	
B9	RED (24 AWG)	B9	B9	
B10	VIOLET (BLUE MYLAR)	A3	A3	
B11	ORANGE (BLUE MYLAR)	A2	A2	
B12	DRAIN	B12	B12	

**PROPRIETARY NOTE**  
 \* THIS DOCUMENT CONTAINS CONFIDENTIAL AND PROPRIETARY INFORMATION AND ALL DESIGN, MANUFACTURING, REPRODUCTION, USE, PATENT RIGHTS AND SALES RIGHTS ARE EXPRESSLY RESERVED BY SAMTEC, INC. THIS DOCUMENT SHALL NOT BE DISCLOSED, IN WHOLE OR PART, TO ANY UNAUTHORIZED PERSON OR ENTITY NOR REPRODUCED, TRANSFERRED OR INCORPORATED IN ANY OTHER PROJECT IN ANY MANNER WITHOUT THE EXPRESS WRITTEN CONSENT OF SAMTEC, INC. \*



520 PARK EAST BLVD, NEW ALBANY, IN 47150  
 PHONE: 812-944-6733 FAX: 812-948-5047  
 e-Mail info@SAMTEC.com code 55322

SHEET SCALE: 1:1

DESCRIPTION: USB-C CABLE ASSEMBLY

DWG. NO. BCU-C-X-X.XX-XX-P

BY: JACK Z 2/21/2022 SHEET 3 OF 3