

DO NOT SCALE FROM THIS PRINT

EDGE MOUNT THICKNESS	"A"	"B"	"C"	BODY	CONTACT
-EM2	.130[3.30]	.0670[1.702]	.058[1.47]	QTS-25-01-D-EM2-XX	T-1S42-01-XXX
*-EM3	.160[4.06]	.0980[2.489]	.088[2.24]	QTS-25-01-D-EM3-XX	T-1S42-02-XXX

* = SEE NOTE 12

ASO ONLY (APPLICATION SPECIFIC ORDER)

QTS-XXX-01-XXX-D-DP-EMX-XX

No OF PAIRS
-016, -032, -048,
**-064, **-080
(PER ROW)

** = SEE NOTE 15

LEAD STYLE
-01: .1680[4.267]

OPTION
-TY: TRAY PACKAGING

EDGE MOUNT THICKNESS
-EM2: .064[1.63] ±.004 PCB
(USE QTS-25-01-D-EM2-XX
& T-1S42-01-XXX)
-EM3: (USE QTS-25-01-D-EM3-XX
& T-1S42-02-XXX)

SEE NOTE 12

DIFFERENTIAL PAIRS

ROW SPECIFICATION
-D: DOUBLE
(USE QTS-25-XX-D-EMX-XX)

No OF BANKS

PLATING SPECIFICATION

- F: FLASH SELECTIVE GOLD WITH MATTE TIN TAILS (USE T-1S42-XX-F & T-1G1-01-F) (SEE NOTE 7)
- L: LIGHT SELECTIVE GOLD WITH MATTE TIN TAILS (USE T-1S42-XX-L & T-1G1-01-L)
- H: HEAVY GOLD (USE T-1S42-XX-H & T-1G1-01-G)
- FTL: FLASH SELECTIVE GOLD, TIN/LEAD TAIL (USE T-1S42-XX-FTL & T-1G1-01-FTL)
- STL: SELECTIVE GOLD, TIN/LEAD TAIL (USE T-1S42-XX-STL & T-1G1-01-STL)

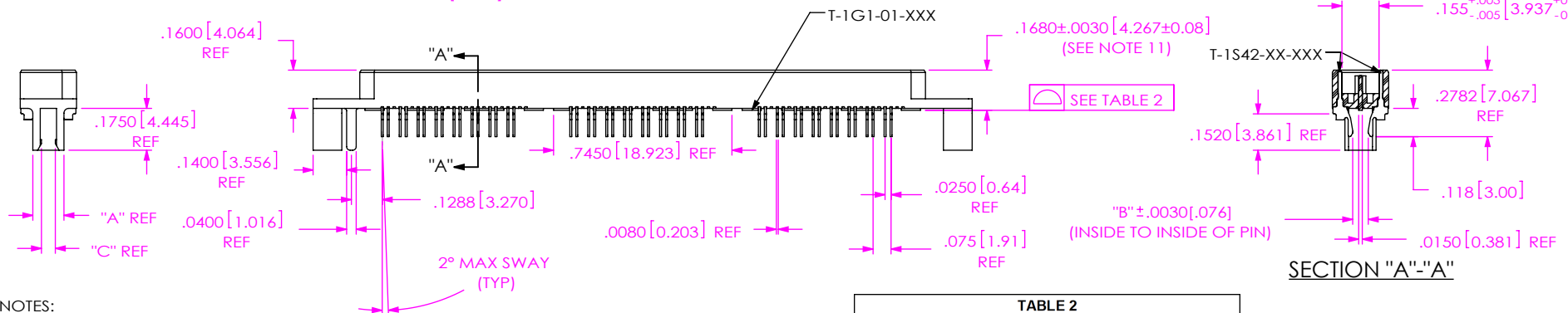
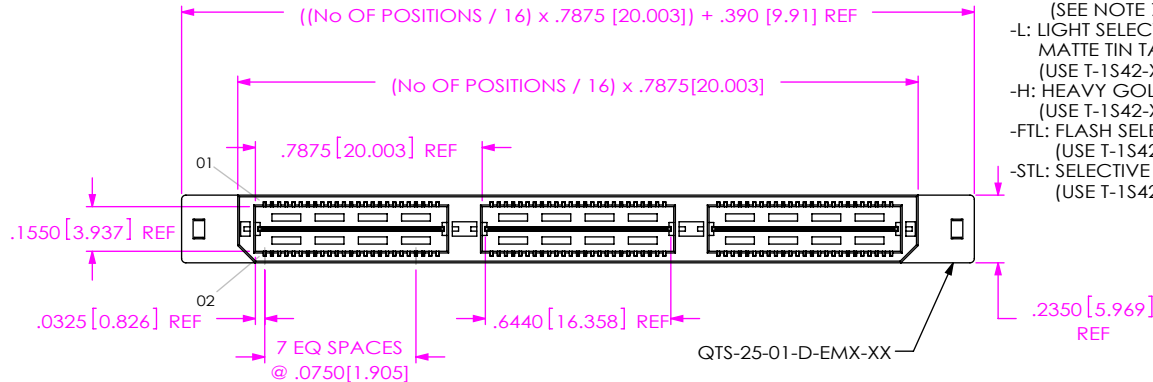
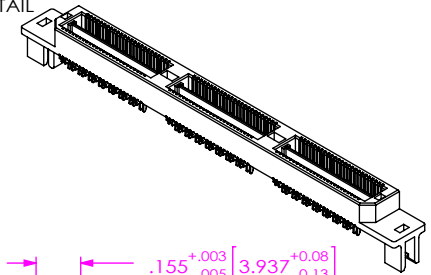

NOTES:

1. REPRESENTS A CRITICAL DIMENSION.
2. BURR ALLOWANCE: .0015[.038] MAX.
3. MINIMUM PUSHOUT FORCE: 6 OZ.
4. MINIMUM GROUND PLANE RETENTION: 1 LB.
5. NOTE DELETED.
6. PARTS TO BE MOLDED TO POSITION.
7. -L PLATING CAN BE SUBSTITUTED FOR -F PLATING (CONTACT).
8. NOTE DELETED.
9. NOTE DELETED.
10. SEE www.samtec.com/processing/edgemt_tectalk/index.htm FOR INFORMATION ON PROCESSING EDGE MOUNT PARTS TO BOARDS.
11. MAX VARIANCE OF .002[.05].
12. -EM3 IS NOT A STANDARD OFFERING; AVAILABLE AS AN ASP ONLY.
13. NOTE DELETED.
14. PARTS WITHOUT -TY OPTION SHALL BE PACKAGED IN TRAYS.
15. AVAILABLE FOR EXISTING CUSTOMERS ONLY.
16. ORDERS WILL BE PACKAGED ACCORDING TO THE SAMTEC PACKAGING EFFICIENCY STANDARDS (SPES) FOUND ON WWW.SAMTEC.COM.

PACKAGING VIEW

[PARTS TO HAVE POSITION #1 LOADED IN SAME DIRECTION AS ARROW]

EDGE MOUNT -EM2 & -EM3

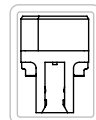

TUBE: PT-1-24-01-95
PLUG: TP-03

No OF PAIRS	MAX BOW	GND PLANE COPLANARITY
-016, -032, -048	.004 [.10]	.004 [.10]
**064, **080	.006 [.15]	.005 [1.27]

** = SEE NOTE 15

UNLESS OTHERWISE SPECIFIED, DIMENSIONS ARE IN INCHES. TOLERANCES ARE:
 DECIMALS: .XX: ±.01[.3]
 .XXX: ±.005[.13]
 .XXXX: ±.0020[.051]

PROPRIETARY NOTE

THIS DOCUMENT CONTAINS CONFIDENTIAL AND PROPRIETARY INFORMATION AND ALL DESIGN, MANUFACTURING, REPRODUCTION, USE, PATENT RIGHTS AND SALES RIGHTS ARE EXPRESSLY RESERVED BY SAMTEC, INC. THIS DOCUMENT SHALL NOT BE DISCLOSED, IN WHOLE OR PART, TO ANY UNAUTHORIZED PERSON OR ENTITY NOR REPRODUCED, TRANSMITTED OR INCORPORATED IN ANY OTHER PROJECT IN ANY MANNER WITHOUT THE EXPRESS WRITTEN CONSENT OF SAMTEC, INC.

MATERIAL: DO NOT SCALE DRAWING SHEET SCALE: 1.5:1
 INSULATOR: LCP, COLOR: BLACK
 TERMINAL: PHOS BRONZE
 GROUND PLANE: PHOS BRONZE



520 PARK EAST BLVD, NEW ALBANY, IN 47150
 PHONE: 812-944-6733 FAX: 812-948-5047
 e-Mail: info@SAMTEC.com code: 55322

DESCRIPTION:
.635mm HS DIFF PAIR EDGE MOUNT TERMINAL ASSEMBLY

DWG. NO.
QTS-XXX-01-XXX-D-DP-EMX-XX

BY: KEVIN B 05/28/01 SHEET 1 OF 1