

**DESIGNED AND DIMENSIONED IN INCHES[MILLIMETERS]  
ALL DIMENSIONS REFERENCE EXCEPT AS SHOWN**

DO NOT  
SCALE FROM  
THIS PRINT

**SEAFc-XX-X.X-X-XX-X-X-K-XR**

**No OF POSITIONS**  
-20, -30, -40, -50  
(PER ROW)

**PACKAGING** (SEE NOTES 3, 4 & 7)  
-TR: TAPE & REEL  
-FR: FULL REEL QTY. TAPE & REEL

**LEAD STYLE**  
-5.0: .199[5.05] HEIGHT  
\* -6.0: .238[6.05] HEIGHT  
-6.5: .258[6.55] HEIGHT  
\* -7.5: .297[7.54] HEIGHT  
(SEE TABLE 1)

**K-DOT**  
(SEE FIG 3, SHT 2)

**OPTION**  
-N: NO LATCH  
\*\* (LEAVE BLANK FOR LATCH POST)  
(SEE SHT 3, FIG 4)  
(ONLY AVAILABLE WITH -5.0  
LEAD STYLE, -04, -06, -08 & -10 ROW)  
-PP: POLARIZATION PIN  
(SEE SHT 3, FIG 5)  
(ONLY AVAILABLE WITH -05.0  
LEAD STYLE, 6, 8 & 10 ROWS)

**PLATING SPECIFICATION**  
-S: SELECTIVE GOLD (30µ") IN CONTACT AREA,  
MATTE TIN ON TAIL  
-L: LIGHT GOLD (10µ") IN CONTACT AREA,  
MATTE TIN ON TAIL

**ROWS**  
-04: 4 ROWS (SEE SHT 2, FIG 2)  
-06: 6 ROWS  
-08: 8 ROWS (SEE FIG 1)  
-10: 10 ROWS

**SOLDER COMPOSITION & STYLE**  
-1: 63% TIN / 37% LEAD  
**CHARGE TAIL**  
-2: 95.5% TIN/3.8% SILVER/.7%  
COPPER **CHARGE TAIL**

\* = NOT TOOLED  
\*\* = ONLY AVAILABLE WITH -5.0 LEAD STYLE,  
-04, -06, -08 & -10 ROW.

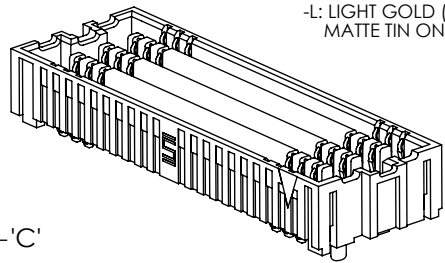
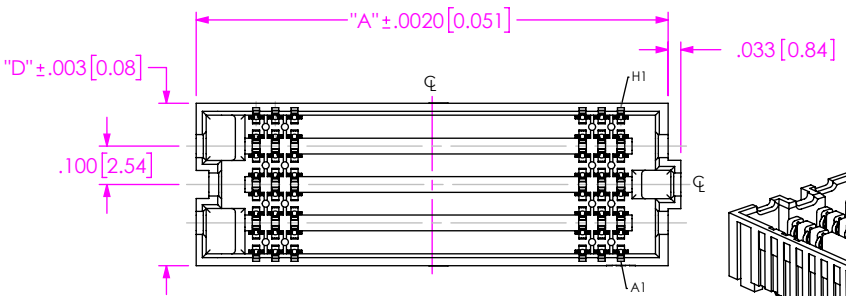

**TABLE 2**

No OF ROWS	"B"	"D"
-04	.079 [2.01]	.223 [5.66]
-06	.120 [3.05]	.323 [8.20]
-08	.120 [3.05]	.423 [10.74]
-10	.120 [3.05]	.523 [13.28]

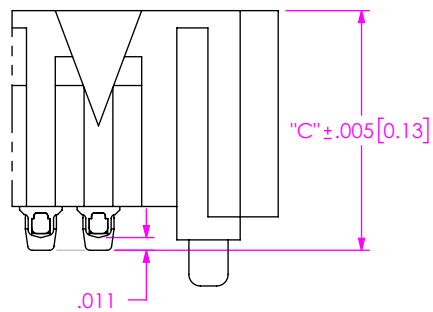
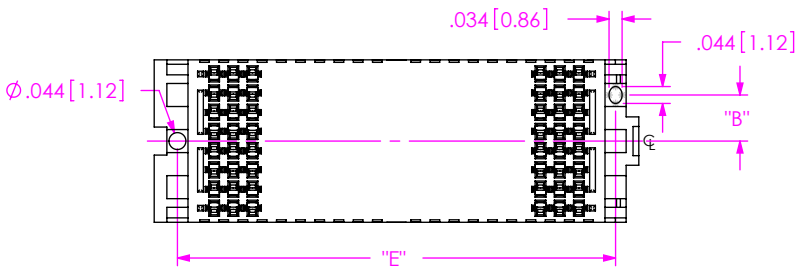
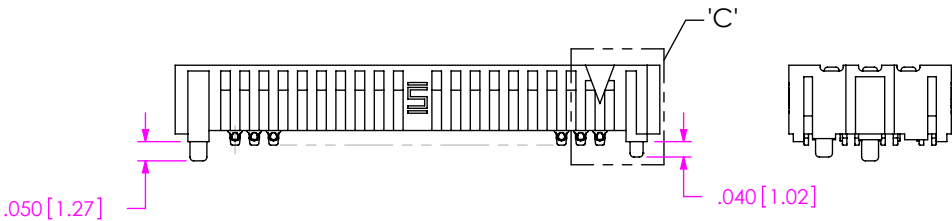

**DETAIL 'C'**  
SCALE 6 : 1

**TABLE 1**

No. OF ROWS	LEAD STYLE	"C"
-04	-5.0	.213 [5.41]
	-6.0	.252 [6.40]
	-6.5	.272 [6.91]
	-7.5	.311 [7.90]
-06, -08, -10	-5.0	.208 [5.28]
	-6.0	.247 [6.27]
	-6.5	.267 [6.78]
	-7.5	.306 [7.77]

**TABLE 3**

No OF POS.	"A"	"E"
-20	1.229 [31.22]	1.1410 [28.981]
-30	1.729 [43.92]	1.6410 [41.681]
-40	2.229 [56.62]	2.1410 [54.381]
-50	2.729 [69.32]	2.6410 [67.081]

**FIG 1**  
-08: 8 ROW  
(SEAFc-20-5.0-X-08-1-N-K-XR SHOWN)  
(SOME CENTER FEATURES REMOVED FOR CLARITY)

**NOTES:**

- NOTE DELETED.
- A-PINS PROVIDED AS STANDARD.
- TAPE & REEL IS STANDARD PACKAGING.
- ATTACH LABEL -4x2 TO EACH REEL.
- SOLDER CHARGE VOLUME .00000891 CUBIC INCHES (REF).
- NON-FUNCTIONAL VOIDING IN PLASTIC BODY TO BE AT SAMTEC'S DISCRETION.
- ORDERS WILL BE PACKAGED ACCORDING TO THE SAMTEC PACKAGING EFFICIENCY STANDARDS (SPES) FOUND ON WWW.SAMTEC.COM

**PROPRIETARY NOTE**  
THIS DOCUMENT CONTAINS CONFIDENTIAL AND PROPRIETARY INFORMATION AND ALL DESIGN, MANUFACTURING, REPRODUCTION, USE, PATENT RIGHTS AND SALES RIGHTS ARE EXPRESSLY RESERVED BY SAMTEC, INC. THIS DOCUMENT SHALL NOT BE DISCLOSED, IN WHOLE OR PART, TO ANY UNAUTHORIZED PERSON OR ENTITY NOR REPRODUCED, TRANSFERRED OR INCORPORATED IN ANY OTHER PROJECT IN ANY MANNER WITHOUT THE EXPRESS WRITTEN CONSENT OF SAMTEC, INC.



520 PARK EAST BLVD, NEW ALBANY, IN 47150  
PHONE: 812-944-6733 FAX: 812-948-5047  
e-Mail info@SAMTEC.com code 55322

DO NOT SCALE DRAWING  
SHEET SCALE: 2:1  
MATERIAL:  
INSULATOR: LCP, COLOR: BLACK  
CONTACT OR TERMINAL:  
SHIELD: PHOS BRONZE

**DESCRIPTION:**  
.050 PITCH SOCKET ARRAY ASSEMBLY  
**DWG. NO.**  
SEAFc-XX-X.X-X-XX-X-X-K-XR  
**BY:** JERRY SU 04/12/2019 **SHEET 1 OF 3**

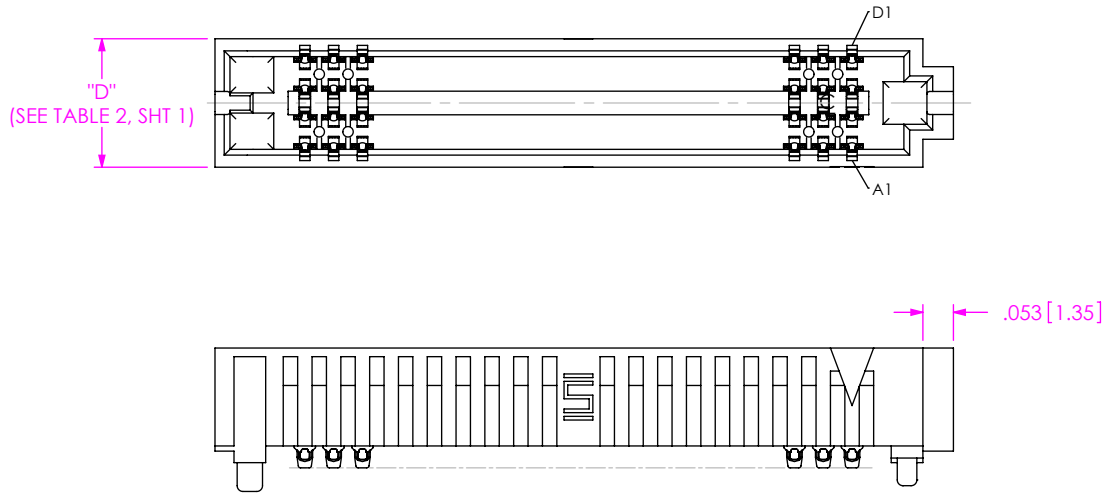

**FIG 2**  
-04: 4 ROW  
(SEAFc-20-5.0-X-04-1-N-K-XR SHOWN)  
(DIFFERENT AS SHOWN, OTHERWISE SAME AS FIG 1)  
(SOME CENTER FEATURES REMOVED FOR CLARITY)

**TABLE 4**

ROWS	"G"	"H"				"J"
		20 POS	30 POS	40 POS	50 POS	
-04	.256 [6.50]	.504 [12.79]	.754 [19.14]	1.004 [25.49]	1.254 [31.84]	.017 [.43]
-06	.256 [6.50]	.504 [12.79]	.754 [19.14]	1.004 [25.49]	1.254 [31.84]	.034 [.86]
-08	.325 [8.25]	.469 [11.92]	.719 [18.27]	.969 [24.62]	1.219 [30.97]	.049 [1.24]
-10	.404 [10.25]	.430 [10.92]	.680 [17.27]	.930 [23.62]	1.180 [29.97]	.060 [1.52]

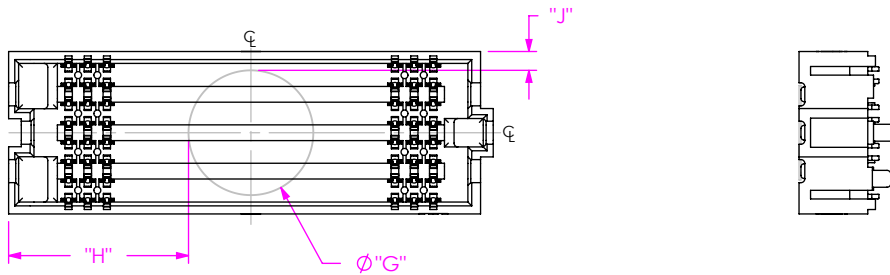

**FIG 3**  
K-DOT  
(SEAFc-20-5.0-X-08-1-N-K-XR SHOWN)  
(DIFFERENT AS SHOWN, OTHERWISE SAME AS FIG 1)  
(SOME CENTER FEATURES REMOVED FOR CLARITY)

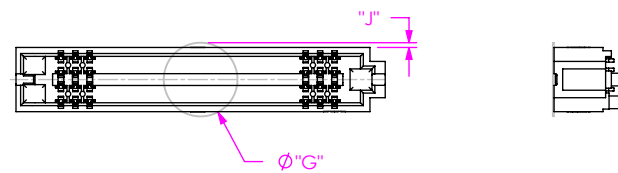

**-04 ROW ONLY**  
(DIFFERENT AS SHOWN, OTHERWISE SAME AS FIG 3)

**PROPRIETARY NOTE**  
THIS DOCUMENT CONTAINS CONFIDENTIAL AND PROPRIETARY INFORMATION AND ALL DESIGN, MANUFACTURING, REPRODUCTION, USE, PATENT RIGHTS AND SALES RIGHTS ARE EXPRESSLY RESERVED BY SAMTEC, INC. THIS DOCUMENT SHALL NOT BE DISCLOSED, IN WHOLE OR PART, TO ANY UNAUTHORIZED PERSON OR ENTITY NOR REPRODUCED, TRANSFERRED OR INCORPORATED IN ANY OTHER PROJECT IN ANY MANNER WITHOUT THE EXPRESS WRITTEN CONSENT OF SAMTEC, INC.

**samtec**  
520 PARK EAST BLVD, NEW ALBANY, IN 47150  
PHONE: 812-944-6733 FAX: 812-948-5047  
e-Mail: info@SAMTEC.com code 55322

DO NOT SCALE DRAWING  
SHEET SCALE: 2:1

DESCRIPTION:  
.050 PITCH SOCKET ARRAY ASSEMBLY  
DWG. NO.  
**SEAFc-XX-X.X-X-XX-X-X-K-XR**  
BY: JERRY SU 04/12/2019 SHEET 2 OF 3

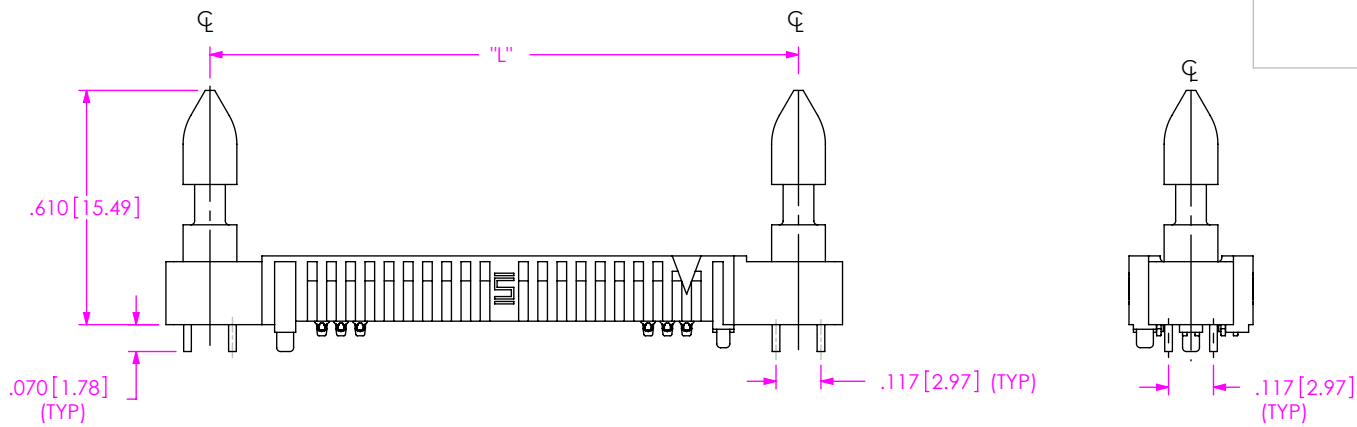
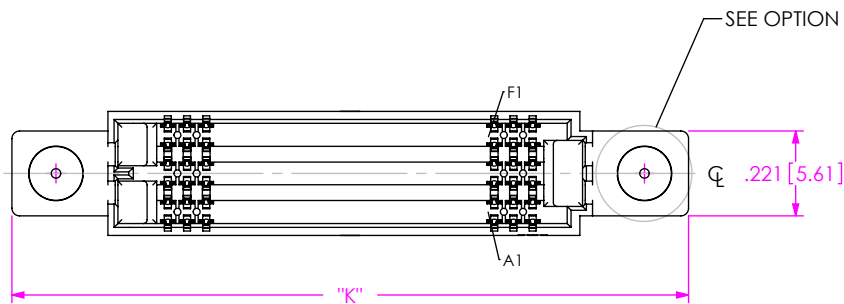

**FIG 4**  
 LATCH POST OPTION  
 (SE AFC-20-5.0-X-06-1-K-XR SHOWN)  
 (SOME CENTER FEATURES REMOVED FOR CLARITY)  
 (DIFFERENT AS SHOWN, OTHERWISE SAME AS FIG 1)  
 (LATCH POST OPTION REQUIRED FOR SEAC MATE ONLY)  
 (ONLY AVAILABLE WITH -.5.0 LEAD STYLE -04, -06, -08 & -10 ROW)

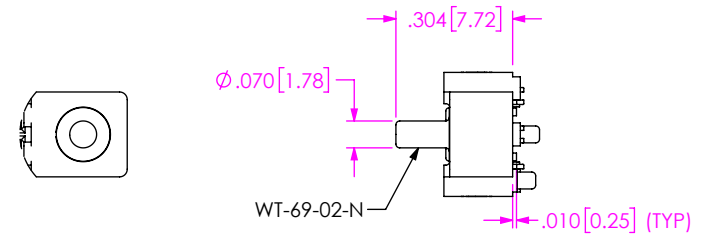

**FIG 5**  
 -PP OPTION  
 (SE AFC-20-05.0-XX-06-1-A-PP-K-TR SHOWN)  
 (SOME CENTER FEATURES REMOVED FOR CLARITY)  
 (SAME AS FIG 5 EXCEPT AS SHOWN)  
 (-PP OPTION VALID FOR SEAR MATE ONLY)  
 (ONLY AVAILABLE WITH -.05.0 LEAD STYLE 6, 8 & 10 ROW)

TABLE 5		
No OF POS.	"K"	"L"
-20	1.762 [44.75]	1.533 [38.94]
-30	2.262 [57.45]	2.033 [51.64]
-40	2.762 [70.15]	2.533 [64.34]
-50	3.262 [82.85]	3.033 [77.04]

**PROPRIETARY NOTE**  
 THIS DOCUMENT CONTAINS CONFIDENTIAL AND PROPRIETARY INFORMATION AND ALL DESIGN, MANUFACTURING, REPRODUCTION, USE, PATENT RIGHTS AND SALES RIGHTS ARE EXPRESSLY RESERVED BY SAMTEC, INC. THIS DOCUMENT SHALL NOT BE DISCLOSED, IN WHOLE OR PART, TO ANY UNAUTHORIZED PERSON OR ENTITY NOR REPRODUCED, TRANSFERRED OR INCORPORATED IN ANY OTHER PROJECT IN ANY MANNER WITHOUT THE EXPRESS WRITTEN CONSENT OF SAMTEC, INC.



520 PARK EAST BLVD, NEW ALBANY, IN 47150  
 PHONE: 812-944-6733 FAX: 812-948-5047  
 e-Mail info@SAMTEC.com code 55322

DO NOT SCALE DRAWING

SHEET SCALE: 3:1

DESCRIPTION:  
 .050 PITCH SOCKET ARRAY ASSEMBLY

DWG. NO.  
**SE AFC-XX-X.X-X-XX-X-X-K-XR**

BY: JERRY SU 04/12/2019 SHEET 3 OF 3